

Elizabeth Crowe Engineering Associates, PLLC

Post Office Box 1776, Athens, Texas 75751 | 214-683-6252 | elizabeth@eccengineers.com



January 12, 2026

David Nevarez, P.E., PTOE, CFM

City of Dallas – Transportation, Planning and Development
1500 Marilla Street, 5BN
Dallas, Texas, TX 75201

Via e-mail: david.nevarez@dallas.gov

RE: Revised Traffic Management Plan Review for Uplift White Rock Hills – Fall 2025

Dear Mr. Nevarez:

White Rock Hills Preparatory located at 7379 Valley Glen Drive in Dallas, Texas operates under Specific Use Permit No. 2180. The school established in 2017 is part of the Uplift Education public charter school network. This revision to the originally submitted TMP (October 2025) is being provided to include **responses to staff comments** from December 19, 2025.

General School Information

School Name: Uplift White Rock Hills Preparatory

Principal/Head of School: Academic Director – Marius Martin mamartin@uplifteducation.org

Primary School Dean – La Shannon Maiden-Coleman

LmaidenColeman@uplifteducation.org

Operations Director – Patty Gutierrez – PGutierrez@uplifteducation.org

Regional Director of Operations – Uplift – Roz McGinty RMcGinty@uplifteducation.org

Location: 7370 Valley Glen Drive, Dallas, Texas 75228

Type: Public Charter School

Existing Zoning: SUP No. 2180

Prior TMP Date: July 2025

TMP Update Information requested from City of Dallas staff:

- What is the purpose of the report? **Required TMP review per SUP No. 2180**
- Is it part of a proposed zoning amendment or forthcoming zoning application? **Yes, Uplift White Rock Hills applied for SUP renewal.**
- Is the school following the same operations as the approved TMP or proposing changes to improve operations? **The school is using the same internal plan. Currently, two lines of vehicles queue along Valley Glen so that no vehicles queue onto Samuel Boulevard.**
- Did you observe any vehicles parking, standing, queuing, or blocking public roadways? **Yes. Vehicles queued on Valley Glen in two lines. During one afternoon observation, for a very brief period (approximately one minute) up to five vehicles were queued on Samuel. The traffic officer at Samuel was not properly directing the vehicles to move forward onto Valley Glen. There was ample room for these vehicles on Valley Glen.**
- Did you contact district engineer to discuss any current issues documented at this school? **No.**

Staff Comments and Responses:

1. One lane or 2 lane queues from school driveway to Samuel Blvd: implication for remainder of roadway width. (Show on TMP graphic)

Response: The motorists currently form two lines along northbound Valley Glen: the curb side lane initially forms about 20 vehicle lengths back from the entry. These motorists are for the later pickup time. The recommendation to post “No Parking, Standing, etc.” signs along Valley Glen is targeted to provide enforcement opportunity to prevent these motorists from arriving and queueing for such a lengthy time prior to dismissal.

The queue for the pre-school scholars forms at the gate entry and leaves the curb side lane free of vehicles; no observations recorded this queue reaching Samuel.

2. Show Off duty Police officers (trained/deputized) in TMP graphic and define duties.
 - a) Samuel Blvd – Traffic control direction

Response: TMP Exhibit updated including officer locations: Samuel and Valley Glen

- Prevent carline vehicles from queuing early. The officer has at times held up a sign instructing motorists of the older scholars to return at a later time.
- Ensure cars do not queue on Samuel.
- Keep traffic flowing safely and smoothly on Samuel.

- b) School driveway – ensure continuous traffic flow

Response: Officer at Campus Entrance at Valley Glen

- Direct vehicles to proceed only when the campus is ready to receive them.
- Control traffic entering and exiting the campus.
- Stop-control traffic on Valley Glen as needed to allow cars to safely exit the campus.
- Maintain a continuous, safe flow of vehicles into and out of the campus.

Response: Officer at Pedestrian Gate near Ferguson

- Verify that all parents picking up walkers have an approved walker tag.
- Prevent vehicles from entering the carline from the back gate (Ferguson).
- Monitor pedestrian safety and maintain order during arrival and dismissal.

3. Define Drop off/Pick up area against school building; opportunity to extend the length of the pickup area.

Response: The actual operations have the pickup area extended much further than the exhibit had previously illustrated. The TMP Exhibit has been revised.

4. Is there an opportunity for additional drop off/pick up areas?

Response: The current operations allow for as many as twelve vehicles to be actively in the area to pickup scholars. This one lengthy area monitored by staff concentrated at the front of the school is the only feasible area available.

5. Show closed gate at east end of property

Response: All gates are now identified on the TMP Exhibit.

6. Show pedestrian accessibility to school property, if any.

7. **Response:** Identified on TMP Exhibit near Ferguson Road and a Traffic Officer is posted at this location.

8. Show No Parking signs along Valley Glen Drive as recommended by EOR.

Response: The TMP Exhibit has been updated to show recommended No Parking, Standing, Queuing signs on both sides of Valley Glen.

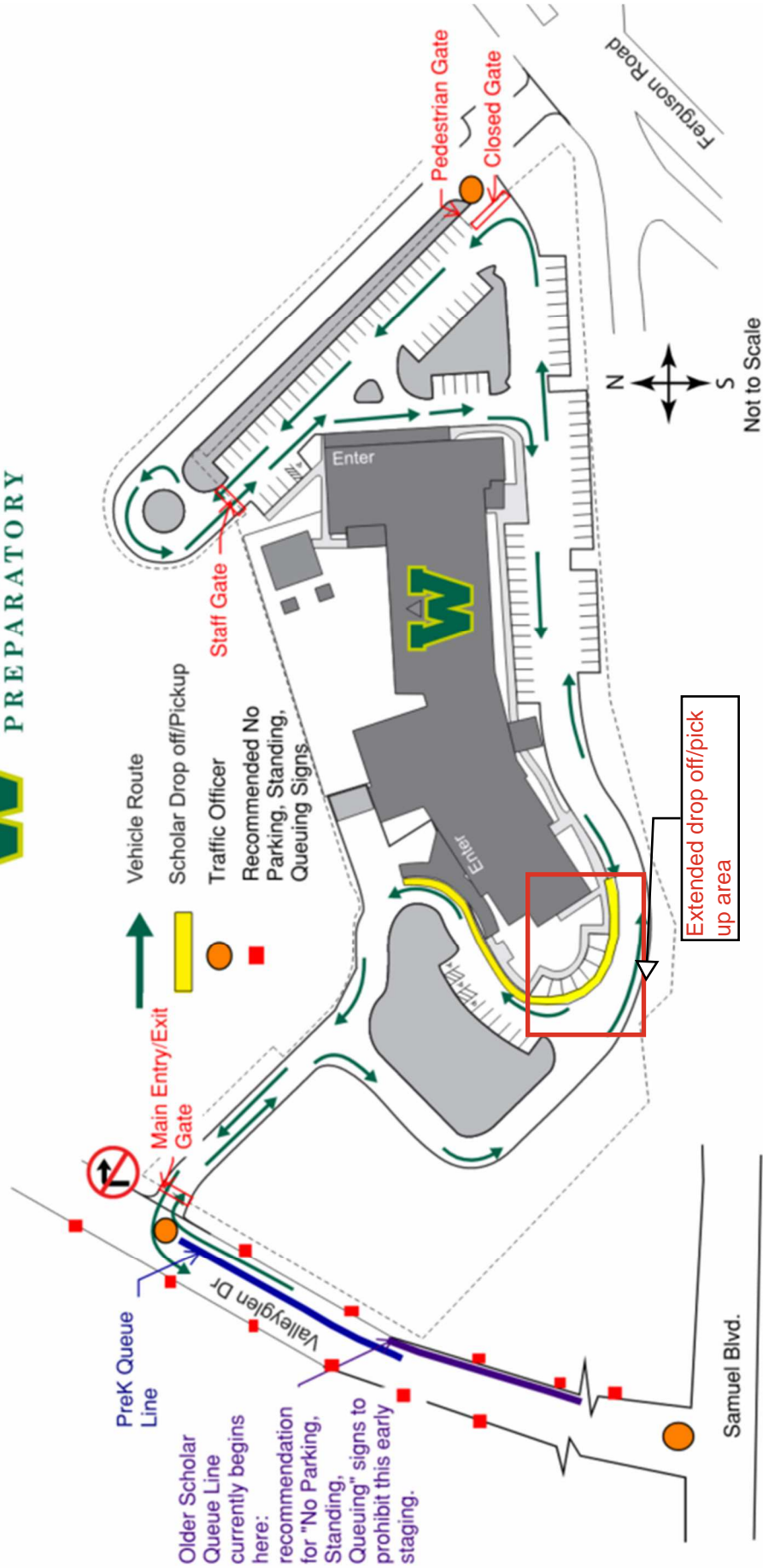

White Rock Hills TMP Exhibit with Recommendations

White Rock Hills Preparatory operates from 8:00 AM to 3:30 PM on Monday, Tuesday, Thursday and Friday. Dismissal is at 2:15 PM on Wednesdays. The PreKindergarten scholars are released 30 minutes prior to the older scholars as shown in the following table. The number of scholars in each grade level are also provided in the following table.

White Rock Hills Preparatory Campus 2025 - 2026 Operations

Grade Level	Number of Scholars*	Time Classes Begin	Monday, Tuesday, Thursday, Friday		Wednesday	
			Gate Opens	Dismissal Time	Gate Opens	Dismissal Time
PreKindergarten	92	8:00 AM	2:30 PM	3:00 PM	1:30 PM	1:45PM
Kindergarten	106		3:10 PM	3:30 PM	1:55 PM	2:15 PM
1st	99					
2nd	100					
3rd	109					
4th	86					
5th	84					

*Enrollment as of September 30, 2025

Observations were performed on the following dates to review the existing carline operations.

Date	Day of Week	Peak Observed	Peak Queue, vehicles
October 1, 2025	Wednesday	PM	92
October 2, 2025	Thursday	AM	44
October 9, 2025	Thursday	PM	96
October 21, 2025	Tuesday	PM	97

Peak Queue: The vehicular queue for picking up the Scholars reached ninety-seven vehicles inclusive of vehicles inside the school property. The queue did reach the intersection of Valley Glen and Samuel and, on one occasion, there were five vehicles observed on Samuel.

Available Queue: Primary School - 100 Vehicles

Surplus: There is no on campus surplus queuing space for the school peak vehicular demand.

White Rock Hills provides a uniformed traffic assistant at Valley Glen and Samuel. The main objective is for the officer to prohibit any queuing on Samuel Boulevard. The officer also provides traffic control to assist motorists in making a southbound right turn onto Samuel Boulevard. Another uniformed traffic officer is posted at the school entry and exit gate at Valley Glen. A third uniformed officer is

posted at the pedestrian gate near Ferguson Road to assist pedestrians entering and exiting the campus. Further detailed officer duties are provided in responses to staff comments.

Adjacent Parking

Multiple vehicles were observed to be parked along both sides of Valley Glen adjacent to the school campus. It is assumed that these vehicles belong to either residents or guests of the nearby apartment complex.

It is recommended to have no parking signs posted along both sides of Valley Glen south of the school driveway. Specific wording on the signs could restrict parking, standing or queuing on school days during certain hours.

The following recommendations may minimize peak queuing characteristics.

- Utilize uniformed traffic officers to prevent any queuing of vehicles on Valley Glen prior to 20 minutes before dismissal time. Enforcement of recommended “No Parking” signs along Valley Glen may be necessary to restrict early queuing.
- **Encourage carpooling between families** to reduce the number of vehicles arriving at the campus.

Please know that Uplift Education is continuing to work with staff, parents, carline assistant officers and myself to provide safe and efficient carline methodologies and practices.

Sincerely,

A handwritten signature in blue ink that reads "Elizabeth Crowe". The signature is fluid and cursive, with the first name and last name clearly distinguishable.

Elizabeth Crowe, PE

Elizabeth Crowe Engineering Associates, PLLC

TBPE Firm Registration Number F – 20105

CC: Gibran Torres, Sr. Director of Campus Support – Uplift Education
Roz McGinty, Regional Director of Operations – Uplift Education
Patty Gutierrez, Operations Director - White Rock Hills Preparatory

SCHOOL TMP REVIEW AND COMMITMENT

The school traffic management plan (TMP) for White Rock Hills Preparatory was developed with the intent of optimizing safety and efficiently accommodating vehicular traffic generated during the school's typical student drop-off and pick-up periods. A concerted effort and full participation of the school administration are essential to maintain safe and efficient traffic operations.

By consent of this submittal, the school administration hereby agrees to implement, adhere to, and support the strategies presented in this TMP for which the school is held responsible until or unless the City of Dallas deems those strategies are no longer necessary through a minor amendment.

Signature

January 12, 2026
Date

Name: Roz McGinty
Title: Regional Director of Operations Uplift Education