

FILE NUMBER: Z212-175(RM) **DATE FILED:** January 26, 2022

LOCATION: Southeast line of Kimsey Drive, northeast of Maple Avenue

COUNCIL DISTRICT: 2

SIZE OF REQUEST: Approx. 0.52 acre **CENSUS TRACT:** 4.06

REPRESENTATIVE: Rik Adamski, Ash & Lime

OWNER/APPLICANT: Ray Gilles, RJ Shekinah LLC

REQUEST: An application for a WR-3 Walkable Urban Residential District on property zoned an IR Industrial/Research District

SUMMARY: The purpose of the request is to allow multifamily on the site

CPC RECOMMENDATION: Approval

STAFF RECOMMENDATION: Approval

BACKGROUND INFORMATION:

- The area of request consists of three lots currently zoned an IR Industrial/Research District. One of the lots is currently undeveloped, and the other two lots are developed with single family.
- The applicant proposes to redevelop the site with multifamily under the standards of a WR-3 Walkable Urban Residential District from Article XIII, “Form Districts,” of Chapter 51A.

Zoning History:

There have been four zoning cases in the area in the last five years.

1. **Z178-220:** On June 27, 2018, City Council approved an MF-2(A) Multifamily District on property zoned an IR Industrial/Research District on the south line of Kimsey Drive, northeast of Maple Avenue.
2. **Z178-251:** On August 22, 2018, City Council approved an MF-2(A) Multifamily District on property zoned an IR Industrial/Research District on the northwest line of Kimsey Drive, northeast of Maple Avenue.
3. **Z178-389:** On January 23, 2019, City Council approved an MF-2(A) Multifamily District on property zoned an IR Industrial/Research District on the southeast line of Kimsey Drive, northeast of Maple Avenue.
4. **Z190-216:** On October 13, 2020, City Council approved Planned Development District No. 1037 for MU-2 Mixed Use District uses on property zoned an IR Industrial/Research District on the northwest line of Sadler Circle, northwest of Inwood Road.

Thoroughfares/Streets:

Thoroughfare/Street	Type	Existing/Proposed ROW
Maple Avenue	Local Street	56 feet
Kimsey Drive	Local Street	-

Traffic:

The Transportation Development Services Division of the Transportation Department has reviewed the request and determined that it will not significantly impact the surrounding roadway system.

STAFF ANALYSIS:

Comprehensive Plan:

The *forwardDallas! Comprehensive Plan* was adopted by the City Council in June 2006 and outlines several goals and policies which can serve as a framework for assisting in evaluating the applicant's request.

The request complies with the following land use goals and policies of the Comprehensive Plan:

LAND USE ELEMENT

GOAL 1.1 ALIGN LAND USE STRATEGIES WITH ECONOMIC DEVELOPMENT PRIORITIES

Policy 1.1.5 Strengthen existing neighborhoods and promote neighborhoods' unique characteristics.

GOAL 1.3 PROVIDE EQUITABLE OPPORTUNITIES FOR DALLAS RESIDENTS

Policy 1.3.1 Create housing opportunities throughout Dallas.

GOAL 1.4 COORDINATE PLANNING ACTIVITIES TO BALANCE TRANSPORTATION, LAND USE, INFRASTRUCTURE, AND THE ENVIRONMENT

Policy 1.4.2 Develop a multi-modal transportation network.

ECONOMIC ELEMENT

GOAL 2.1 PROMOTE BALANCED GROWTH

Policy 2.1.1 Ensure that zoning is flexible enough to respond to changing economic conditions.

GOAL 2.5 FOSTER A CITY OF GREAT NEIGHBORHOODS

Policy 2.5.1 Promote strong and distinctive neighborhoods to enhance Dallas' quality of life.

Policy 2.5.2 Ensure that existing and future residential areas are appropriately linked in order to enhance economic development and urban design benefits.

TRANSPORTATION ELEMENT

GOAL 4.2 PROMOTE A VARIETY OF TRANSPORTATION OPTIONS

Policy 4.2.2 Promote a network of on-street and off-street walking and biking paths.

URBAN DESIGN ELEMENT

GOAL 5.1 PROMOTE A SENSE OF PLACE, SAFETY, AND WALKABILITY

Policy 5.1.1 Promote pedestrian friendly streetscapes.

Policy 5.1.2 Define urban character in Downtown and urban cores.

Policy 5.1.3 Encourage complementary building height, scale, design, and character.

Policy 5.1.4 Enhance visual enjoyment of public space.

GOAL 5.3 ESTABLISHING WALK-TO CONVENIENCE

Policy 5.3.1 Encourage a balance of land uses within walking distance of each other.

NEIGHBORHOOD PLUS

GOAL 4.3 Enhance neighborhood desirability by improving infrastructure, housing stock, recreation, and safety.

GOAL 5.1 Encourage a wider range of well-designed and affordable housing types as a response to emerging homeownership preferences.

GOAL 5.2 Encourage infill development and existing home improvements in target neighborhoods to attract and retain homeowners.

Area Plan:

Stemmons Corridor – Southwestern Medical District Area Plan

The comprehensive plan identifies the Stemmons Corridor – Southwestern Medical District area as an area of growth and stresses the need for an area plan to guide this growth to foster desirable development patterns. The study area has numerous assets and opportunities including the Southwestern Medical District, DART light rail and Trinity Railway Express, Love Field Airport, the Victory Plaza and American Airlines Center area,

stable single family neighborhoods, trails and connectivity potential, Market Center, the Design District, and the Trinity River Park.

The plan designates the area of request as part of an Urban Residential – Medium area and as part of the DART Inwood Station strategic opportunity area. Urban Residential – Medium is characterized as offering a diversity of housing options ranging from townhomes to condos with a height of up to seven stories with limited commercial in a mixed use format encouraged on main corridors. The goals of the Dart Inwood Station strategic opportunity area include the following:

- Increase connectivity in the area uniting existing and new amenities
- Use DART Green Line right-of-way for trail
- Create new pedestrian connections
- Enhance area streets amenities to encourage pedestrian activity
- Encourage mixed use development with ground-floor retail
- Ensure appropriate transitions to adjacent single family neighborhoods

Staff finds the applicant’s request for a WR-3 Walkable Urban Residential District to be compatible with the goals of the Stemmons Corridor – Southwestern Medical District Area Plan because it would provide design standards in an urban form as well as an enhanced pedestrian experience along the street frontage.

Land Use:

	Zoning	Land Use
Site	IR Industrial/Research District	Single family, undeveloped
Northeast	IR Industrial/Research District	Single family
Southeast	IR Industrial/Research District	Undeveloped; vehicle display, sales, and service
Southwest	IR Industrial/Research District	Single family
Northwest	MF-2(A) Multifamily District	Multifamily

Land Use Compatibility:

The area of request currently abuts existing single family zoned an IR District to the northeast and southwest. Southeast of the site is undeveloped land as well as vehicle display, sales, and service. Northwest of the request area across Kimsey Drive is existing multifamily. Staff finds the applicant’s requested land use to be compatible with existing land uses in the surrounding area.

The applicant proposes to redevelop the site with multifamily under the standards of a WR-3 Walkable Urban Residential District from Article XIII, "Form Districts," of Chapter 51A. Staff supports the applicant's request because the enhanced development standards of a WR-3 District emphasize walkability and a pedestrian friendly environment, which are appropriate for this denser, urban style neighborhood with immediate proximity to the Inwood/Love Field DART station.

Overview of Form Districts

Form-based zoning differs from traditional zoning in that development standards focus primarily on the form of the building rather than its intended land use. Under form-based zoning, the desired form of buildings is typically more urban in style. Buildings are constructed with multiple stories and are located at the front of the site, closer to the street. This, coupled with enhanced standards for transparency, building articulation, and pedestrian amenities, are intended to ensure an active streetscape.

Another key feature that lends itself to a more urban development form is a requirement that buildings fill a percentage of the width of the lot with the building façade. This street frontage requirement creates a streetscape that encourages and supports pedestrian activity and screens parking. Benefits to property owners include additional buildable area on the site; increased height, density, and floor area; and reduced parking requirements that encourage the use of multi-modal transportation.

The applicant's request is for a WR-3 District, which is classified as low intensity among the several WR Walkable Urban Residential districts available in Article XIII. The WR districts are intended to create residential neighborhoods with mixed housing options in a pedestrian friendly environment. Although parcels of any size are eligible for a WR district, Article XIII indicates these districts are intended for locations where a sufficient critical mass of dense, walkable urban mixed-use development exists or is definitely planned. This critical mass is present when:

- (A) The surrounding area consists of at least 40 acres of existing or definitely planned WMU or WR zoning, high density multifamily zoning, multiple use zoning, or planned development zoning with equivalent characteristics;
- (B) The surrounding area consists of at least 25 acres proposed by and is part of and adopted area plan pursuant to *forwardDallas!* for WMU or WR zoning, high density multifamily zoning, multiple use zoning, or planned development zoning with equivalent characteristics; or
- (C) The applicant demonstrates that the surrounding area is at least 25 acres and is or will be a mix of dense residential, commercial, and other uses that will achieve the intent of this article for increased walkability, reduced vehicular trip generation, and reduced parking demand.

Article XIII also states that the WR districts are appropriate for major job centers and concentrations of multifamily housing where an area plan pursuant to *forwardDallas!* has been adopted.

Staff finds the area of request to be appropriate for a WR-3 District due to its proximity to existing high density multifamily and mixed use zoning, comparable planned development zoning, and other existing form districts to the immediate northwest and west of the site. Southeast of the request area along Inwood Road are other comparable planned development zoning and form districts as well as the Inwood/Love Field DART station. The area of request is also part of the adopted Stemmons Corridor – Southwestern Medical District Area Plan, which recommends high density zoning and land uses in addition to an enhanced pedestrian experience.

This is further supported by the Vision Illustration map of the comprehensive plan, which designates the request area as compatible with the recommendations for the Campus building block associated with the Southwestern Medical District. This style of development focuses on areas around large, master-planned educational, institutional, or business facilities outside downtown. Such areas include a range of single family and multifamily housing as well as a variety of offices, shops, services, and open space to support the major campus employer and area residents. Campus areas should also have convenient transit options as an integral component.

Land Use Comparison

Form-based zoning in Article XIII achieves complementary urban form by regulating land uses through several development types that allow different use categories. For example, the multifamily living use category is allowed under the Apartment (Apt.) development type.

A development containing three or more dwelling units consolidated into a single structure qualifies for the Apt. development type. Standards for the Apt. development type further specify that an apartment contains common walls. Dwelling units within a building may be situated either wholly or partially over or under other dwelling units. The building must be pulled up to the street. On-site surface parking must be located to the rear of the building, and no on-site surface parking is permitted between the building and the street. Primary entrances must be prominent and street facing, and an elevated ground floor for residential uses is recommended to ensure privacy.

The applicant's proposed use of the site would fall under the multifamily living use category within the Apt. development type. However, the WR-3 District would also allow other development types and use categories. Following is a comparison table showing differences in the permitted uses between the current IR District and the proposed WR-3 District. Blank cells indicate a comparable land use is not specified for that district.

Land Use Comparison Chart

Existing: IR	Proposed: WR-3
<p><u>Agricultural uses.</u> -- Crop production.</p>	
<p><u>Commercial and business service uses.</u> -- Building repair and maintenance shop. [RAR] -- Bus or rail transit vehicle maintenance or storage facility. [RAR] -- Catering service. -- Commercial cleaning or laundry plant. [RAR] -- Custom business services. -- Custom woodworking, furniture construction, or repair. -- Electronics service center. -- Job or lithographic printing. [RAR] -- Labor hall. [SUP may be required. See Section 51A-4.202 (8.1).] -- Machine or welding shop. [RAR] -- Machinery, heavy equipment, or truck sales and services. [RAR] -- Medical or scientific laboratory. -- Technical school. -- Tool or equipment rental. -- Vehicle or engine repair or maintenance.</p>	
<p><u>Industrial uses.</u> -- Alcoholic beverage manufacturing. [RAR] -- Gas drilling and production. [SUP] -- Industrial (inside). [See Section 51A-4.203(b)(1).] -- Industrial (inside) for light manufacturing. -- Industrial (outside). [See Section 51A-4.203(b)(2).] -- Medical/infectious waste incinerator. [SUP] -- Municipal waste incinerator. [SUP] -- Organic compost recycling facility. [SUP] -- Pathological waste incinerator. [SUP] -- Temporary concrete or asphalt batching plant. [By special authorization of the building official.]</p>	
<p><u>Institutional and community service uses.</u> -- Adult day care facility. -- Cemetery or mausoleum. [SUP] -- Child-care facility.</p>	<p><u>Civic use categories.</u> -- Ss, ground story only: Community service [SUP], museum, library; daycare; educational; government service, except</p>

Land Use Comparison Chart

Existing: IR	Proposed: WR-3
<ul style="list-style-type: none"> -- Church. -- College, university, or seminary. -- Community service center. -- Hospital. [RAR] -- Public or private school. [SUP] 	<p>detention center, jail, or prison; social service [SUP]; transit station</p> <ul style="list-style-type: none"> -- Ts, ground story only: Community service [SUP], museum, library -- Civ: Community service [SUP], museum, library; daycare; educational; government service, except detention center, jail, or prison; detention center, jail, or prison [SUP]; transit station <p><u>Place of worship use categories.</u></p> <ul style="list-style-type: none"> -- Ss, ground story only: Place of worship -- Civ: Place of worship
<p><u>Lodging uses.</u></p> <ul style="list-style-type: none"> -- Extended stay hotel or motel. [SUP] -- Hotel or motel. [RAR] -- Lodging or boarding house. -- Overnight general purpose shelter. [See Section 51A-4.205(2.1).] 	
<p><u>Miscellaneous uses.</u></p> <ul style="list-style-type: none"> -- Attached non-premise sign. [SUP] -- Carnival or circus (temporary). [By special authorization of the building official.] -- Hazardous waste management facility. [Except when operated as a hazardous waste incinerator.] -- Temporary construction or sales office. 	
<p><u>Office uses.</u></p> <ul style="list-style-type: none"> -- Alternative financial establishment. [SUP] -- Financial institution without drive-in window. -- Financial institution with drive-in window. [RAR] -- Medical clinic or ambulatory surgical center. -- Office. 	<p><u>Office use categories.</u></p> <ul style="list-style-type: none"> -- Ss, ground story only: Medical, office (office and medical only allowed along thoroughfare) -- Ts, ground story only: Office
<p><u>Recreation uses.</u></p> <ul style="list-style-type: none"> -- Country club with private membership. -- Private recreation center, club, or area. -- Public park, playground, or golf course. 	<p><u>Civic use categories.</u></p> <ul style="list-style-type: none"> -- O: Park or open space, utilities
<p><u>Residential uses.</u></p> <ul style="list-style-type: none"> -- None permitted. 	<p><u>Residential use categories.</u></p> <ul style="list-style-type: none"> -- Ts: Single-family living, multifamily living, group living -- Th: Single family living, multifamily living, group living

Land Use Comparison Chart

Existing: IR	Proposed: WR-3
	-- Mh: Single-family living, multifamily living, group living -- Apt: Multifamily living, group living
<p><u>Retail and personal service uses.</u></p> -- Alcoholic beverage establishments. [See Section 51A-4.210(b)(4).] -- Animal shelter or clinic without outside runs. -- Animal shelter or clinic with outside runs. [SUP may be required. See Section 51A-4.210(b)(2).] -- Auto service center. [RAR] -- Business school. -- Car wash. [RAR] -- Commercial amusement (inside). [SUP may be required. See Section 51A-4.210(b)(7)(B).] -- Commercial motor vehicle parking. [By SUP only if within 500 feet of a residential district.] -- Commercial parking lot or garage. [RAR] -- Convenience store with drive-through. [SUP] -- Dry cleaning or laundry store. -- Furniture store. -- General merchandise or food store 3,500 square feet or less. -- Home improvement center, lumber, brick or building materials sales yard. [RAR] -- Household equipment and appliance repair. -- Liquefied natural gas fueling station. [By SUP only if the use has more than four fuel pumps or is within 1,000 feet of a residential zoning district or a planned development district that allows residential uses.] -- Motor vehicle fueling station. -- Paraphernalia shop. [SUP] -- Pawn shop. -- Personal service uses. -- Restaurant without drive-in or drive-through service. [RAR] -- Restaurant with drive-in or drive-through service. [DIR]	<p><u>Retail use categories.</u></p> -- Ss, ground story only: Drive-thru facility [SUP], restaurant or bar, retail sales, vehicle sales
	<p><u>Service and entertainment use categories.</u></p> -- Ss, ground story only: Commercial amusement (inside) [SUP]; indoor recreation; personal service, including animal care
	<p><u>Commerce use categories.</u></p> -- O: Commercial parking

Land Use Comparison Chart

Existing: IR	Proposed: WR-3
<ul style="list-style-type: none"> -- Taxidermist. -- Temporary retail use. -- Theater. -- Truck stop. [SUP] -- Vehicle display, sales, and service. [RAR] 	
<p><u>Transportation uses.</u></p> <ul style="list-style-type: none"> -- Airport or landing field. [SUP]. -- Commercial bus station and terminal. [RAR]. -- Heliport. [RAR] -- Helistop. [RAR] -- Railroad passenger station. [SUP] -- STOL (short take off or landing) port. [SUP] -- Transit passenger shelter. -- Transit passenger station or transfer center. [By SUP or city council resolution. See Section 51A-4.211.] 	
<p><u>Utility and public service uses.</u></p> <ul style="list-style-type: none"> -- Commercial radio or television transmitting station. -- Electrical substation. -- Local utilities. [SUP or RAR may be required. See Section 51A-4.212(4).] -- Police or fire station. -- Post office. -- Radio, television, or microwave tower. [RAR] -- Tower/antenna for cellular communication. [See Section 51A-4.212(10.1).] -- Utility or government installation other than listed. [SUP] -- Water treatment plant. [SUP] 	
<p><u>Wholesale, distribution, and storage uses.</u></p> <ul style="list-style-type: none"> -- Freight terminal. [RAR] -- Manufactured building sales lot. [RAR] -- Mini-warehouse. -- Office showroom/warehouse. -- Outside storage. [RAR] -- Recycling buy-back center. [See Section 51A-4.213(11).] -- Recycling collection center. [See Section 51A-4.213(11.1).] -- Recycling drop-off container. [See Section 51A-4.213(11.2).] 	

Land Use Comparison Chart

Existing: IR	Proposed: WR-3
-- Recycling drop-off for special occasion collection. [See Section 51A-4.213(11.3) .] -- Trade center. -- Warehouse. [RAR]	

Development Standards

Beyond the regulation of land uses through development types in Article XIII, each development type includes more traditional development standards (setbacks, density, height, etc.) in addition to enhanced development standards that contribute to a pedestrian friendly environment (street frontage, parking setbacks, transparency, etc.).

Following is a comparison table showing differences between the development standards of the current IR District and the proposed WR-3 District. Included in the WR-3 column are the development standards applicable to the Apt. development type. Development standards have been consolidated to indicate what is applicable to the context of this particular site. Blank cells indicate a requirement is not specified for that development standard.

Development Standards Comparison Chart

Standard	Existing: IR	Proposed: WR-3
Front setback	15' min	Primary street: 5' min / 15' max
Required street frontage, primary street*		Primary street: 70% min
Parking setback		Primary street: 30' min Abutting nonresidential district: 5' min
Side setback	30' adj to res Other: No min	Abutting nonresidential district: 0' or 5' min
Rear setback	30' adj to res Other: No min	Abutting nonresidential district: 0' or 5' min
Density	2.0 FAR overall 0.75 office/retail 0.5 retail	None
Height	200' 15 stories	1 story min 3.5 stories / 50' max
Story height		Ground story: 10' min / 15' max Upper story: 10' min / 15' max
Lot coverage	80%	80% max
Transparency		Ground story, primary street façade: 30%

Development Standards Comparison Chart

Standard	Existing: IR	Proposed: WR-3
		Upper story, primary street façade: 20%
Entrance		Required on primary street Entrance spacing: None
Blank wall area		Primary street: 30' max
Special standards	Proximity slope Visual intrusion	Proximity slope

* Kimsey Drive is designated as a primary street

Landscaping:

Under the proposed WR-3 District, landscaping for multifamily living uses in an Apt. development type must be in accordance with Article X, as amended. Additionally, Article XIII requires that at least 8% of the net land area of a building site in a form district be provided as open space. Compliance with the open space requirement must be demonstrated at the time of application for a building permit.

Parking:

Under the proposed WR-3 District, the site must comply with the parking requirement for household living uses in Article XIII. This requirement is 1.15 spaces per one-bedroom or smaller multifamily living unit, 1.65 spaces per two-bedroom multifamily living unit, and two spaces per three-bedroom or larger multifamily living unit.

Market Value Analysis:

Market Value Analysis (MVA), is a tool to aid residents and policy-makers in understanding the elements of their local residential real estate markets. It is an objective, data-driven tool built on local administrative data and validated with local experts. The analysis was prepared for the City of Dallas by The Reinvestment Fund. Public officials and private actors can use the MVA to more precisely target intervention strategies in weak markets and support sustainable growth in stronger markets. The MVA identifies nine market types (A through I) on a spectrum of residential market strength or weakness. As illustrated in the attached MVA map, the colors range from purple representing the strongest markets (A through C) to orange, representing the weakest markets (G through I). The area of request is currently in an “E” MVA area. There are other “E” MVA areas to the east and west of the request area.

Z212-175(RM)

List of Officers

RJ Shekinah LLC

Ray Gilles, Principal

**CPC ACTION
JUNE 16, 2022**

Motion: It was moved to recommend **approval** of a WR-3 Walkable Urban Residential District on property zoned an IR Industrial Research District on the southeast line of Kimsey Drive, northeast of Maple Avenue.

Maker: Hampton
Second: Carpenter
Result: Carried: 10 to 0

For: 10 - Hampton, Anderson, Shidid, Carpenter, Blair,
Housewright, Gibson, Haqq, Kingston, Rubin

Against: 0
Absent: 3 - Vann, Jung, Stanard
Vacancy: 1 - District 3
Conflict: 1 - Popken**

**out of the room, when vote taken

Notices: Area: 200 Mailed: 31
Replies: For: 1 Against: 0

Speakers: For: None
For (Did not speak): Rik Adamski, 701 Commerce St., Dallas, TX, 75202
Against: None

**CPC ACTION
MAY 19, 2022**

Motion: In considering an application for a WR-3 Walkable Urban Residential District on property zoned an IR Industrial Research District on the southeast line of Kimsey Drive, northeast of Maple Avenue, it was moved to **hold** this case under advisement until June 16, 2022.

Maker: Hampton
Second: Housewright
Result: Carried: 10 to 0

For: 10 - Popken, Hampton, Anderson, Shidid,
Carpenter, Blair, Housewright, Stanard,
Kingston, Rubin

Against: 0
Absent: 4 - Vann, Jung, Gibson, Haqq
Vacancy: 1 - District 3

Notices: Area: 200 Mailed: 31
Replies: For: 1 Against: 0

Speakers: For: None
For (Did not speak): Rik Adamski, 701 Commerce St., Dallas, TX, 75202
Against: None

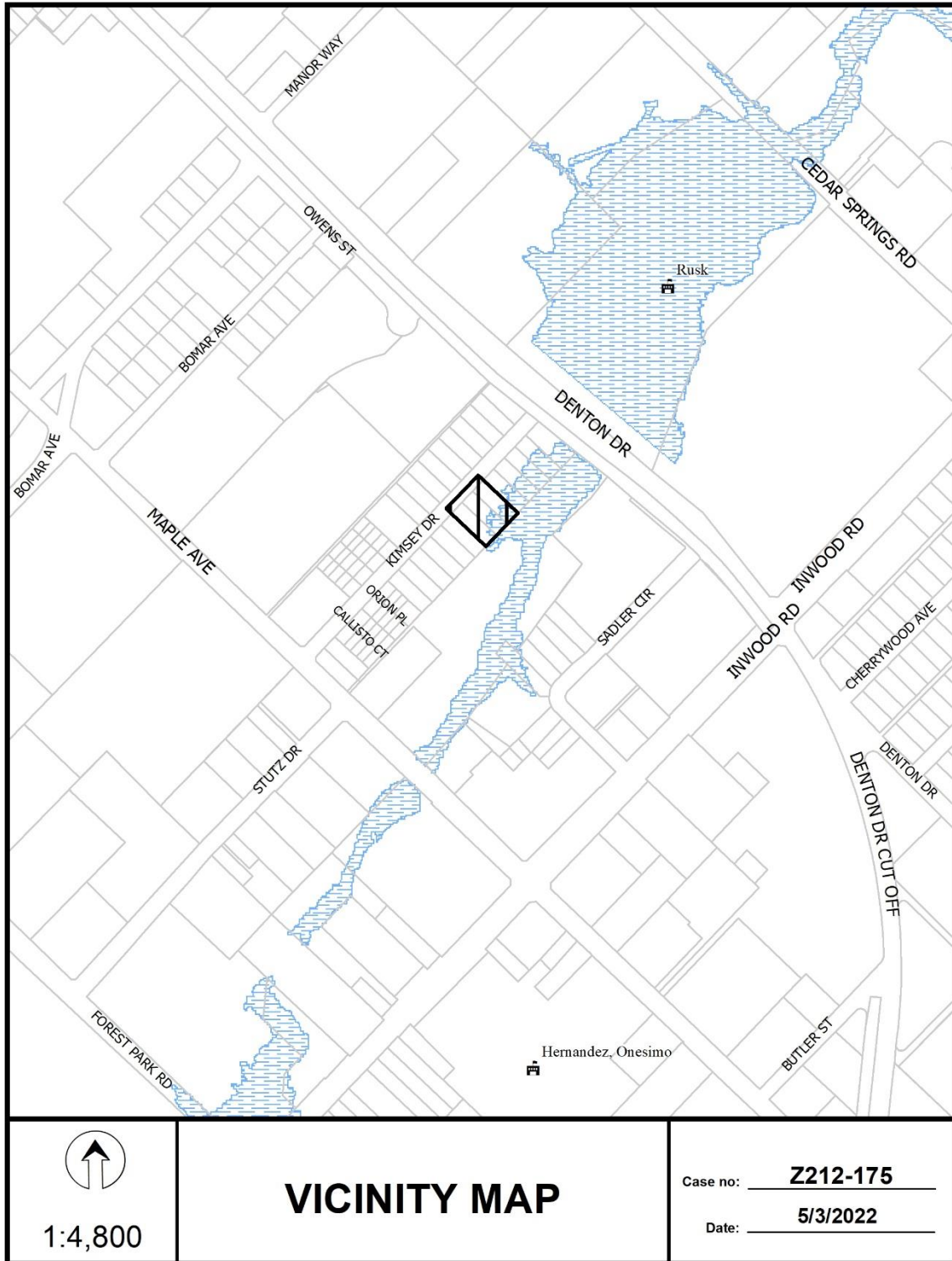



1:1,200

AERIAL MAP

Case no: Z212-175

Date: 5/3/2022

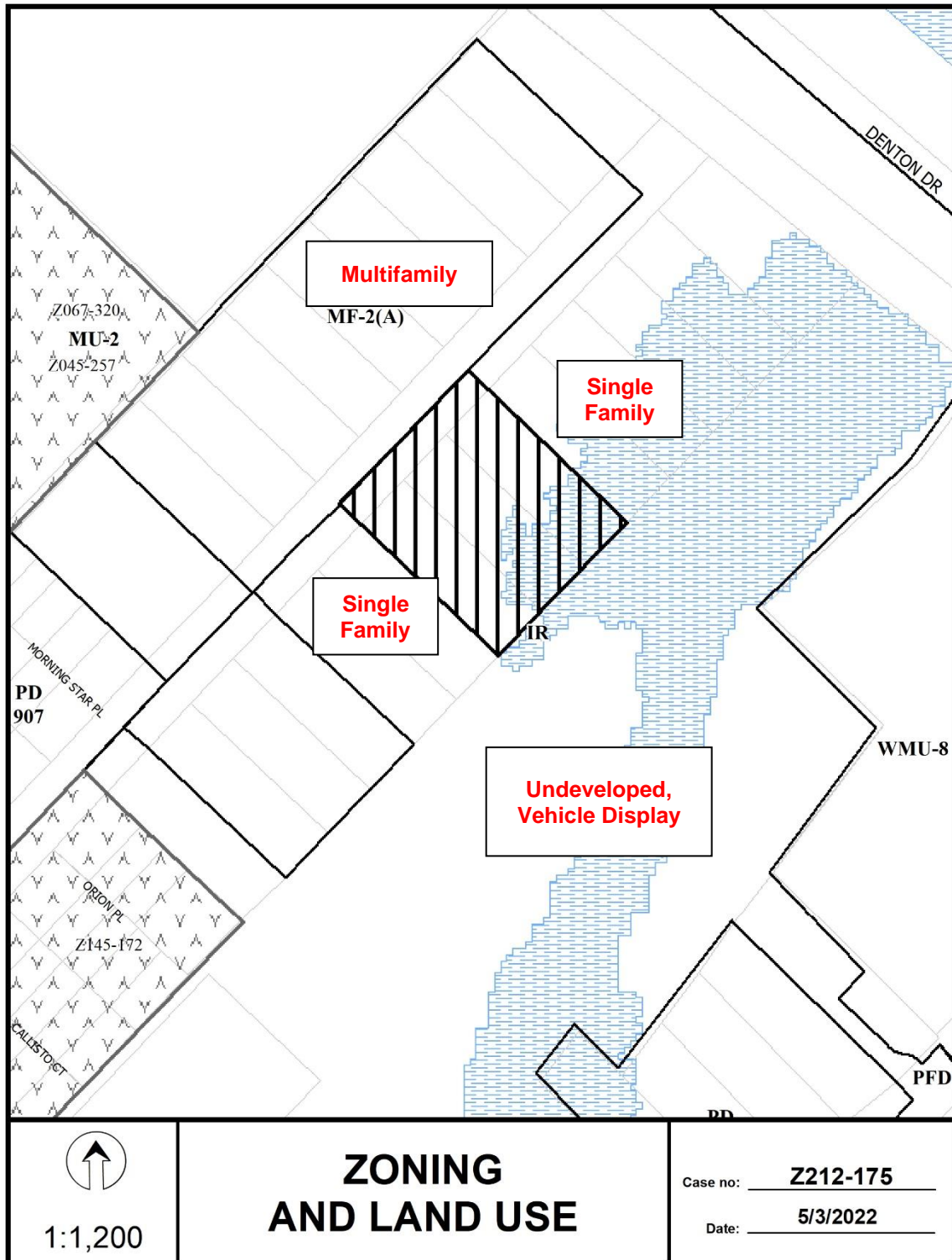

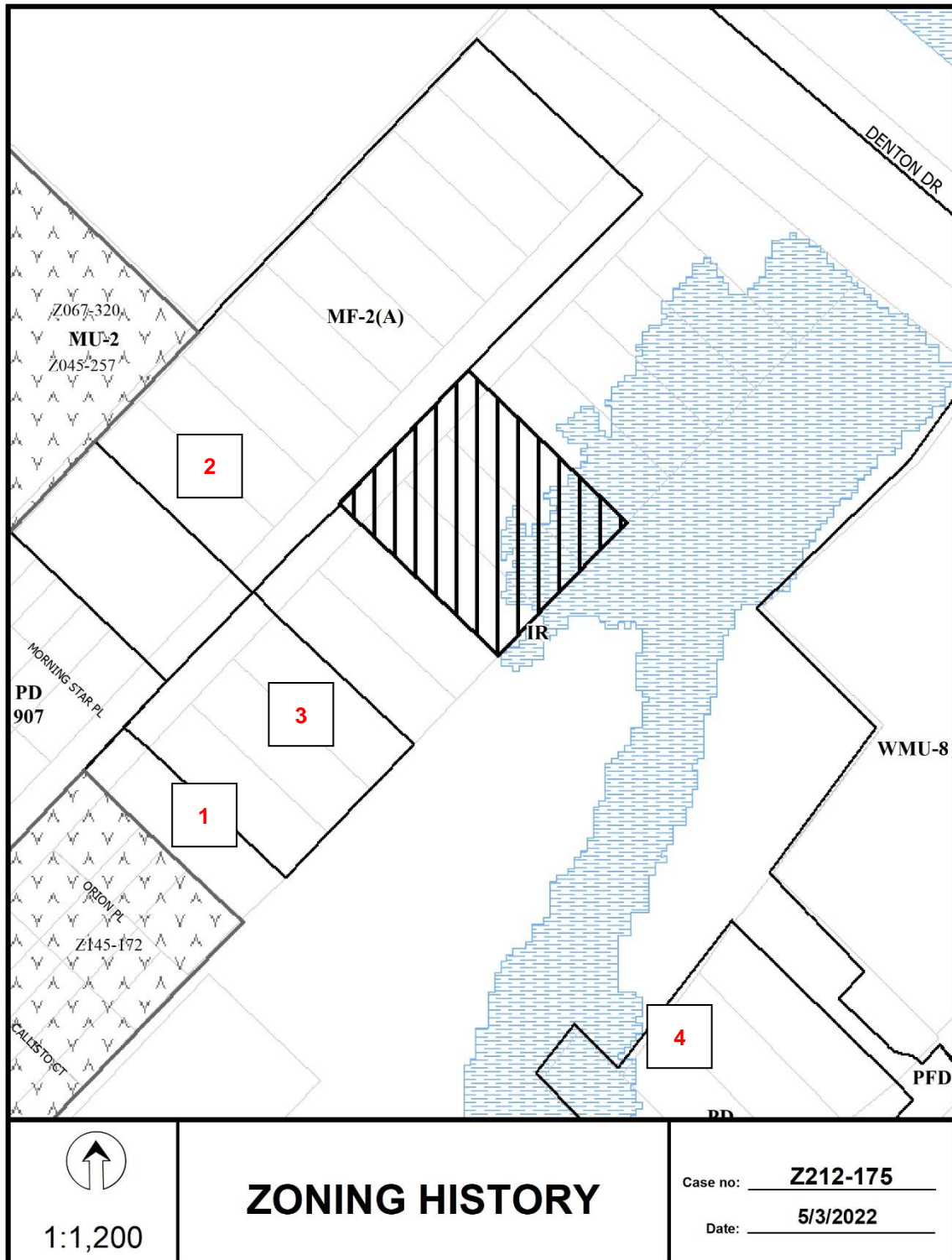

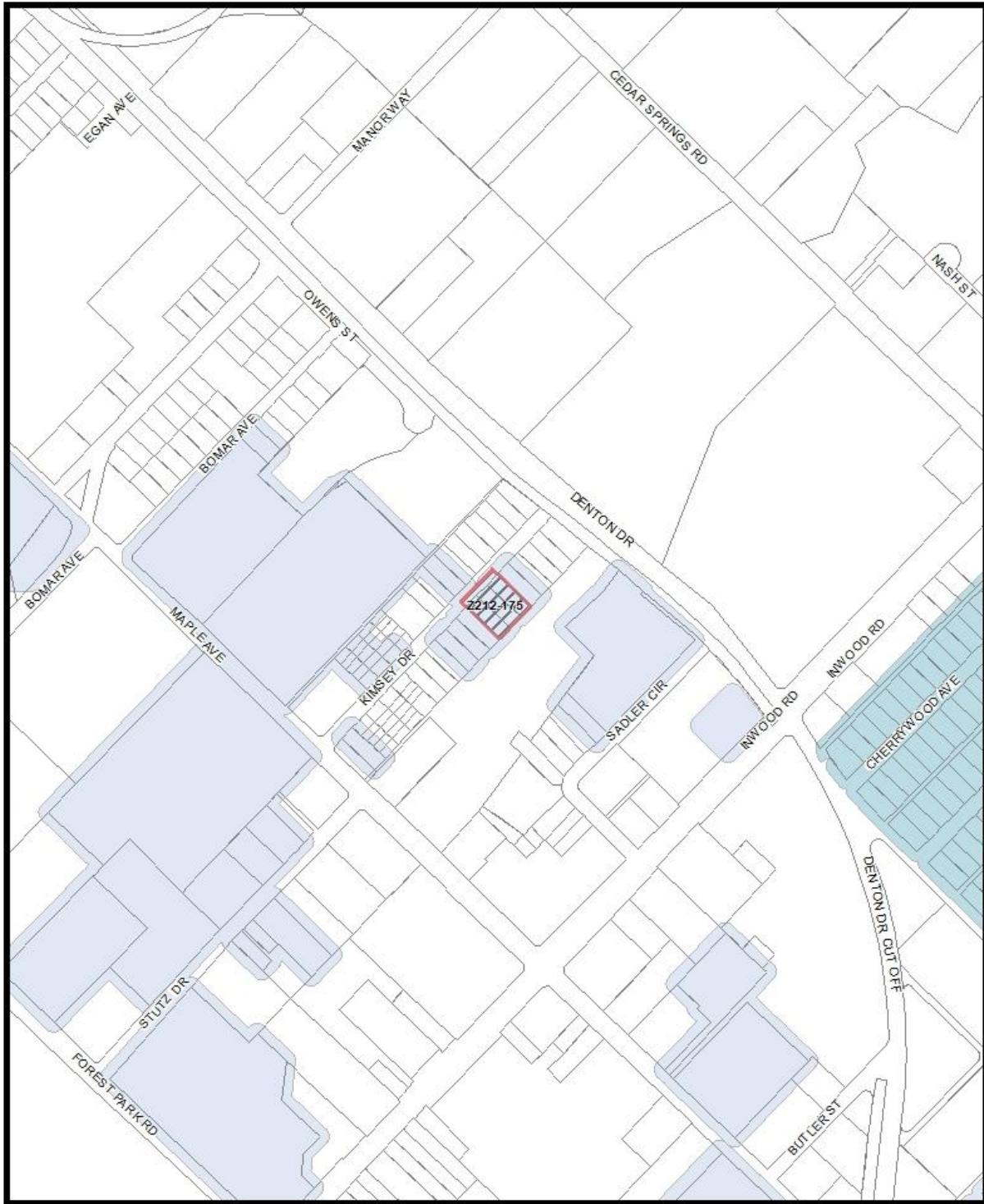

MVACluster A B C D E F G H I NA

 1:4,800

Market Value Analysis

Printed Date: 5/11/2022



31	Property Owners Notified (26 parcels)
1	Replies in Favor (1 parcels)
0	Replies in Opposition (0 parcels)
200'	Area of Notification
6/16/2022	Date

Z212-175
CPC



1:1,200

06/15/2022

Reply List of Property Owners***Z212-175******31 Property Owners Notified 1 Property Owners in Favor 0 Property Owners Opposed***

<i>Reply</i>	<i>Label #</i>	<i>Address</i>	<i>Owner</i>
	1	2626 KIMSEY DR	RG SHEKINAH LLC
	2	2706 KIMSEY DR	RG SHEKINAH LLC
	3	2610 KIMSEY DR	LACUNA CONCEPTS LLC
	4	2618 KIMSEY DR	HEED CYNTHIA LOUISE
	5	2622 KIMSEY DR	MARTINEZ ALEXANDER C &
O	6	2710 KIMSEY DR	CORONADO JOSE & ANA M
	7	2714 KIMSEY DR	PECINA DAGOBERTO R &
	8	2718 KIMSEY DR	SOTO GERARDO
	9	2722 KIMSEY DR	JMH 2020 GST TRUST
	10	2619 KIMSEY DR	DOLLINGER MICHAEL G &
	11	2711 KIMSEY DR	ASAI RYO
	12	2715 KIMSEY DR	DEVONSHIRE VENTURES LLC
	13	2723 KIMSEY DR	DEVONSHIRE VENTURES LLC
	14	5747 SADLER CIR	NTHP INWOOD INC
	15	5760 MAPLE AVE	Taxpayer at
	16	2611 KIMSEY DR	WINE MAISON LLC
	17	6008 MAPLE AVE	AMLI 6008 MAPLE AVENUE LLC
	18	6025 OWENS ST	Taxpayer at
	19	2703 KIMSEY DR	KJWJ HOLDINGS CORP
	20	2703 KIMSEY DR	BAKER STREET HOLDINGS LLC
	21	2703 KIMSEY DR	MAHENDRAN SABARI
	22	2707 KIMSEY DR	DEVONSHIRE VENTURES LLC
	23	2719 KIMSEY DR	LEET KHRIS ALLAN
	24	2719 KIMSEY DR	MCCAIN ANTHONY RAY JR
	25	2719 KIMSEY DR	HALE DAVID JR
	26	2719 KIMSEY DR	ROBBINS DION JARED

Z212-175(RM)

06/15/2022

<i>Reply</i>	<i>Label #</i>	<i>Address</i>	<i>Owner</i>
	27	2623 KIMSEY DR	WILSON KENNETH WAYNE JR
	28	2623 KIMSEY DR	TRUE STEVEN M & AMBER K
	29	2623 KIMSEY DR	CHEN LIFENG
	30	2623 KIMSEY DR	SAYLER CLIFT E
	31	2623 KIMSEY DR	RAZOMADRID RAMON MOISES