

N89° 35' W 546.00'

LONG BRANCH LANE

483.35'

General Notes:

1. The purpose of this plan is to show the purposed building footprint as defined by the metes and bounds of the recorded plat.
2. Dimensions, setbacks, easements, plan selection, and any other information shown here in shall be verified at permitting and prior to construction for accuracy and compliance with all applicable codes and ordinances.
3. Builder is solely responsible for ensuring that the footprint is contained within the prepared building pad. The building pad shall be set high enough to allow for adequate drainage.
4. All calculations are approximate. They must be verified prior to permitting, purchasing, and/or construction.

10.63' ACS

N00° 26' E 841.80'

7.5' ALLEY

L=298.05'  
 $\Delta$  16° 00'  
 R=1067.31'  
 T=150.00'

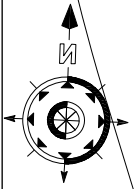

60'  
 66.05'

476.25'  
 S89° 48'00" W

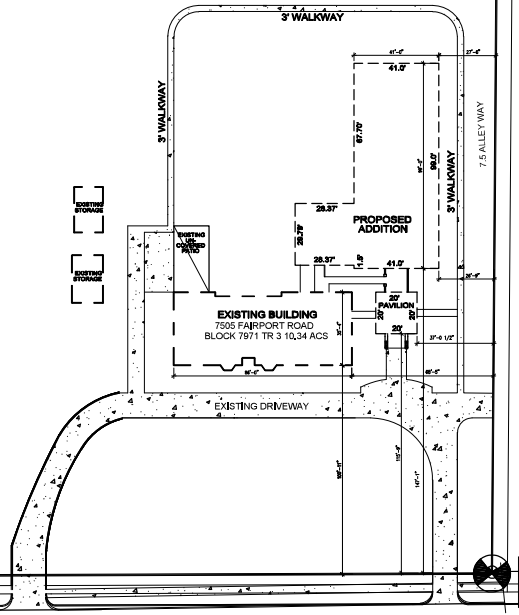

FAIRPORT ROAD

SUBDIVISION PLAT

Lot: TR 3 Blk: 7971  
 7505 FAIRPORT ROAD  
 DALLAS, TEXAS  
 Plan No.

PLOT PLAN

ENGINEERED FOR:  
 7505 FAIRPORT ROAD  
 DALLAS TX.  
 PROPOSED SITE PLAN



DATE 4-12-23

DR'N J.G. CHK'D S.G.

Scale: 1"=60'

PAGE 1 of 1