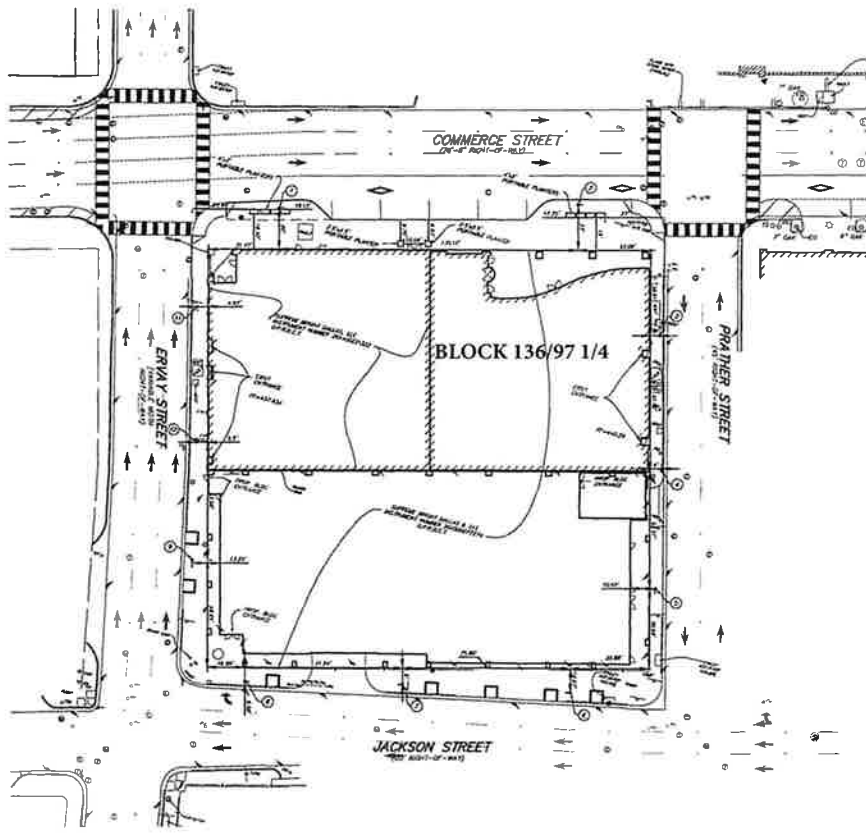
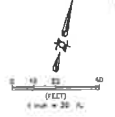

EXHIBIT A



ACCESS LINE NUMBER: 3000



SITE LIGHTING DIMENSIONS			
LIGHT NUMBER	DISTANCE FROM BASE TO BUILDING OR PL	DISTANCE FROM BASE TO FACE OF CURB	ACCESSIBLE PARAPET
1	20'-0"	2'-0"	18'-0"
2	22'-0"	2'-0"	15'-0"
3	25'-0"	2'-0"	4'-0"
4	25'-0"	1'-0"	6'-0"
5	2' TO BLDG OVERHANG 10'-5" TO BLDG	7'-0"	10'-0"
6	12'-0"	1'-0"	12'-0"
7	8'-0"	1'-0"	8'-0"
8	8'-0"	1'-0"	2'-0"
9	7'-0" TO BLDG OVERHANG 15'-7" TO BLDG	1'-0"	11'-0"
10	2'-0"	2'-0"	2'-0"
11	4'-0"	2'-0"	4'-0"

NOTE:
PLANTERS ARE PERMANENT AND HIGH PERMANENT PLANTINGS MEASUREMENTS NOT TAKEN ON SITE BY ARCHITECT. ENGINEER DOES NOT ASSUME ANY RESPONSIBILITY FOR POTENTIAL RELOCATION OF PORTABLE PLANTINGS AFTER THE DATE THE MEASUREMENTS WERE TAKEN.

DISCLAIMER:
THE CITY OF DALLAS DOES NOT GUARANTEE THE ACCURACY OF THE INFORMATION PROVIDED IN THIS EXHIBIT AND IS NOT RESPONSIBLE FOR ANY ERRORS OR OMISSIONS. THE CITY OF DALLAS DOES NOT GUARANTEE THE ACCURACY OF THE INFORMATION PROVIDED IN THIS EXHIBIT AND IS NOT RESPONSIBLE FOR ANY ERRORS OR OMISSIONS.



91 sqft - Total

SHEET NO.
C0.01

LIGHTING EXHIBIT					
COMMERCE STREET DART BUS LANE RELOCATION					
RAYMOND L. GOODSON, JR., INC.					
MERRIMAN ASSOCIATES					
CITY OF DALLAS, TEXAS					
DESIGN	DATE	SHEET	TOTAL	REV	NO.
RLC	1/20/21	11-207	14,333	311T	9138
JOB NO. 14333 SUBMITTAL LIGHTING EXHIBIT					