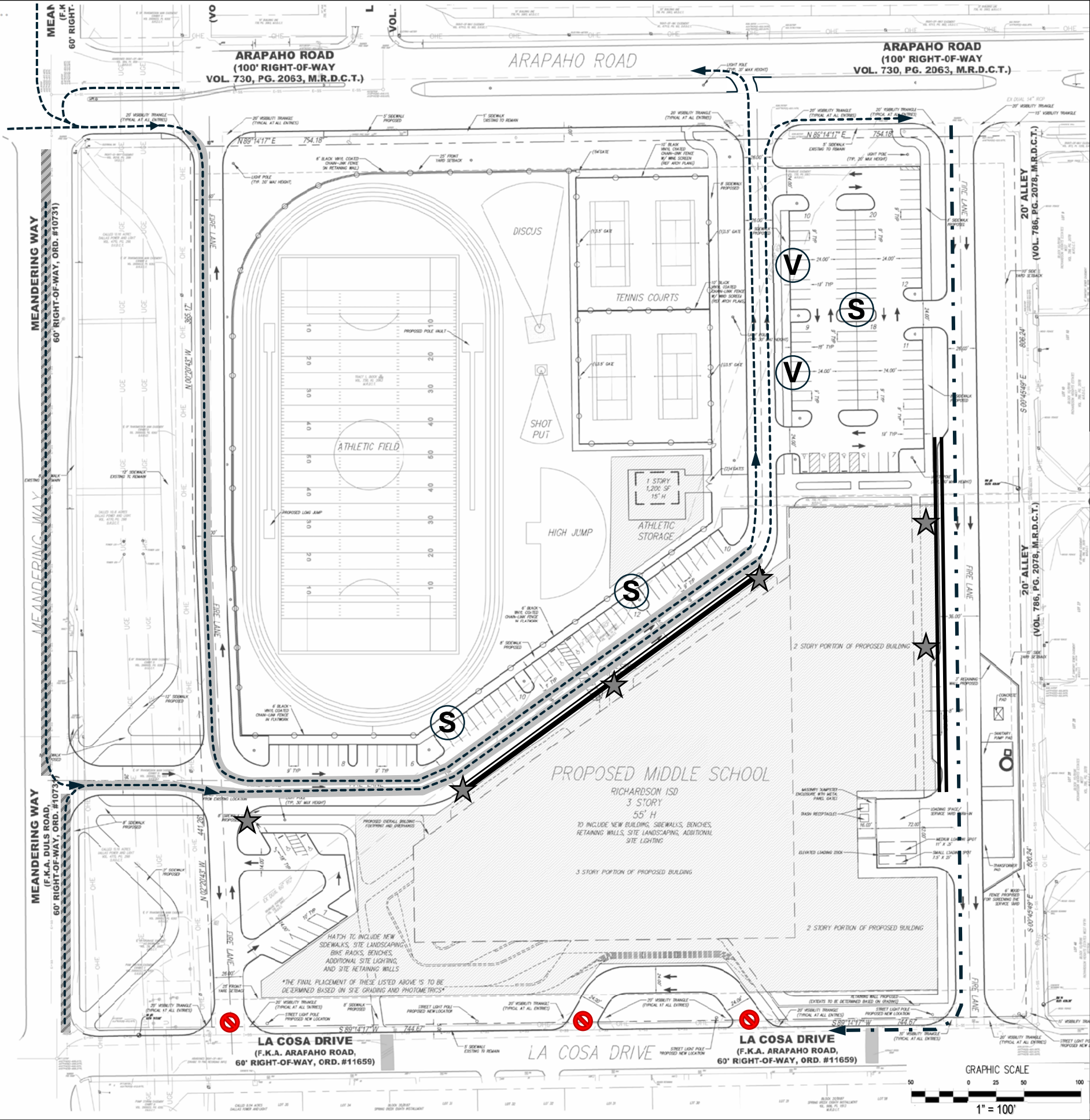

Exhibit 1 - Westwood Traffic Management Plan



LEGEND

- Student Drop-off/Pick-up Paths
- Active Student Unloading/Loading Area
- Bus Drop-off/Pick-up Path
- Bus Unloading/Loading Area
- No Parking/Stopping/Standing
- On-Site Queuing Areas
- On-Street Queuing Areas
- No Entry (Cones or Bollards)
- Visitor Parking
- Staff Parking
- Staff Assistants

Queuing (Passenger Vehicles)

Demand: 2,700 feet
Capacity: 1,850 feet
On-street Queue: 850 feet

Campus Information

Projected Enrollment: 927
Future Academic: 6th to 8th Grade
Class Hours: 8:15 am – 3:40 pm
Buses: 9 – 10, 275 – 300 Students
7.5 to 8.4% Students Walking

School Zones

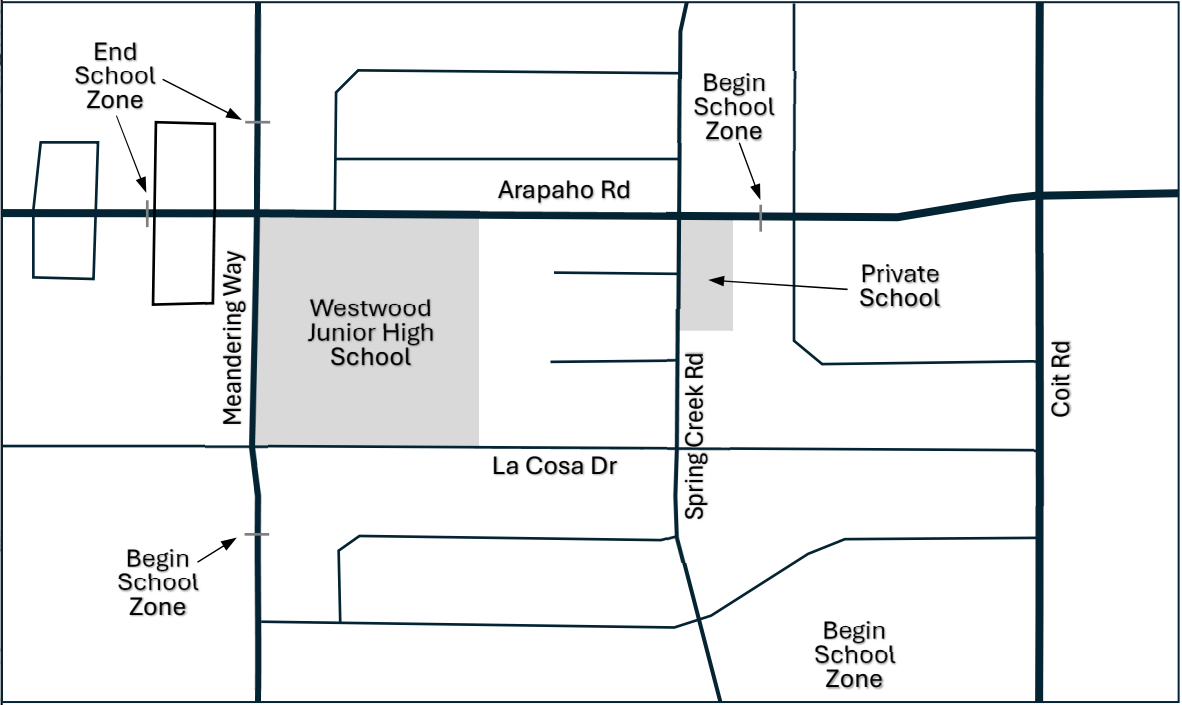

This Traffic Management Plan was developed to minimize the queuing of drop-off/pick-up related vehicles within the City right-of-way. The school administration should adhere to the TMP and any deficiency due to spill over of queuing into undesignated areas of the City right-of-way, including roadway travel lanes, should be corrected by the school immediately.