

EXISTING SINGLE FAMILY  
BLOCK 8734  
RLH INVESTMENTS, INC., TRUSTEE  
C.C.C.F. NO. 93-0114595, L.R.C.C.T.

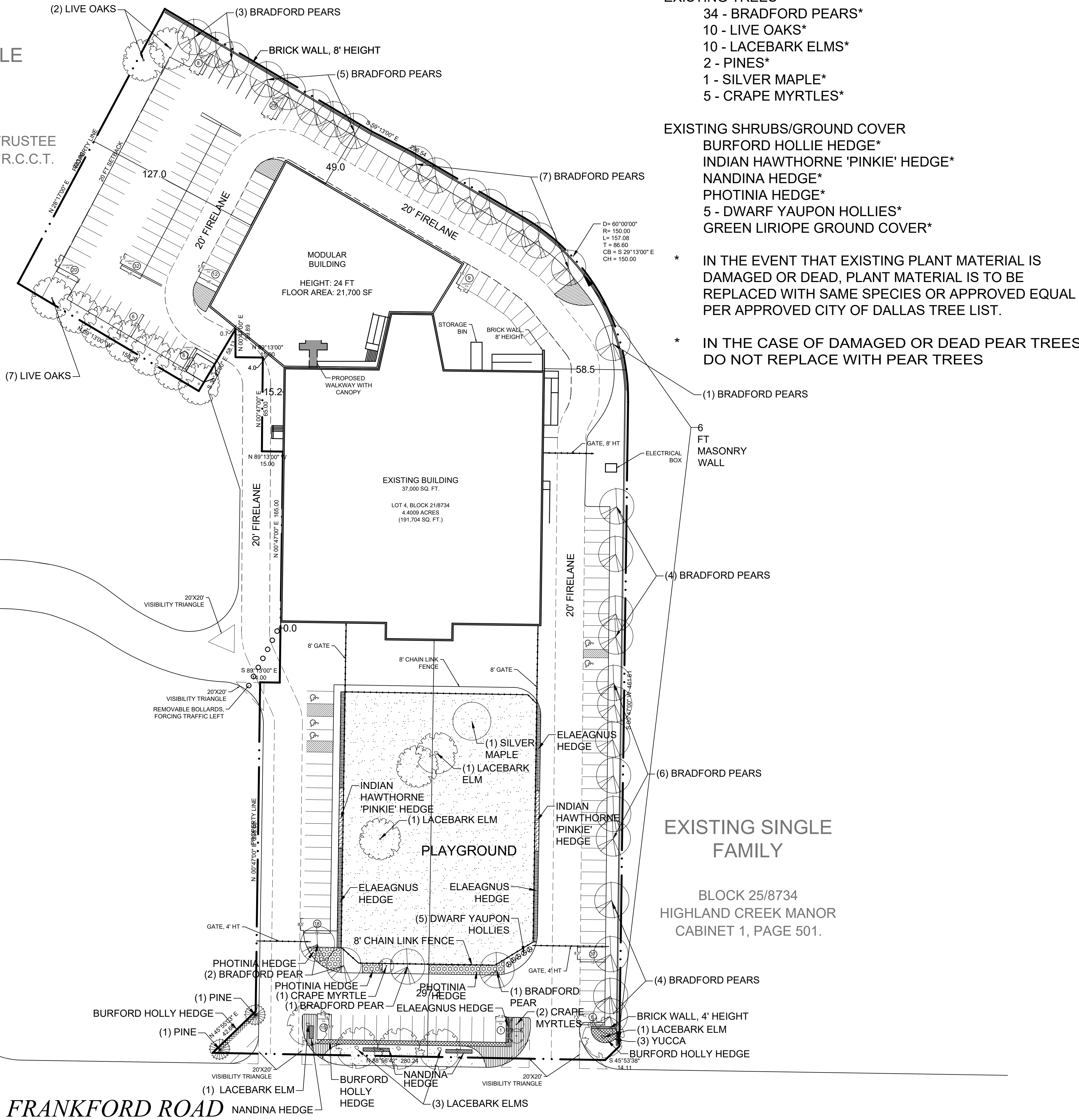

SCHEDULE OF PLANTS:

- EXISTING TREES  
 34 - BRADFORD PEARS\*  
 10 - LIVE OAKS\*  
 10 - LACEBARK ELMS\*  
 2 - PINES\*  
 1 - SILVER MAPLE\*  
 5 - CRAPE MYRTLES\*

- EXISTING SHRUBS/GROUND COVER  
 BURFORD HOLLIE HEDGE\*  
 INDIAN HAWTHORNE 'PINKIE' HEDGE\*  
 NANDINA HEDGE\*  
 PHOTINIA HEDGE\*  
 5 - DWARF YAUPON HOLLIES\*  
 GREEN LIRIOPE GROUND COVER\*

- \* IN THE EVENT THAT EXISTING PLANT MATERIAL IS DAMAGED OR DEAD, PLANT MATERIAL IS TO BE REPLACED WITH SAME SPECIES OR APPROVED EQUAL PER APPROVED CITY OF DALLAS TREE LIST.
- \* IN THE CASE OF DAMAGED OR DEAD PEAR TREES DO NOT REPLACE WITH PEAR TREES

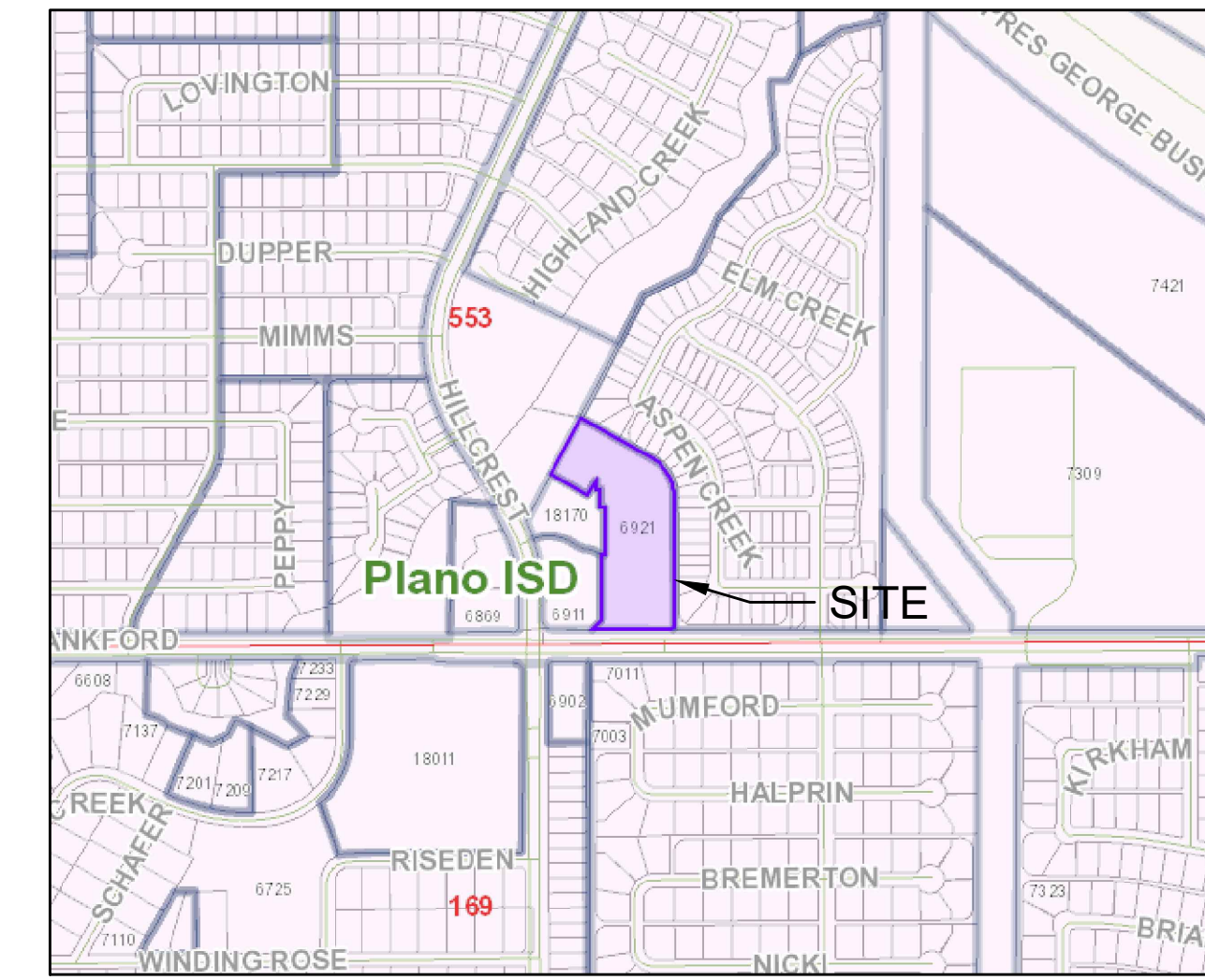

VICINITY MAP  
NTS

ARTICLE X REQUIREMENTS

SITE AREA: 191,324 SF  
4.39 ACRES

SITE TREES REQUIRED: 48  
(1/4,000 SF)  
PLAN PROVIDES: 53 TREES

FRONTAGE TREES REQUIRED: 6  
(1/50 LF)  
PLAN PROVIDES: 7 TREES

- PLAN PROVIDES REQUIRED PARKING LOT TREES
- PLAN PROVIDES REQUIRED LANDSCAPE ADJACENCY BUFFERS

DESIGN STANDARDS PROVIDED:  
 (b) STREET BUFFER  
 (c) SCREENING OF OFF-STREET PARKING

TORAH DAY SCHOOL OF DALLAS  
LANDSCAPE PLAN

08/28/2023  
PROJECT NUMBER  
CASE NUMBER

BALDWIN ASSOCIATES  
3904 Elm Street, Suite B  
Dallas, Texas 75226  
MOBILE: 214.729.7949  
OFFICE: 214.824.7949  
rob@baldwinplanning.com

**Baldwin Associates**

TORAH DAY SCHOOL OF DALLAS  
CITY OF DALLAS, TEXAS



1 LANDSCAPE PLAN  
SCALE: 1" = 40'-0"



M223-016(TB)