

**FLOOR PLAN**  
**1st STORY**

SCALE 1/8" = 1'-0"

## UL U305

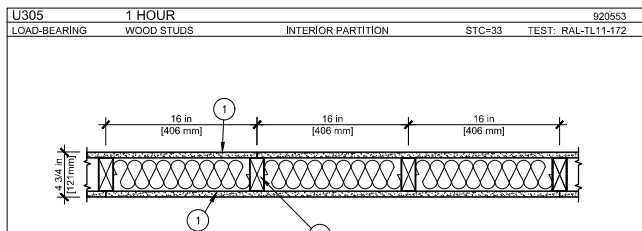

**FIRE WALL**  
**DETAIL**

NTS.

## WINDOWS SCHEDULE

ITEM	SIZE	QUANTITY	TYPE
1	4'-0" X 5'-0"	4	SH
2	3'-0" X 5'-0"	12	SH
3	3'-0" X 3'-0"	2	SH

SH = SINGLE HUNG

## DOORS SCHEDULE

ITEM	SIZE	QUANTITY	TYPE
A	3'-0" X 7'-0"	2	SHS
B	2'-8" X 6'-8"	2	SHH
C	2'-6" X 6'-8"	4	SHH
D	2'-0" X 6'-8"	4	SHH
E	5'-0" X 6'-8"	2	FR
F	2'-8" X 6'-8"	2	SHS

SHS = SINGLE HINGED SOLID CORE  
SHH = SINGLE HINGED HOLLOW CORE  
FR = FRENCH

NOTE: Quantities inches both units

## IECC 2021 GREEN/ENERGY CODE COMPLIANCE FOR HOME

ALL GREEN/ENERGY SYSTEMS MUST MEET THE REQUIREMENTS FROM THE CHAPTER 4 OF THE INTERNATIONAL ENERGY CONSERVATION CODE, REFERRED TO RESIDENTIAL ENERGY EFFICIENCY. IF ANY ITEM IS NOT LISTED BELOW REFER TO THE MENTIONED CHAPTER.

- STORMWATER:**
  - 1.1. TOP OF NON-ROOF AREA HAS VEGETATIVE LANDSCAPE, PERMEABLE PAVING OR SLOPED FOR RUNOFF TO A PERMANENT FILTRATION FEATURE.
- WATER EFFICIENCY:**
  - 2.1. LAVATORY FAUCETS MUST HAVE AN AVERAGE FLOW RATE OF 2.0 GALLONS PER MINUTE OR LESS.
  - 2.2. SHOWERS HEADS MUST HAVE AN AVERAGE FLOW RATE OF 2.0 GALLONS PER MINUTE OR LESS.
  - 2.3. TOILETS MUST HAVE AN AVERAGE FLOW RATE OF:
    - 2.3.1. LESS THAN OR EQUAL TO 1.3 GALLONS PER FLUSH.
    - 2.3.2. DUAL FLUSH COMPLYING WITH ASME A-112.19.14.
    - 2.3.3. COMPLY WITH US EPA WATER SENSE.
  - 2.4. ENERGY STAR DISHWASHER.
  - 2.5. ENERGY STAR CLOTHES WASHER.
- HEAT ISLAND MITIGATION:**
  - 3.1. ENERGY STAR QUALIFIED ROOF SYSTEM FOR ROOF WITH SLOPE OF 2:12 OR GREATER.
  - 3.2. RADIANT BARRIER IN ATTIC WITH CONVENTIONAL SHINGLES.
  - 3.3. ENCAPSULATED FOAM INSULATION BETWEEN THE ROOF RAFTERS (R-22 OR GREATER).
  - 3.4. WINDOWS AND DOORS MUST BE SEALED WITH FOAM OR CAULK.
  - 3.5. SILL PLATE MUST BE SEALED ON THE INSIDE WITH FOAM OR CAULK.
  - 3.6. ALL WALL PENETRATIONS TO THE EXTERIOR MUST BE SEALED WITH FOAM OR CAULK.
  - 3.7. BLOWER DOOR TESTING IS MANDATORY, NOT TO EXCEED 4 AIR CHANGES PER HOUR AT 50 PASCALS.
- DUCTS AND AIR SEALING**
  - 4.1. DUCTS MUST BE TESTED AND VERIFIED TO HAVE TOTAL LEAKAGE OF NO MORE THAN 4 FT<sup>3</sup>/MIN PER 100 SQUARE FOOT (OR 3 CFM IF AIR HANDLER IS NOT INSTALLED), EXCEPT WHERE AIR HANDLER AND ALL DUCTS ARE LOCATED INSIDE CONDITIONED SPACE. AIR HANDLERS AND FILTER BOXES MUST ALSO BE PROPERLY SEALED.
  - 4.2. HVAC AND DUCTWORK LOCATED OUTSIDE OF FIRE RATED ENVELOPE OF GARAGE.
  - 4.3. THE BUILDING ENVELOPE IS REQUIRED TO BE PROPERLY SEALED AND TESTED, AND VERIFIED AS HAVING AN AIR LEAKAGE RATE NO HIGHER THAN 3 ACH AT 0.20 INCH W.G. (50 PASCALS).
  - 4.4. SUPPLY AND RETURN DUCTS IN ATTICS SHALL BE SEALED AND INSULATED WITH R-8 WHEN DUCTS IS 3" OR GREATER, R-6 WHEN 3" OR LESS AND EXEMPT WHEN COMPLETELY INSIDE CONDITIONED SPACE.
- INSULATION:**
  - 5.1. ALL WINDOWS FENESTRATION U-FACTOR FOR CITY MUST BE 0.35, SKYLIGHT U-FACTOR 0.55 AND GLAZED FENESTRATION SHGC 0.25.
  - 5.2. CEILINGS MUST BE INSULATED WITH R-38, IF NO ATTIC SPACE R-30, THIS REDUCTION IS LIMITED TO 500 SQUARE FEET (46 M<sup>2</sup>) OR 20% OF THE TOTAL INSULATED CEILING AREA, WHICHEVER IS LESS.
  - 5.3. ATTIC ACCESS LADDERS AND OR HATCHES, MUST BE INSULATED THE SAME AS THE ATTIC AND HAVE A WEATHER SEAL.
  - 5.4. ALL EXTERIOR WALLS MUST BE INSULATED WITH R-20 CAVITY OR R-13 CAVITY WITH R-5 CONTINUOUS INSULATION OR HIGHER.
  - 5.5. CRAWL SPACE WALLS MUST BE INSULATED WITH T-5 CONTINUOUS OR R-13 CAVITY INSULATION, WITH VAPOR BARRIER OVER EXPOSED EARTH.
  - 5.6. PIER AND BEAM OR ANY OTHER RAISED FLOOR SYSTEM MUST BE INSULATED WITH R-19 INSULATION OR HIGHER.
- HVAC SYSTEMS**
  - 6.1. TEMPERATURE CONTROLS MUST BE INSTALLED, INCLUDING A PROGRAMMABLE THERMOSTAT CONTROLLING THE PRIMARY HEATING AND COOLING SYSTEM.
  - MECHANICAL SYSTEM PIPING MUST BE INSULATED TO A MINIMUM OF R-3. HOT WATER PIPING 3/4" IN DIAMETER OR LARGER AND ALL HOT WATER PIPING IN CERTAIN APPLICATIONS MUST BE INSULATED TO R-3.
  - 6.2. PIPES CARRYING FLUID OVER 104° OR BELOW 55° MUST BE INSULATED WITH R-13.
  - 6.3. LIGHTING:
    - 6.4. A MINIMUM OF 75% OF LAMPS IN PERMANENTLY INSTALLED FIXTURES MUST BE HIGH-EFFICACY AS DEFINED IN THE IECC.

## ADOPTED CITY CODES:

- 2021 International Building Code
- 2021 International Residential Code
- 2021 International Energy Conservation Code
- 2021 International Fuel Gas Code
- 2021 International Mechanical Code
- 2021 International Plumbing Code
- 2021 International Existing Building Code
- 2021 International Fire Code
- 2020 National Electrical Code



*Xavier Chapa*  
Xavier Chapa Engineering/Surveying  
Firm Number F-9156

12/16/2024

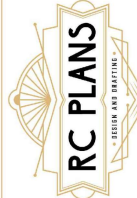

214-859-4267

THESE PLANS AND SPECIFICATIONS ARE INTENDED SOLELY FOR USE ON THE DESIGNATED SITE FOR WHICH THEY WERE CREATED. ANY REPRODUCTION OR DISTRIBUTION IS STRICTLY CONFINED TO THIS PURPOSE. REPRODUCTION, REUSE, OR DISCLOSURE—WHETHER IN FULL OR PARTIAL FORM AND BY ANY MEANS—OUTSIDE OF THIS INTENDED USE IS PROHIBITED. RC PLANS LLC RETAINS OWNERSHIP AND PROPRIETARY RIGHTS TO THE INFORMATION CONTAINED WITHIN THESE DRAWINGS AND SPECIFICATIONS.

RESIDENTIAL NEW DUPLEX CONSTRUCTION FLOOR PLAN	RC PLANS	11/18/2024	1/8" = 1'-0"
USE:	PLAN:	DRAWN BY:	DATE:
SCALE:			

ADDRESS:

117 N VAN  
BUREN  
AVE,  
DALLAS, TX  
75208

PAGE NUMBER:

03