

SITE LEGEND (PROPOSED)	
	BOUNDARY LINE
	SETBACK LINE
	VISIBILITY TRIANGLE
	BUILDING
	PROPOSED CONCRETE SIDEWALK
	NEW FENCE

SITE LEGEND (EXISTING)	
EXISTING UTILITIES	
	OVERHEAD ELECTRIC LINE
	UNDERGROUND ELECTRIC LINE
	GAS LINE
	STORM SEWER LINE
	WASTEWATER LINE
	WATER LINE
	FLOOD LIGHT
	LIGHT POLE
	POWER ANCHOR
	POWER POLE
	TRANSFORMER
	VAULT
	FIBER OPTIC BOX
	GAS METER
	GRATE INLET
	JUNCTION BOX
	STORM SEWER MANHOLE
	TELEPHONE MANHOLE
	CLEANOUT
	GREASE TRAP
	WASTEWATER MANHOLE
	FIRE DEPARTMENT CONNECTION
	FIRE HYDRANT
	IRRIGATION CONTROL VALVE
	WATER METER
	WATER VALVE
EXISTING FEATURES	
	BOUNDARY LINE
	BUILDING
	CANOPY
	CONCRETE CURB
	EDGE OF ASPHALT
	EDGE OF CONCRETE
	EXISTING FENCE
	EXISTING EASEMENT
	A/C UNIT
	BOLLARD
	SIGN
	TREE

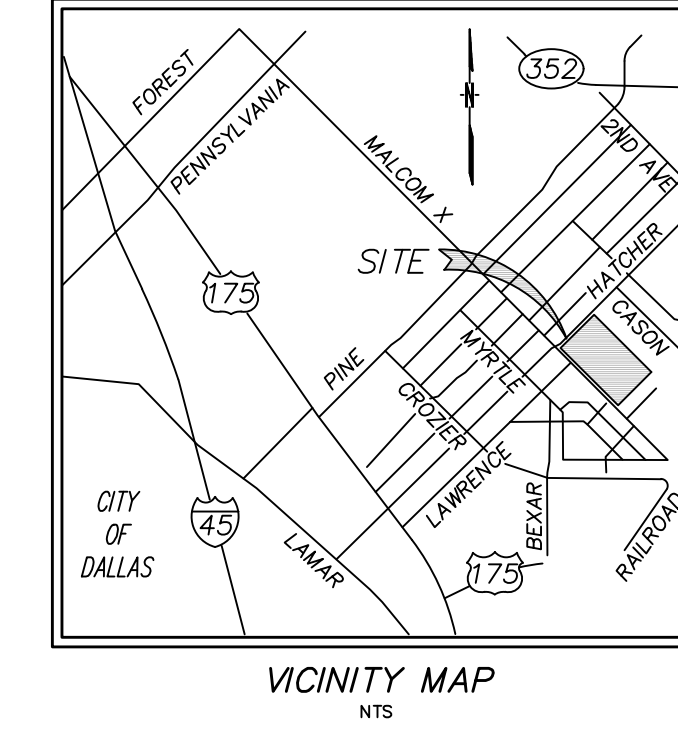

LINCOLN HIGH SCHOOL
2826 ELSIE FAYE HEGGINS STREET
CITY OF DALLAS, DALLAS COUNTY, TEXAS
CAREER INSTITUTE EAST
5000 SOUTH MALCOM X BOULEVARD
CITY OF DALLAS, DALLAS COUNTY, TEXAS
ZONING CASE NO. Z234-200(JA):
PREPARED BY: