

CITY PLAN COMMISSION**THURSDAY, April 23, 2026****FILE NUMBER:** PLAT-26-000071**SENIOR PLANNER:** Hema Sharma**LOCATION:** Pleasant Drive, south of Redkey Street**DATE FILED:** March 27, 2026**ZONING:** IM**CITY COUNCIL DISTRICT:** 5**SIZE OF REQUEST:** 1.692-acres**APPLICANT/OWNER:** Jjas Management Co**REQUEST:** An application to create one 1.692-acre lot from a tract of land in City Block 6357 on property located on Pleasant Drive, south of Redkey Street.**SUBDIVISION HISTORY:**

1. S245-029 was a request northwest of the present request to create one 4.287-acre lot from a tract of land in City Block 6362 on property located on Pleasant Drive, North of CF Hawn Freeway/ State Highway 175. The request was approved on December 5, 2024, but has not been recorded.
2. S234-094 was a request southeast of the present request to replat a 7.193-acre tract of land containing all of Lots 1 and 2 in City Block B/6357 and part of City Block 6357 to create one lot on property located on Pleasant Drive, northeast of C.F. Hawn Freeway/ US Highway No.175. The request was approved on May 2, 2024, but has not been recorded.
1. S212-045 was a request southwest of the present request to create a 2.0336-acre lot from a tract of land in City Block 6361 on property located on CF Hawn Freeway/US Highway No. 175, west of Pleasant Drive. The request was approved on December 16, 2021, but has not been recorded.

STAFF RECOMMENDATION: The request complies with the requirements of the IM Industrial Manufacturing District; therefore, staff recommends approval of the request subject to compliance with the following conditions:**General Conditions:**

1. The final plat must conform to all requirements of the Dallas Development Code, Texas Local Government Code, Texas Land Surveying Practices Act and the General Rules and Regulations of the Texas Board of Land Surveying.
2. Department of Development Services, Engineering Division must verify that the plat conforms with the water, wastewater, and easement requirements under the provisions of Chapter 49 of the Dallas City Code.
3. Compliance with all plans, contracts, ordinances, and requirements of the City of Dallas. *Section 51A-8.102(a), (b), (c), and (d)*
4. The number and location of fire hydrants must comply with the Dallas Fire Code.

5. Any new or existing structure may not extend across new property lines. *Section 51A-8.503(e)*
6. On the final plat, all easement abandonments, and ROW abandonments must be by separate instrument with the recording information shown on the face of the plat. A release from the Real Estate Division is required prior to the plat being submitted to the Chairman for signature.
7. On the final plat, include two boundary corners tagged with these coordinates: "Texas State Plane Coordinate System, North Central Zone, North American Datum of 1983 on Grid Coordinate values, No Scale and no Projection."
8. On the final plat, monument all set corners per the Monumentation Ordinance. Prior to submittal of the final plat for the Chairman's signature. The monuments must be verified by the Chief City Surveyors Office in the Public Works Department. *Section 51A-8.617*
9. Provide ALL supporting documentation (i.e. deeds, plats, ordinances, easements...etc) with a completed Final Plat Checklist to the Survey Plat Review Group (**SPRG**) with the Final Plat Submittal **after** City Plan Commission Approval.
10. Prior to the final plat, submit a tree survey to the Arborist. A release from the arborist is required prior to an early release request or the recordation of the plat, whichever occurs first.
11. The number of lots permitted by this plat is one.

Paving & Drainage Conditions:

12. Submit a full set of Civil Engineering Plans (drainage, paving, street signage/markings/lighting) prepared per City Standards by a licensed (TX) Professional Engineer to Engineering Division in Room 200, Oak Cliff Municipal Center (i.e. 311T/DP). Additions and alterations to the public infrastructure require approval and may require private development contracts with bonds. 51A-8.102 (c); 8.601(b)(4),(5),(6),(7),(8),(9)
13. Detention may be required if the capacity of available outfall is not adequate to carry the developed runoff. Section 51A-8.611(c).
14. "Lot-to-Lot drainage will not be allowed without proper City of Dallas Engineering Division approval" (Note must be on the Plat). 51A 8.611(e)

Right-of way Requirements Conditions:

15. Must coordinate with Transportation Department for any traffic signal requirements that are deemed necessary for improving pedestrian accessibility and safety related to site development (Contact Srinivasa Veeramallu with Traffic Signals). 51A-8.606, 51A-8.608.
16. Needs to be coordinated with DART.
17. Must coordinate with Transportation Department for any traffic signal requirements that are deemed necessary for improving pedestrian accessibility

and safety related to site development (Contact Srinivasa Veeramallu with Traffic Signals). *51A-8.606, 51A-8.608*

Flood Plain Conditions:

18. On the final plat, determine the 100-year water surface elevation across this addition.
19. On the final plat, dedicate floodway easement, floodway management area or floodway easement (within common area), with the appropriate easement statement included on the face of the Plat. *51A 8.611(d); DWU Floodplain Management; Drainage Design Manual Addendum V*
20. On the final plat, include additional paragraph in Owner's Certificate (pertaining to the floodplain). *51A 8.611(d); DWU Floodplain Management; Drainage Design Manual Addendum V*
21. On the final plat, specify minimum fill and minimum finished floor elevations. *Section 51A-8.611(d), Trinity Watershed Management.*
22. On the final plat, show the natural channel set back from the crest of the natural channel. *Section 51A-8.611(d), Trinity Watershed Management.*
23. Prior to submission of the final plat, set floodway monument markers and provide documentation that the monuments have been set. *Section 51A-8.617(d)(1), (2), (3), and (4)*
24. Provide information regarding Fill Permit or Floodplain Alteration Permit if such permit is applied for.

Survey (SPRG) Conditions:

25. Prior to final plat, submit a completed final plat checklist and all supporting documents.
26. Provide State Plane Coordinates for at least two property corners. Coordinates shall include northing and easting values and be clearly labeled.

Dallas Water Utilities Conditions:

27. Additional design information is required for assessment. Site plan must be submitted showing proposed development, building finished floor elevation, development, existing mains – including downstream manhole, and proposed water and wastewater service locations. Submit water/wastewater engineering plans to 320 E. Jefferson Blvd., Room 200, Attention: Water and Wastewater Engineering.

Street Name/ GIS, Lot & Block Conditions:

28. On the final plat, label "Glenview Street" on plat drawing.
29. On the final plat, label "Bridges Street" on plat drawing.
30. On the final plat, identify the property as Lot 1 in City Block C/6357.

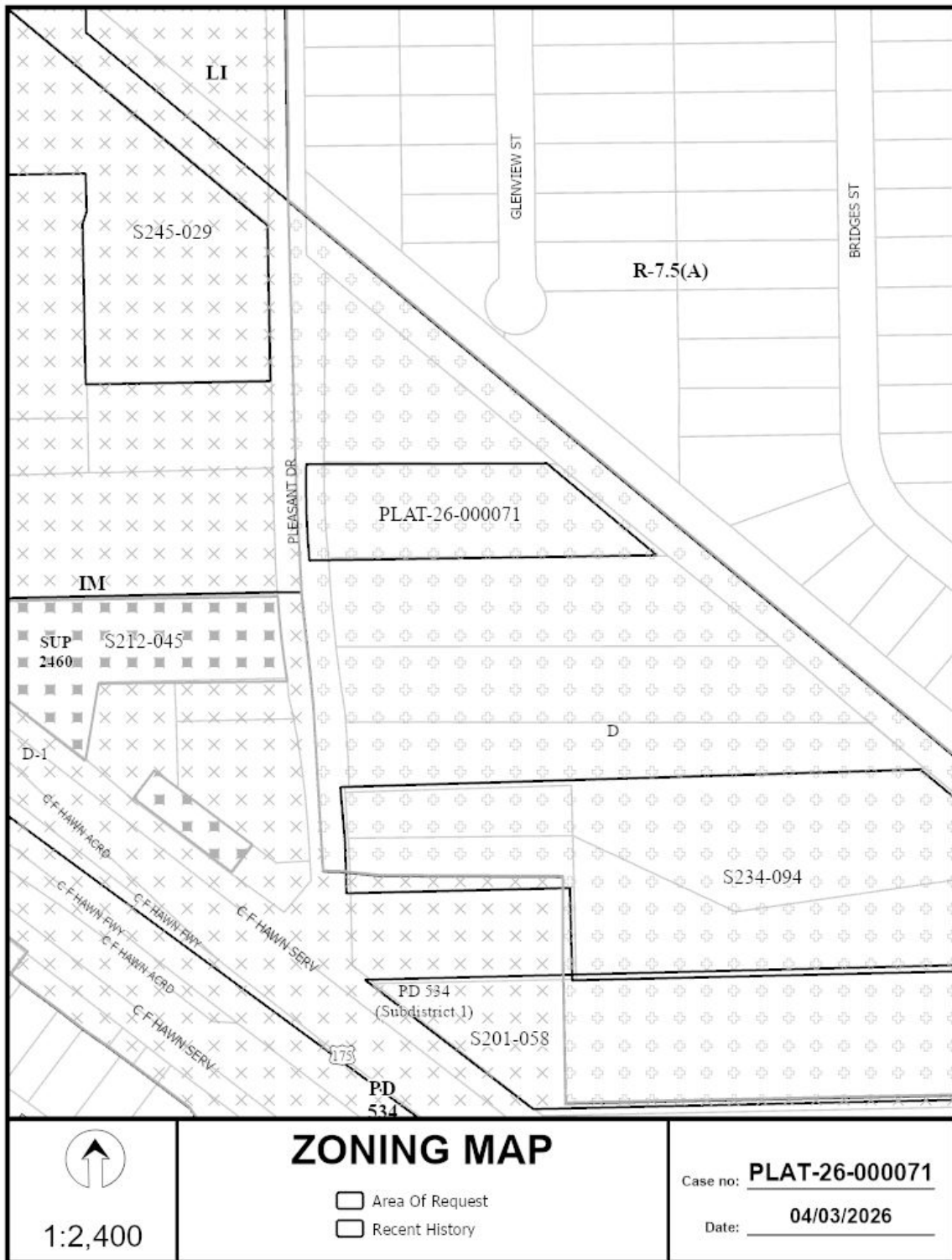



 1:2,400	<h2>AERIAL MAP</h2> <ul style="list-style-type: none"> <input type="checkbox"/> Area Of Request <input type="checkbox"/> Recent History 	Case no: PLAT-26-000071 Date: 04/03/2026
--	---	---

