



LANDMARK COMMISSION

MAY 4, 2026

FILE NUMBER: COA-26-000136
LOCATION: 702 Ross Ave.
STRUCTURE: Contributing
COUNCIL DISTRICT: 14
ZONING: CA-1(A)

PLANNER: Rhonda Dunn, Ph.D.
DATE FILED: April 15, 2026
DISTRICT: West End Historic District
MAPSCO: 45-K
CENSUS TRACT: 0021.00

APPLICANT: Ruvalcaba, Rene

REPRESENTATIVE: N/A

OWNER: YO RANCH RESTAURANT NO 1 LTD

REQUEST(S)

A Certificate of Appropriateness to install outdoor lighting (programmable string lights) around the top perimeter of the main building.

STAFF RECOMMENDATION(S)

That the request for a Certificate of Appropriateness to install outdoor lighting (programmable string lights) around the top perimeter of the main building be approved with conditions in accordance with drawings and specifications submitted April 15, 2026 with the following conditions: that all attachments for lighting fixtures, conduit, wiring, or mounting hardware be made only through mortar joints and not into historic brick; that programmable string lights be installed below the parapet and any ornamental brick detailing at the top of the main building; and that color temperature and brightness shall be kept low intensity -- using a neutral, low intensity white light is preferred. Implementation of the recommended conditions would allow the proposed work to be consistent with preservation criterion Section 5.7 pertaining to façade appearance; the standards in City Code Section 51A-4.501(g)(6)(C)(i) for contributing structures; and the Secretary of the Interior's Guidelines for Setting (District/Neighborhood).

TASK FORCE RECOMMENDATION(S)

That the request for a Certificate of Appropriateness to install outdoor lighting (programmable string lights) around the top perimeter of the main building be denied without prejudice. The applicant has not provided enough information.

BACKGROUND / HISTORY:

The subject property at 702 Ross Avenue is a contributing one-story masonry commercial building located within the West End Historic District. Historically, the building has served various commercial and institutional uses consistent with the district's early-20th-century warehouse and rail-oriented development character. The existing structure retains its brick façade, parapet, and storefront configuration, which contributes to the architectural cohesion defined in Section 5 of the West End Preservation Criteria.

The current request does not involve additions or major alterations to the building. Rather, the applicant proposes the installation of Trimlight permanent, programmable exterior lighting along the upper perimeter of the building. According to the manufacturer's documentation, Trimlight is a low-profile LED lighting system designed to blend with existing architectural features in daylight conditions while providing programmable illumination after dark. The product is commercially marketed for use on historic, commercial, and civic buildings due to its discreet mounting channels, small LED size, and adaptability to architectural lines.

There are no previous applications for Certificates of Appropriateness (or Demolition) filed for this property that are pertinent to this CA.

RELEVANT PRESERVATION CRITERIA:

West End Historic District (H/2), Ordinance No.: 22158

SECTION 5: CONSTRUCTION AND RENOVATION CRITERIA.

5.7 Facade appearance. No solid brick facade may face a public right-of-way. The design of a facade must convey the district's cohesiveness. The design, materials, and color must be indicative of warehouse or railroad buildings at the beginning of the twentieth century.

RELEVANT SECRETARY OF THE INTERIOR'S STANDARDS/GUIDELINES FOR THE TREATMENT OF HISTORIC PROPERTIES:

Standards for Rehabilitation

- 3. Each property shall be recognized as a physical record of its time, place, and use. Changes that create a false sense of historical development, such as adding conjectural features or architectural elements from other buildings, shall not be undertaken.*

Guidelines for Setting (District / Neighborhood)

- **Recommended:** Identifying, retaining, and preserving building and landscape features that are important in defining the overall historic character of the setting. Such features can include circulation systems, such as roads and streets; furnishings and fixtures, such as light posts or benches; vegetation, gardens and*

yards; adjacent open space, such as fields, parks, commons, or woodlands; and important views or visual relationships.

- **Not Recommended:** *Introducing a new building or landscape feature that is visually or otherwise incompatible with the setting's historic character (e.g., replacing low metal fencing with a high wood fence).*

RELEVANT DALLAS CITY CODE:

Section 51A-4.501. Historic Overlay District

- (g) Certificate of Appropriateness.
- (6) Standard certificate of appropriateness review procedure.
 - (C) Standard for approval. The landmark commission must grant the application if it determines that:
 - (i) for contributing structures:
 - (aa) *the proposed work is consistent with the regulations contained in this section and the preservation criteria contained in the historic overlay district ordinance.*
 - (bb) *the proposed work will not have an adverse effect on the architectural features of the structure.*
 - (cc) *the proposed work will not have an adverse effect on the historic overlay district; and*
 - (dd) *the proposed work will not have an adverse effect on the future preservation, maintenance and use of the structure or the historic overlay district.*

PROJECT DESCRIPTION & ANALYSIS

The applicant requests approval to install Trimlight permanent outdoor lighting along the top perimeter/parapet line of the building at 702 Ross Avenue. Trimlight systems consist of small, energy-efficient RGB LED bulbs housed in an aluminum mounting channel designed to follow existing architectural edges. The system includes fully programmable lighting patterns, colors, and calendar-based scheduling controlled via the cloud-based Trimlight Edge app.

Description of Lighting System

According to the manufacturer's technical specifications, the proposed lighting uses commercial-grade LEDs with the following traits:

- 3 RGB LEDs per bulb, spaced 12" on center (commercial system)
- 50,000+ hour lifespan
- Low-profile aluminum channel designed to be visually unobtrusive during daytime
- IP68 waterproof rating
- 12V system, 1W per bulb, with optional higher-visibility commercial bulb variants
- Cloud-based control, remote access, programmable schedules, and voice-assistant compatibility

The system is marketed for architectural enhancement, branding, seasonal lighting, and increased nighttime visibility, all while minimizing permanent visual impact due to its concealed daytime appearance.

Compatibility with the West End Historic District

The West End Preservation Criteria emphasize façade appearance (Section 5.7), requiring design features to reinforce the district’s early 20th-century warehouse character. Trimlight’s low-profile installation method is designed to avoid altering façade geometry or obscuring architectural details; when not illuminated, the system is intended to remain minimally visible.

Because Trimlight channels are mounted flush to existing eaves or parapets, the installation—if limited to mortar joints, as recommended in staff conditions—does not visually disrupt the masonry or create conjectural historic elements. Furthermore, the ability to restrict lighting to low-intensity neutral whites allows the system to align with preservation criteria emphasizing subtlety and architectural reinforcement.

Impact Assessment (Following Staff Conditions)

- **Architectural Features:** The system attaches through mortar joints (per staff conditions) and uses concealed channels, minimizing visual impact on contributing brick masonry.
- **District Character:** When toned to low-intensity white or simple static coloration, the lighting supports nighttime visibility without detracting from historic district cohesion.
- **Reversibility:** Trimlight’s channel-based attachment allows future removal with minimal repair, consistent with Secretary of the Interior standards emphasizing reversibility.
- **Functionality & Safety:** Commercial LED lighting enhances evening visibility and pedestrian safety, aligning with Trimlight documentation stating improved ambiance and customer experience.

Conclusion

The proposed Trimlight installation constitutes a reversible, low-impact lighting enhancement intended to emphasize building edges without obscuring or altering historic material. When installed below parapet ornamentation, attached through mortar joints, and operated with low-intensity lighting, the project is consistent with:

- West End Preservation Criteria Section 5.7 (Façade Appearance)
- City Code Section 51A-4.501(g)(6)(C) for contributing structures
- Secretary of the Interior’s Guidelines for Setting, emphasizing compatibility and non-intrusive improvements

Overall, the proposed work will **not** have an adverse effect on the architectural features of the structure; the historic overlay district; and the future preservation, maintenance and use of the structure or the historic overlay district.

SITE MAP
702 Ross Ave.



The yellow rectangle highlights 702 Ross Ave. The green shading depicts West End Historic District coverage. *Basemap Source: Google Earth*

CURRENT PHOTOS
702 Ross Ave.



Subject property. North (front) elevation, Ross Avenue frontage (depicts storefront(s) and awnings). Source: Google Maps -- Street View (Feb. 2025).



Subject property. East (left) elevation depicts a former shared/party wall. Source: Google Maps - Street View (Feb. 2025).



Subject property. West (right) elevation illustrates former loading area to the rear. Source: Google Maps -- Street View (Feb. 2025).



Subject property. At the intersection of Ross Ave. and Market St. Source: Google Maps -- Street View (Feb. 2025).

ATTACHMENTS:

- **Task Force Recommendation Form**
- **Certificate of Appropriateness Application**

TASK FORCE COURTESY REVIEW REPORT
CENTRAL BUSINESS DISTRICT/WEST END/INDIVIDUAL SITES

DATE: 04/08/2026

TIME: 3:00 pm

MEETING PLACE: Virtual Meeting / 2922 Swiss Avenue, "Wilson House"

Applicant Name: Rene Ruvalcaba

Address: 702 Ross Ave – West End Historic District

Date of CR/CA/CD Request: 03/23/2026

RECOMMENDATION:

Approve Approve w/ conditions Deny Deny w/o prejudice

Recommendation / comments/ basis:

Deny without Prejudice due to lack of information

Task force members present

Gary C. Coffman (Chair) Justin Curtsinger (Vice Chair) Jay Firsching
 Morgan Harrison James Adams John Johnson
 Carolina Pace

Ex Officio staff members Present Rhonda Dunn, Ph.D.

Simply Majority Quorum: yes no (four makes a quorum)

Maker: Justin Curtsinger

2nd: Morgan Harrison

Task Force members in favor: 5

Task Force members opposed: 0

Basis for opposition:

CHAIR, Task Force: Gary C. Coffman

Date: 04/08/2026

The task force recommendation will be reviewed by the landmark commission in the City Council chamber, Room 6ES, starting at 9:30 with a staff briefing.

The Landmark Commission public hearing begins at 1:00 pm in Room 6ES, the Council Chamber, which allows the applicant and citizens to provide public comment(s).



TRIMLIGHT METROPLEX

Project: YO Ranch Restaurant
Address: 702 Ross Ave, Dallas, TX
Sheet: A5.1 – Trimlight Installation Detail

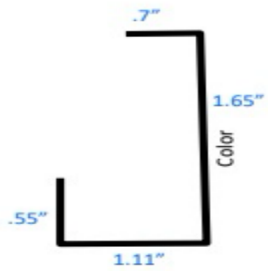

Snap in Channel

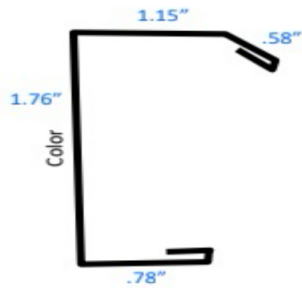

Snap in Base

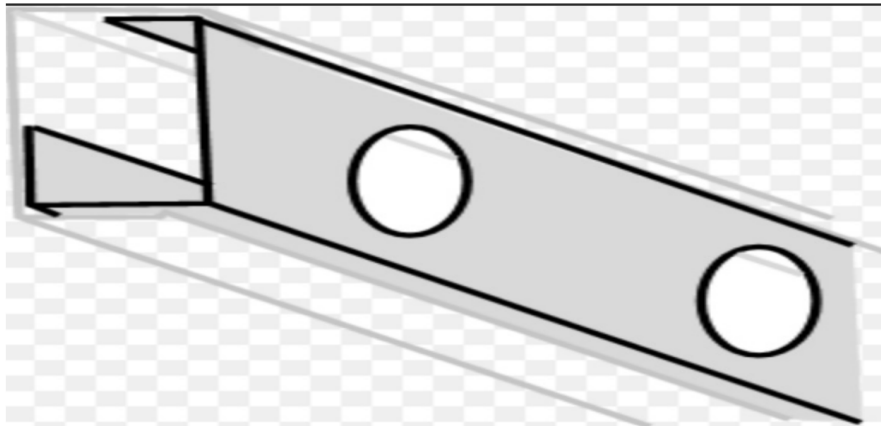

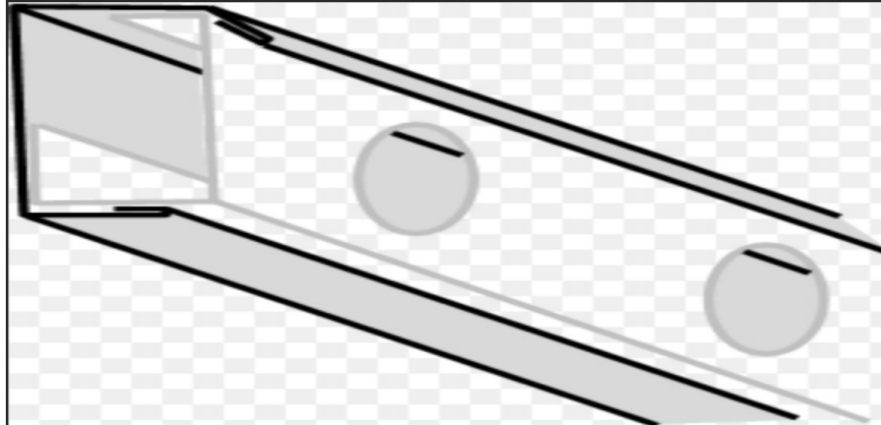

CATEGORY	SPECIFICATION
Snap-In Base Height	1.76 inches
Snap-In Channel Height	1.65 inches (LED face)
Base Mounting Leg	0.78 inches (field-drill zone)
Overall Projection	1-7/8 inches from face of brick
Section Length	89 inches typical
LED Spacing	12 inches OC
Weight	2.5 lbs per section (≈0.34 lbs/ft)
Fasteners	#10 x 1-1/2" Stainless Steel Screws
Anchors	3/16" Plastic Concrete Anchors
Fastener Spacing	16" OC (min. 3 fasteners per section)

INSTALLATION – BRICK MORTAR MOUNT

- Mount snap-in base directly to mortar joint (brick behind base).
- Field-drill base along 0.78" lower leg using 3/16" masonry bit.
- Install 3/16" plastic anchors flush with mortar.
- Fasten using #10 x 1-1/2" stainless screws @ 16" OC.
- Minimum (3) fasteners per 89" section.
- Install wiring prior to snapping channel.
- Snap channel onto base after alignment.
- LED mounted on 1.65" face, spacing 12" OC, light projects horizontally outward.

POWER CONNECTION – INTERIOR OUTLET FEED

- Trimlight power supply/controller to be plugged into interior 120V receptacle.
- Route low-voltage wiring to exterior start of channel run.
- Penetrate wall at mortar joint; install grommet and seal with exterior silicone.
- Provide drip loop at exterior.
- Interior receptacle to be GFCI protected if required.

TRIMLIGHT COMMERCIAL BULB

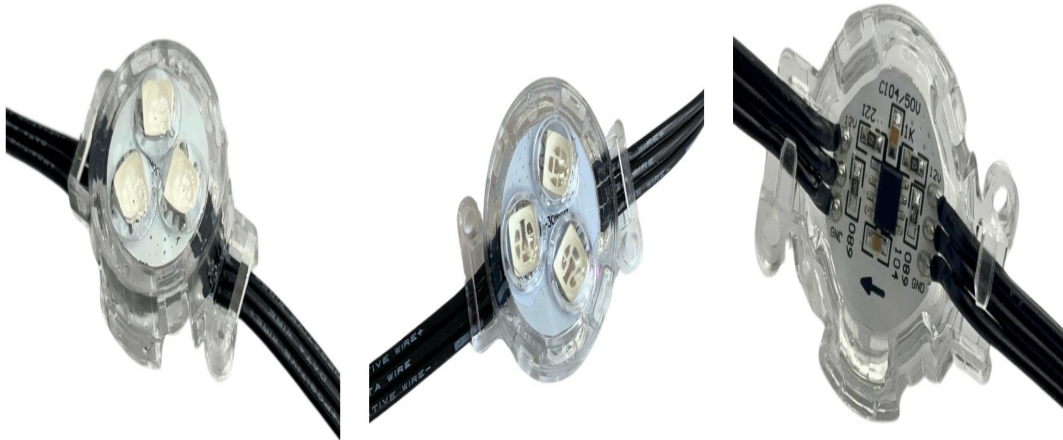

- LEDs: 3 per bulb
- Lifespan: 50,000+ hours
- Spacing: 12" OC
- Colors: RGB
- Control Method: Edge App, Voice Control
- Voice Control: Google Home, Alexa
- Waterproof: IP68
- Voltage: 12V
- Wattage: 1W per bulb



Y
STEAKHOUSE

STOP

PRIME AGED BEEF

SEAFOOD

GAME

BUFFALO

LOBBY



Y
STEAKHOUSE

STOP

PRIME AGED BEEF

SEAFOOD

GAME

BUFFALO

LOBBY



Y
STEAKHOUSE

STOP

PRIME AGED BEEF

SEAFOOD

GAME

BUFFALO

LOBBY



Y.O. RANCH STEAKHOUSE

Y.O.
STEAKHOUSE

STEAKS

SEAFOOD

WILD GAME

PRIVATE DINING



Russet Red



BUSINESS LIGHTING

Our commercial lighting bulb is highly favored by businesses and trusted by renowned brands with numerous installations. Crafted for commercial settings, it offers unmatched brightness and energy efficiency, ideal for drawing more customers to your establishment.

Utilizing cutting-edge LED technology, our bulbs reduce electricity costs while providing brilliant illumination. Perfect for retail stores, offices, and outdoor signs, Trimlight's Commercial Bulb ensures reliable, high-quality light to enhance visibility and attract customers.



**HIGH-PERFORMANCE LED
COMMERCIAL BULBS.**

*FOR A COMPLETE LIST OF SPECS, GO TO OUR SPEC SHEET ON PAGE 20.



COA-26-000136

ACCENT / SECURITY LIGHTING



-19-

ATTRACT CUSTOMERS



GROUPING CONTROL



ACCESS FROM ANYWHERE

TRIMLIGHT COMMERCIAL

- LEDs: 3
- Lifespan of Bulb: 50,000+ hours
- Spacing: 12"
- Colors: RGB
- Control Method: Edge APP, Voice Control
- Voice Control: Google Home, Alexa
- Waterproof: IP68
- Voltage: 12V
- Wattage: 1W per bulb
- Lumens: 30-60 (depends on method of measurement)
- Dances to Music: Auxiliary port to speaker
- Customization: Customizable color patterns and low profile channel to match your brand
- Grouping: Can control multiple business locations from one central location and from anywhere in the world



TRIMLIGHT

PERMANENT, PROGRAMMABLE LIGHTING
FOR YOUR **BUSINESS**



REQUEST ESTIMATE





WHY TRIMLIGHT IS THE BEST CHOICE FOR YOUR BUSINESS

With Trimlight's innovative and reliable permanent outdoor lighting solutions, business owners can effortlessly bring in more customers year-round. Our state-of-the-art technology and customizable options make it simple to create the perfect color matching for your business.

You can enjoy stunning outdoor lighting that not only adds curb appeal to your business, but also provides a sense of warmth and security. Allow the experts in outdoor permanent lighting to handle your project with our comprehensive start-to-finish process, complete with an unbeatable lifetime product warranty. Sit back, relax, and enjoy as your business shines as a beacon of light in your neighborhood.



CONTENTS

- 3. Installation Experts
- 4. The Trimlight Difference
- 5. Hidden In The Day
- 6. Choosing Trimlight Is Easy
- 7. Cutting-Edge App
- 8. Benefits
- 10. Commercial Bulb
- 12. Globe Lights
- 14. Trimlight 3L For Businesses
- 16. Municipal Lights
- 18. Brands
- 19. FAQ
- 20. Colors To Match

3 Easy Steps To Get Trimlight



Get Started

Scan the QR Code above to **request a free no-obligation estimate.**



Professionally Installed

A Trimlight installer will **professionally install** your lights on your business.



Enjoy Your System

Enjoy the amazing benefits of your new Trimlight system with our industry leading app.





**INSTALLATION EXPERTS,
TRAINING, DEALER NETWORK**

INSTALLED & SERVICED BY FACTORY- TRAINED TECHNICIANS

Trimlight installers blend creativity with technical expertise to craft unique lighting designs for every business. They know that lighting is more than just visibility—it's about setting the perfect atmosphere to attract more customers. From accentuating architectural features to creating inviting outdoor spaces, they skillfully combine innovation and artistry to bring your vision to life.

As artisans of light, Trimlight installers don't just install—they design captivating experiences. Their passion for detail and commitment to excellence transform outdoor environments into welcoming, dynamic spaces that enhance both safety and style.



Trimlight is proud to have hundreds of dealerships across North America. A local, authorized, and factory-trained technician will guide you seamlessly through the Trimlight estimate and install process to deliver an amazing permanent lighting system.



THE TRIMLIGHT DIFFERENCE

Trimlight is **THE ORIGINAL** pioneer of permanent holiday lighting. Trimlight offers the widest range of year-round lighting solutions in the industry: **COMMERCIAL LIGHTING, DOWNLIGHTS, GLOBE LIGHTS, RESIDENTIAL LIGHTING**, and more innovations to come!



SCHEDULED ILLUMINATION

With Trimlight's innovative technology, programming your lighting system to **accommodate your business hours, seasonal changes, or daylight savings adjustments** becomes manageable. The **scheduling** feature ensures that your establishment is illuminated precisely when needed.



CELEBRATE THE HOLIDAYS

During holidays, Trimlight systems enable you to **celebrate with appropriate festive colors** and animations, adding to the communal spirit. This capability ensures your business **remains relevant and visually appealing throughout the year**, fostering a sense of anticipation among your customers.



ACCESS FROM ANYWHERE IN THE WORLD

With Trimlight's advanced technology, you can **control your business lighting from anywhere in the world**. Whether you're on-site, traveling, or managing multiple locations, the Trimlight app lets you adjust schedules, colors, and patterns with ease for multiple business locations.



ATTRACT MORE CUSTOMERS

Installing Trimlight's permanent outdoor LED lights can be a **game-changer for businesses**. With the ability to customize colors and patterns, you can create a unique and eye-catching display that showcases your brand in a powerful way. This is especially important in today's competitive market, where businesses are constantly vying for attention.



HIDDEN IN THE DAY



BEAUTIFUL AT NIGHT



CUSTOMER SERVICE

5-STAR TRIM LIGHTING EXPERTS!



Trusted Nationwide: Thousands of glowing reviews for our dealers!

PROFESSIONAL INSTALLATION



Our **professional estimators and expert installers** are with you every step of the way!

NATION'S BEST WARRANTY



We offer the **best warranty** in the business, by offering a lifetime warranty on all parts.

CHOOSING TRIMLIGHT IS EASY

PEACE OF MIND COMES STANDARD

At Trimlight, our foundation is built on a commitment to excellence and a dedication to providing top-quality products that stand the test of time. While some may claim longevity, we go above and beyond by offering a lifetime product warranty to guarantee the durability and reliability of our lights. From the initial sales process to installation and ongoing service, our dealers take full ownership of every step to ensure a seamless and 5-star experience for our customers. With Trimlight, you can trust in our unwavering accountability and commitment to delivering exceptional lighting solutions that exceed expectations.

Experience firsthand the impact of our high standards for quality and service on your permanent outdoor lighting. Transforming your business has never been simpler with Trimlight by your side.

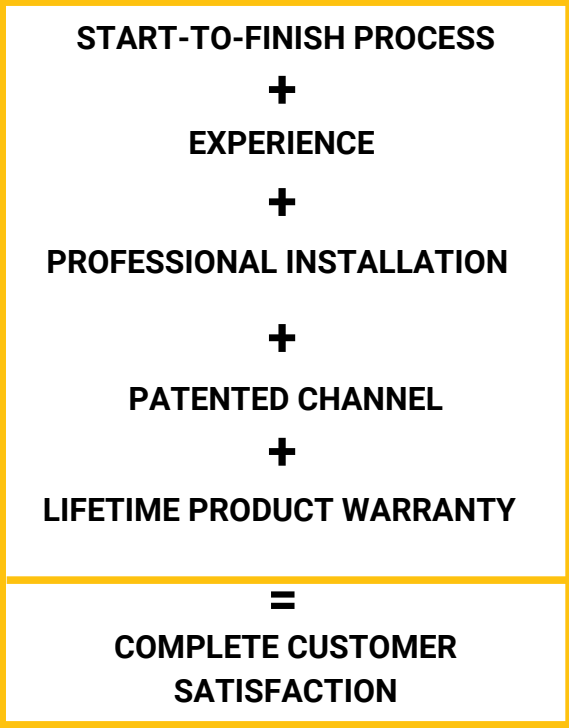

ATTRACT MORE CUSTOMERS

CUTTING-EDGE APP

TRIMLIGHT EDGE

With the Trimlight Edge app, users can **unlock the full potential** of your outdoor lighting system, transforming your spaces into dynamic, vibrant environments that captivate and inspire. With **millions of colors and thousands of patterns**, the Trimlight Edge app puts the power of lighting control in the palm of your hand, enhancing every moment with unparalleled ease and convenience.



BENEFITS

- Ability to **customize millions of colors**
- **180 preset** color movement patterns
- **20 motions** that can be added to any pattern
- Set it and forget it with **easy timer** and calendar programming
- Program your lighting system from **anywhere in the world**
- **Group multiple business locations** so they're all on brand
- Special effects such as **lightning** and **snowflake**

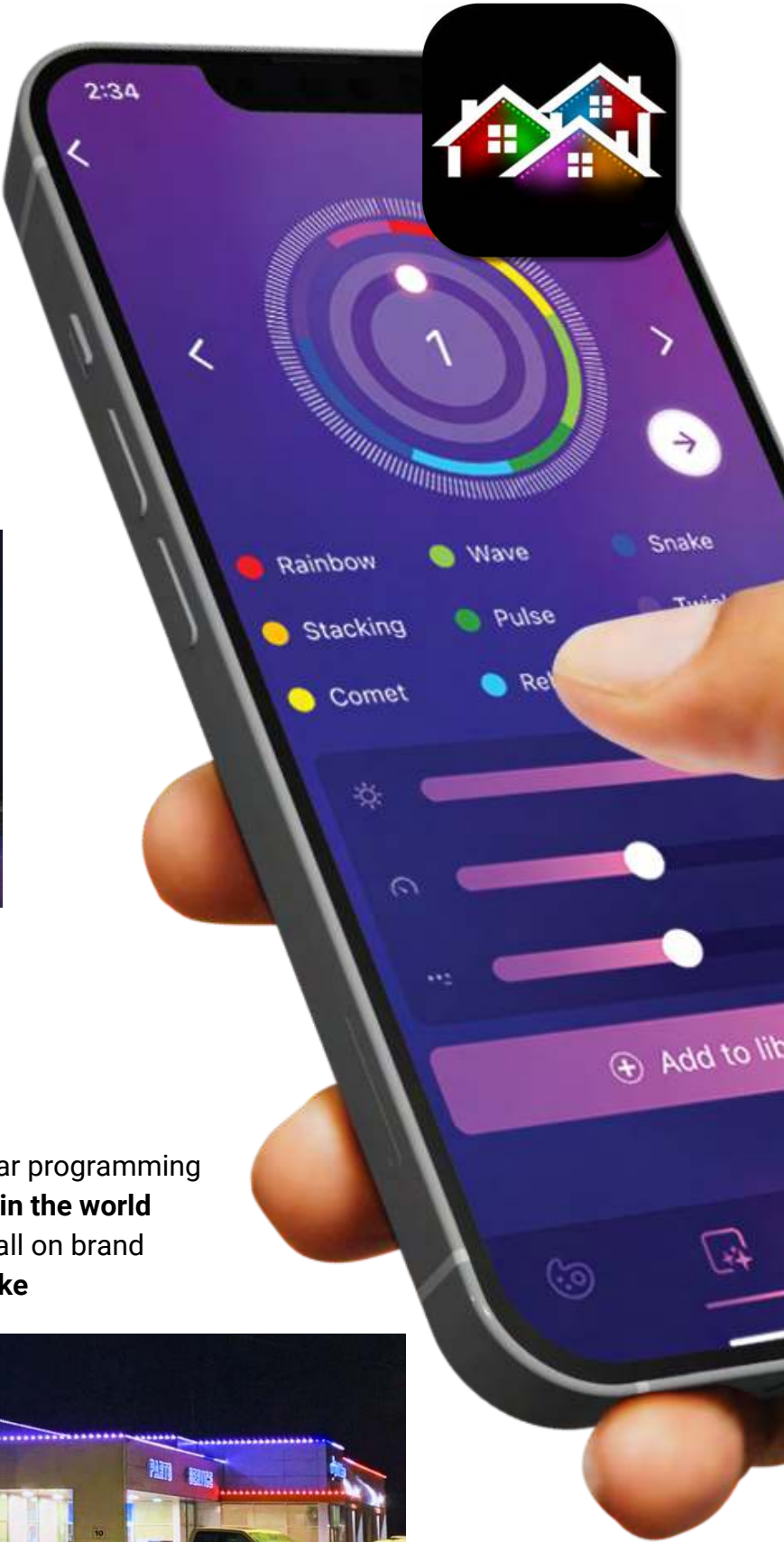

BENEFITS OF COMMERCIAL LIGHTING

AS A BUSINESS OWNER, YOU'RE ALWAYS LOOKING FOR WAYS TO IMPROVE YOUR BUSINESSES IMAGE AND BRANDING.

Explore four reasons why permanent commercial lighting might be the perfect solution for you.

ENHANCED VISIBILITY

According to Exploding Topics, **55%** of a brand's first impressions are visible.

With our customizable permanent outdoor LED lights, you can enhance your building's visibility and ensure it **stands out from the competition**. Our bright and vibrant lighting solutions extend your brand presence into the night, ensuring your premises are always visible.

Whether you're aiming to attract more foot traffic or simply want to make a memorable impact, our lighting solutions are designed to **highlight your business's unique identity**. By choosing colors and patterns that align with your brand, you can create a cohesive look that resonates with your audience and leaves a lasting impression.

BRAND CONSISTENCY

71% of consumers say they're more likely to buy a product or service from a brand they recognized, which can help save money, build your brand, and increase trust.

Achieve seamless branding across all your business locations with our LED permanent lights. Trimlight's programmable lighting patterns make it effortless to create a consistent look and feel, while allowing you to easily tune into your unique brand colors at every site.

This consistency not only **reinforces your brand identity** but also creates a **unified experience** for customers, no matter where they encounter your business.



ENGAGEMENT FROM CUSTOMERS

A study by Salesforce found **80%** of customers believe experiences provided by a company are as meaningful as their products and services

Our lighting displays go beyond basic illumination, **engaging your customers with dynamic, changeable patterns that reflect seasons, holidays, or special events related to your business**. This interactive engagement fosters a stronger connection with your customers.

By using our **customizable lighting solutions**, you can create memorable experiences that resonate with your audience, turning casual visitors into loyal customers.

NON-VERBAL COMMUNICATION

In a world where **words are not always spoken**, we often rely on what we see to understand a message. Trimlight's lighting systems **speak for your business without using a single word**. Through colors and patterns, these lights tell a story about who you are and what you represent.

The power of non-verbal communication through lighting can be a game-changer for your brand. By strategically choosing color schemes and patterns, you can **subtly convey your brand's values and personality to passersby**.

For example, a brightly lit building with bold colors may signify a lively and energetic business, while softer tones convey elegance.

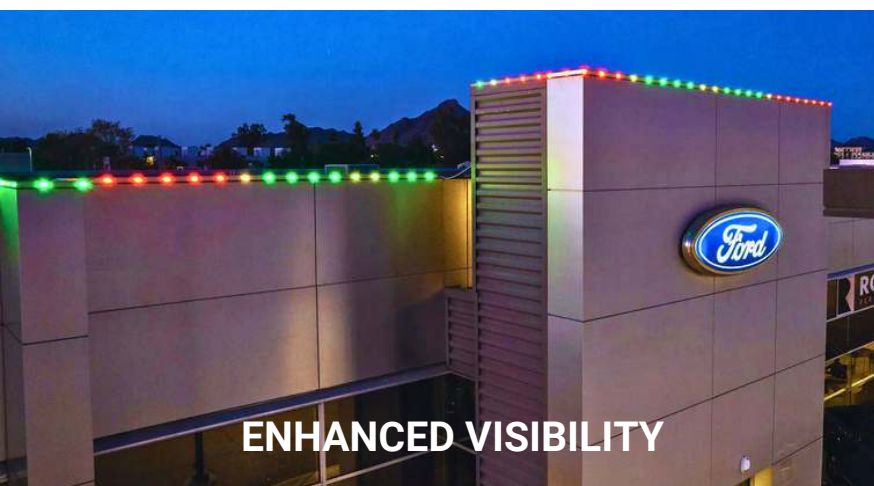

ENHANCED VISIBILITY



BRAND CONSISTENCY

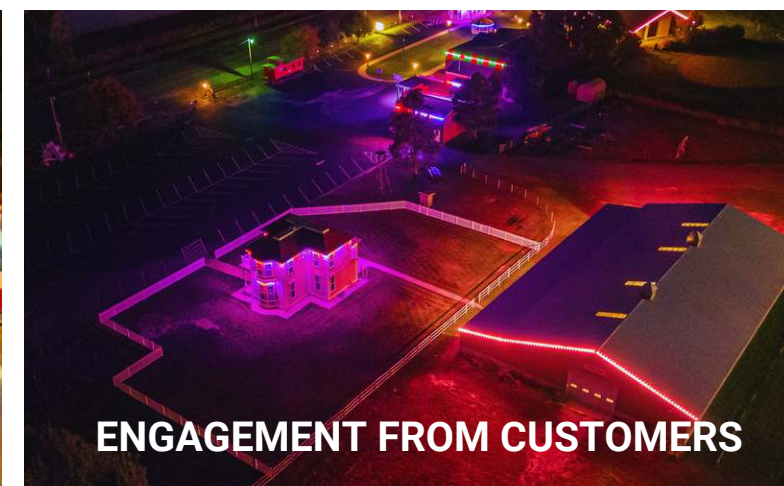

ENGAGEMENT FROM CUSTOMERS



NON-VERBAL COMMUNICATION

TRIMLIGHT COMMERCIAL BULB

Our commercial lighting bulb is highly favored by businesses and trusted by renowned brands with thousands of installations. Crafted for commercial settings, it offers unmatched brightness and energy efficiency, ideal for drawing more customers to your establishment.

Utilizing cutting-edge LED technology, our bulbs reduce electricity costs while providing brilliant illumination. Perfect for retail stores, offices, and outdoor signs, Trimlight's Commercial Bulb ensures reliable, high-quality light to enhance visibility.



**HIGH-PERFORMANCE LED
COMMERCIAL BULBS.**



MATCH YOUR BRAND



ACCENT / SECURITY LIGHTING



ATTRACT CUSTOMERS



GROUPING CONTROL



ACCESS FROM ANYWHERE

GLOBE LIGHTS FOR YOUR BUSINESS

Trimlight Globe Lights are the ideal solution for businesses looking to enhance their outdoor spaces with stylish, functional lighting. Perfect for illuminating patios, pool sides, courtyards, and event areas. Our globe lights create a welcoming atmosphere that draws customers in and elevates their experience.

Trimlight Globe Lights offer a sophisticated aesthetic that enhances any gathering, making a memorable impression on guests. The durable, weather-resistant design is built to last, providing businesses with reliable, year-round lighting that requires minimal maintenance. With customizable color and brightness options, businesses can easily adjust the lighting to suit any occasion or branding theme, adding ambiance that aligns with their unique style and setting. By investing in Trimlight Globe Lights, companies can create a stunning, professional look that stands out and keeps patrons coming back for the ambiance they love.



GREAT ADDITION TO WEDDINGS, BARS, RESTAURANTS, POOLS, AWNINGS, AND MORE!



PERFECT FOR EVENTS

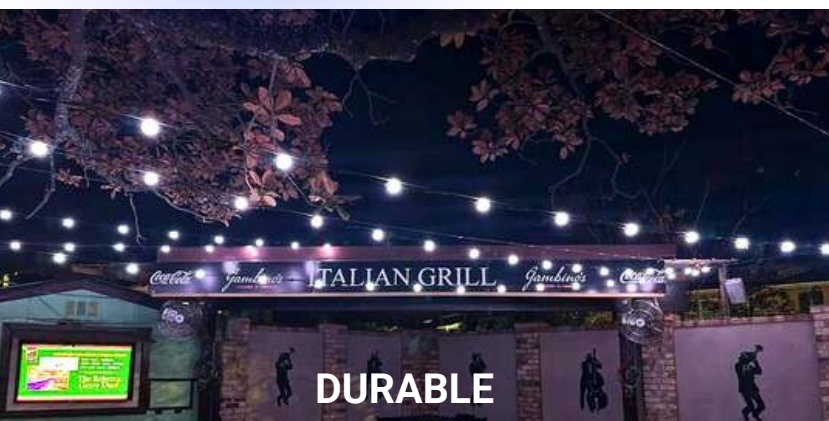

DURABLE



WEATHER-RESISTANT



VIBRANT



50,000+ HOUR LIFESPAN

TRIMLIGHT 3L FOR YOUR BUSINESS

Experience the ultimate in outdoor all-occasion lighting with Trimlight 3L, our latest innovation that will illuminate your business like never before. With **three powerful LEDs**, this permanent lighting system delivers **unparalleled brightness at night**. Not only does Trimlight 3L retain the features our customers adore, but it also boasts a timeless holiday lighting aesthetic that enhances visibility of your business from more angles after dark.



3 LEDs IN ONE BULB!



WE ABSOLUTELY LOVE TRIMLIGHT! IT'S BEEN A GAME-CHANGER FOR US, CREATING A BEAUTIFUL AND INVITING ATMOSPHERE THAT OUR CUSTOMERS RAVE ABOUT. WE CONSTANTLY GET POSITIVE FEEDBACK ABOUT THE LIGHTING, AND THE ABILITY TO ADJUST IT BASED ON TIME, SEASON, OR SPECIAL EVENTS HAS BEEN INCREDIBLY CONVENIENT. IF YOU'RE LOOKING TO ELEVATE YOUR BUSINESS'S LOOK, TRIMLIGHT IS THE BEST INVESTMENT YOU CAN MAKE!

JAKE, EVENT MANAGER



HOLIDAY LIGHTING



HIGHLIGHTING LOGOS OR SIGNAGE



MATCH YOUR BRAND



GROUPING CONTROL



DANCES TO MUSIC

MUNICIPAL LIGHTS

Municipalities can utilize Trimlight to highlight architectural features, celebrate various holidays, support community events, or enhance civic pride through captivating color displays. The system's versatility means that cities can easily switch between themes and color schemes to match seasonal celebrations or special occasions, fostering a sense of community and engagement among residents. This is made possible through a **smart, user-friendly system** that eliminates the need for seasonal installations or cumbersome upkeep, allowing local governments to focus their resources on other important initiatives.

Moreover, the long-lasting and energy-efficient design of Trimlight significantly reduces operating costs and maintenance time. This not only makes it a cost-effective solution, but also means that the system can pay for itself over just a few years. By minimizing energy consumption while maximizing visual impact, Trimlight aligns with sustainable practices that many municipalities are striving to achieve.

For cities and government facilities looking to create an inviting, well-lit environment that resonates with community spirit, Trimlight offers a professional, visually striking, and highly functional commercial lighting bulb design. This installation benefits not only the facilities themselves, but also the public, as it **enhances safety, beautifies the surroundings, and encourages community gatherings**. With Trimlight, municipalities can invest in a lighting solution that truly reflects their values and aspirations, creating a lasting positive impact on the community.



PERFECT FOR EVENTS



COMPLIMENTS EVERY BUILDING



WEATHER-RESISTANT



USE FOR HOLIDAYS



50,000+ HOUR LIFESPAN

SOME BRANDS THAT ADORN TRIMLIGHT

- 360 Espresso
- AlphaGraphics
- America's Country Store
- Beans and Brew
- Buck GMC
- Camping World
- Chevrolet
- Chick-fil-A
- City of Taylorsville Building
- Cluster Truck
- Club Apple
- Colonial Flag
- Draper Self Storage
- Fast Signs
- Ford
- Freedom House
- Hudson Town Hall
- J&J Nursery
- Jeep
- Jimmy Hula's Food Nirvana
- La Quinta
- Laconia Harley-Davidson
- Malmrose Bridal
- Mazda Bountiful
- McDonald's
- Mike and Sterling's
- Modern Home
- Mythos Games
- North Star AG
- Northern Lights Health Care
- Oak Grove Estates
- Office Depot
- Palava Hut
- Pie Box
- Sayka
- Styla
- The County Line
- The Rush Funplex
- Think Storage
- Timberline Steaks-Seafood
- Victoria Royals WHL Hockey Team
- West Bay Casino



Visit our commercial page for more information.

TRIMLIGHT FAQ

HOW LONG DOES TRIMLIGHT LAST?

On average, Trimlight will last between 20-30 years (assuming it is only used during nighttime hours).

WHAT HAPPENS IF A BULB GOES OUT?

Should a bulb stop working, please reach out to the dealer that provided you your installation for a hassle-free replacement. Rest assured, your bulb is safeguarded by a product warranty on up to 50,000 hours of light use. Note: A labor charge may be incurred.

CAN I ACCESS MY LIGHTS ACROSS MULTIPLE LOCATIONS OF MY BUSINESS?

Yes, with Trimlight's innovative app, you can easily control lights across multiple business locations from a single device. The system allows you to manage schedules, colors, and patterns for each location individually or all at once, giving you complete flexibility and control no matter where you are.

CAN I MATCH IT TO MY BUSINESS HOURS?

Absolutely! Trimlight's scheduling feature allows you to match your lighting to your business hours effortlessly.

HOW LONG HAS TRIMLIGHT BEEN IN BUSINESS?

Trimlight is the original inventor of permanent, programmable, color-changing holiday and all-occasion lighting, starting our journey in the LED lighting industry in 2010.

DO I NEED TO PROVIDE MAINTENANCE ON TRIMLIGHT OR IS IT CAREFREE?

When you choose Trimlight, a maintenance-free, worry-free experience is waiting for you. Should you need a bulb replaced, a new controller, or you require any product warranty work, simply contact the dealer who completed your installation.

HOW IS TRIMLIGHT INSTALLED ON MY BUSINESS?

Trimlight is professionally installed by trained technicians who ensure the system blends seamlessly with your building's architecture. The low-profile, aluminum channel is custom-fit to your structure, housing the lights securely and discreetly. This allows the system to remain virtually invisible during the day while providing vibrant, customizable lighting at night.

HOW MUCH WILL I SAVE?

Once Trimlight is installed, you'll eliminate the cost of seasonal installation and takedown of temporary lighting. Plus, switching from incandescent lights will save you hundreds, or even thousands, on your utility bills.

HOW LONG IS INSTALLATION?

Typically, the installation process is completed within a single day. However, for large commercial spaces, the setup may span over multiple days.

IS THE TRIMLIGHT APP CLOUD-BASED?

Certainly! The Trimlight app is a cloud-based platform that allows you to control your lighting system from anywhere in the world.

COLORS TO MATCH

Choose from a variety of profiles, each designed to cater to distinct aesthetic preferences and architectural styles. Whether you prefer a sleek and modern look or a classic, timeless appeal, our Trimlight channel offers the perfect blend of form and function to your business. Trimlight offers over 50 aluminum color options (not all shown below) and we can provide other colors if you don't see one that matches your case.

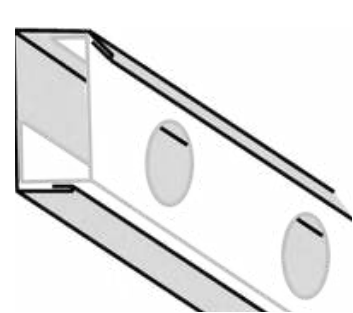

SNAP IN BASE

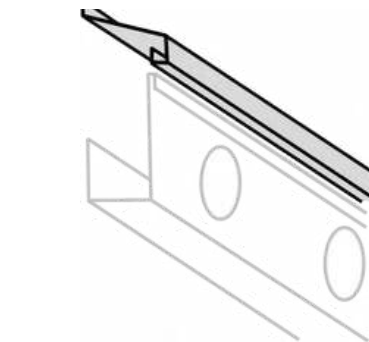

DRIP COMMERCIAL COVER

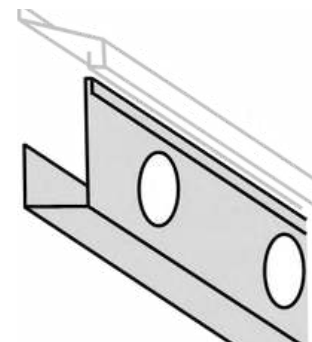

DRIP COMMERCIAL CHANNEL

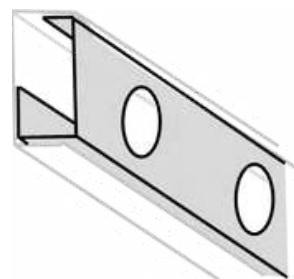

SNAP IN CHANNEL

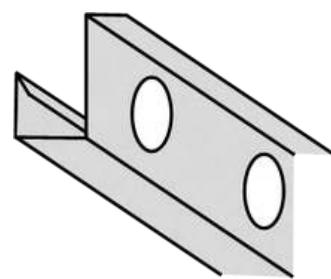

COMMERCIAL FRONT FACING STANDARD

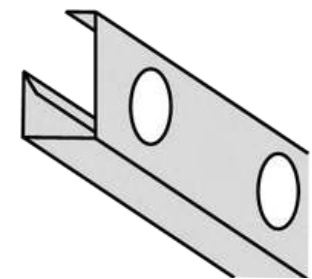

COMMERCIAL FRONT FACING DECK

BULB SPECS

TRIMLIGHT 3L

- LEDs: 3
- Lifespan of Bulb: 50,000+ hours
- Colors: RGB
- Spacing: 6", 9", 12"
- Control Method: Edge APP, Voice Control
- Voice Control: Google Home, Alexa
- Waterproof: IP68
- Voltage: 12V
- Wattage: .9W per bulb
- Lumens: 30-60 (depends on method of measurement)
- App Connectivity: 2.4GHz band, Wi-Fi
- Dances to Music: Auxiliary port to speaker

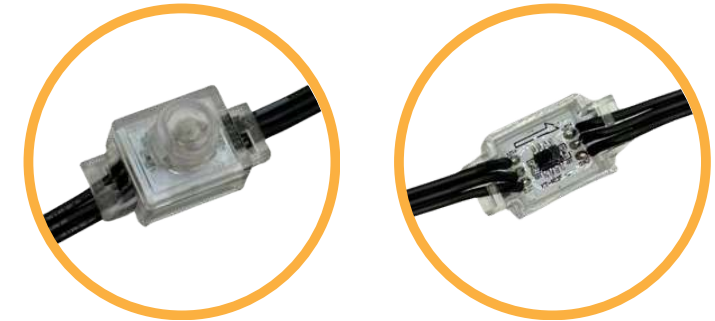

TRIMLIGHT COMMERCIAL

- LEDs: 3
- Lifespan of Bulb: 50,000+ hours
- Spacing: 12"
- Colors: RGB
- Control Method: Edge APP, Voice Control
- Voice Control: Google Home, Alexa
- Waterproof: IP68
- Voltage: 12V
- Wattage: 1W per bulb
- Lumens: 30-60 (depends on method of measurement)
- Dances to Music: Auxiliary port to speaker
- Customization: Customizable color patterns and low profile channel to match your brand
- Grouping: Can control multiple business locations from one central location and from anywhere in the world

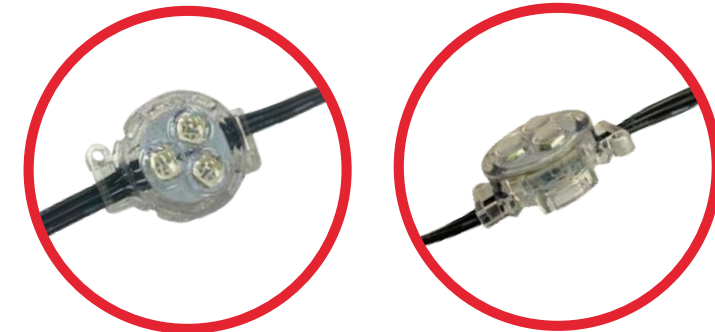

GLOBE LIGHTS

- LEDs: 6
- Professionally installed with 18" spacing between 2" diameter light spheres
- Gives a 360 degree light array with 1.2 watts per bulb
- High-grade commercial quality bulbs that run on only 24 volts
- Individual connectors on each light and a removable outside lens for easy maintenance
- Self supporting up to 10' in distance. Longer runs can be supported by cables or other supports





**Trusted Nationwide:
Thousands of 5-star reviews!**



Lifetime Product Warranty

Trimlight sets itself apart with superior quality and an unmatched lifetime product warranty, reflecting our unwavering confidence in our products. Since inventing and patenting permanent trim lighting in 2010, our guarantee has stemmed from rigorous testing, continuous innovation, and a steadfast commitment to excellence, ensuring your investment in Trimlight lasts for decades.

While a few companies claim their bulbs last 50,000+ hours, they hesitate to offer a lifetime product warranty, revealing a lack of confidence in their products' longevity. Trimlight is different. We back our reliability claims with a lifetime product warranty, proving our dedication to quality and client satisfaction.

By choosing Trimlight, you're partnering with a company that guarantees not just a product, but a commitment to excellence and peace of mind. Our lifetime product warranty stands as a testament to our products' durability and your satisfaction, making Trimlight the best choice for permanent outdoor lighting for your business.



**REQUEST
ESTIMATE**