

**APPLICATION FOR A CERTIFICATE OF APPROPRIATENESS FOR
A SIGN IN A SPECIAL PROVISION SIGN DISTRICT (SPSD)**

DEEP ELLUM/ NEAR EAST SIDE SIGN DISTRICT

CASE NUMBER: 2409160016
LOCATION: 2713 Canton Street
(south elevation)

DATE FILED: September 17, 2024
SIZE OF REQUEST: 16 sq. ft.

COUNCIL DISTRICT: 2

ZONING: PD-269, TRACT A

APPLICANT: Kenneth Waits of CITY SIGN SERVICES, INC.

OWNER: 2713 CANTON LTD

TENANT: Deep Ellum Live, LTD

REQUEST: An application for a Certificate of Appropriateness by Kenneth Waits of CITY SIGN SERVICES, INC., for a 16-square-foot LED illuminated attached sign at 2713 Canton Street (south elevation).

SUMMARY: The applicant proposes to install a 16-square-foot attached sign, composed of Red/Green/Blue (RGB) LED illuminated cabinet, push thru acrylic letters, projecting two-feet from the south elevation, and bearing the name 'The Bomb Factory' with logo and 'invade * destroy * repeat *'.

STAFF RECOMMENDATION: Approval.

SSDAC RECOMMENDATION: Approval.

BACKGROUND:

- The subject site is located in Deep Ellum/ Near East Side SPSP. This district follows Planned Development Number 269 (PD-269), Deep Ellum/ Near East Side, Tract A. These regulations are established in: [Sec. 51A-7.1300](#) (Specific details included below).
- The applicant proposes to install a 16-square-foot attached sign, composed of Red/Green/Blue (RGB) LED illuminated cabinet, push thru acrylic letters, projecting two-feet from the south elevation, and bearing the name 'The Bomb Factory' with logo and 'invade * destroy * repeat *'.
 - The sign is composed of a two-foot by eight-foot- by one-foot three sided cabinet. Faces are clear push thru type, with white translucent vinyl applied. All sign elements are constructed entirely of metal and plastic. The overall projection of the sign from the surface in which it is attached will be two feet.
 - The exterior of the cabinet will be aluminum that is painted Black. The sign will be backlit by Red/Green/Blue (RGB) LED illumination.
 - Mounting Hardware consists of 5/8-inch Dia Bolt with washers and nuts to be anchored directly to steel angle backer per engineering.
- This is the second of two applications for this site. This sign is to be located on left side of the south elevation. All proposed signs, for all applications at this site, are of similar construction.
- Construction of the proposed sign is in accordance with SPSP regulations and meets the requirements of the Dallas City Code per Sec. 51A-7.1300.

51A-7.1302 PURPOSE.

The purpose of this division is to promote signage that is compatible with the architectural character and design guidelines of the Deep Ellum/Near East Side Planned Development District while encouraging artistic, creative, and innovative signs which are reflective of themes that have grown and developed in the Deep Ellum area. (Ord. 20596)

51A-7.1305 SPECIAL PROVISIONS FOR ALL SIGNS.

- (a) Signs in this district are permitted to overhang the public right-of-way subject to city franchising requirements.
- (b) Except for wallscape signs, painted applied signs, and district identification signs, no sign may exceed 150 square feet unless it is located more than 65 feet above grade, at which point no sign may exceed 300 square feet.
- (c) Except as otherwise provided in Subsections (d) and (e), the maximum effective area of all signs combined on a premise, not including A-frame signs, painted applied signs on certain facades, and district identification signs, is 10 percent of the total area of all building facades facing public right-of-way that is adjacent to the premise, not to exceed 1,200 square feet. Where a premise has only one facade facing an adjacent public right-of-way, the maximum effective area can be increased to 15 percent of that facade, not to exceed 500 square feet.

All proposed signs will project into the public right-of-way and franchise agreements have been applied for. Sign is less than 150-square-feet with a combined total of less than 10-percent of the total façade.

51A-7.1306 SPECIAL PROVISIONS FOR ATTACHED SIGNS.

- (a) Attached signs in general.
 - (1) No portion of an attached sign may be located:
 - (A) more than 10 feet from the facade to which it is attached; or
 - (B) less than two feet from the back of a street curb.

This sign will only project two feet from the façade in which it is attached. It is not located less than two feet from the street curb.

51A-7.505 PERMIT PROCEDURES FOR SPECIAL PROVISION SIGN DISTRICTS.

(B) **Factors the committee shall consider.** In reviewing an application, the committee shall first consider whether the applicant has submitted sufficient information for the committee to make an informed decision. If the committee finds the proposed sign to be consistent with the special character of the special provision sign district, the committee shall make a recommendation of approval to the city plan commission. **The committee shall consider the proposed sign in terms of its appropriateness to the special provision sign district with particular attention to the effect of the proposed sign upon the economic structure of the special provision sign district and the effect of the sign upon adjacent and surrounding premises without regard to any consideration of the message conveyed by the sign.** After consideration of these factors, the committee shall recommend approval or denial of the application and forward that recommendation to the city plan commission.

(6) Decision by the commission. Upon receipt of a recommendation by the committee, the commission shall hold a public hearing to consider the application. At least 10 days before the hearing, notice of the date, time, and place of the hearing, the name of the applicant, and the location of the proposed sign must be published in the official newspaper of the city and the building official shall serve, by hand-delivery or mail, a written notice to the applicant that contains a reference to this section, and the date, time, and location of this hearing. A notice sent by mail is served by depositing it properly addressed and postage paid in the United States mail. In addition, if the application is for a detached sign or for an attached sign that has more than 100 square feet of effective area, the applicant must post the required number of notification signs in accordance with Section 51A-1.106. **In making its decision, the commission shall consider the same factors that were required to be considered by the committee in making its recommendation.** If the commission approves the application, it shall forward a certificate of appropriateness to the building official within 15 days after its approval. If the commission denies the application, it shall so inform the building official in writing. Upon receipt of the written denial, the building official shall so advise the applicant within five working days of the date of receipt of the written notice.

SSDAC Action:

October 8, 2024

MOTION: It was moved to **approve:**

An application for a Certificate of Appropriateness by Kenneth Waits of CITY SIGN SERVICES, INC., for a 16-square-foot LED illuminated attached sign at 2713 Canton Street (south elevation).

Maker: Peadon
Second: Webster
Result: Carried: 4 to 0

For: 3 - Peadon, Webster, Carpenter, and
Against: 0 - none
Absent: 2 - Haqq, Dumas
Conflict: 0 - none

Speakers: none

Property Ownership

2713 CANTON LTD
2550 Pacific Ave #1600
Dallas, TX 75226

Officer names: Joe Beard President

Tenant Ownership

Deep Ellum Live, LTD
2550 Pacific Ave #1600
Dallas, TX 75226

Officer names: Ken Carlson President

Job 193150998-002 (2409160016)

Job Edit

Miscellaneous Transaction Job 193150998-002 (2409160016)

Electrical Sign (ES) ATTACHED - FRONT ELV (A) New Construction

Status: Paid Created By: TLUMSDEN

Date Created: Sep 16, 2024

Date Completed: Sep 17, 2024

Parent Job: 193150998-001 (2409121022)

Specific Location: 16SF- 2713 CANTON ST - LED ILLUMINATED PROJECTING SIGN
CA#2409160016

Details

Customer: Waits, Kenneth
3914 Elm St.
Dallas, TX 75226
(214) 826-4475
css1956@aol.com

Fee Amount

FeeType

Staff Email: SCOTT.ROPER@DALLAS.GOV

Details



Customer: Waits, Kenneth
3914 Elm St.
Dallas, TX 75226 (214) 826 4475

Fees (EXT): 2409160016 Technology Fee \$15.00
Adjusted:\$0.00 Paid:\$15.00 Owed:\$0.00

Fees (EXT): 2409160016 5BN - Special Provision Sign District fee \$397.00
Adjusted:\$0.00 Paid:\$397.00 Owed:\$0.00

Fees

Description	Posted Date	Amount	Tax	Total	Balance
5BN - Special Provision Sign District fee		\$397.00	\$0.00	\$397.00	\$0.00
Receipt Number: 918167 \$412.00		(\$397.00)	\$0.00	(\$397.00)	
Technology Fee		\$15.00	\$0.00	\$15.00	\$0.00
Receipt Number: 918167 \$412.00		(\$15.00)	\$0.00	(\$15.00)	
					\$0.00

Job 193150998-002 (2409160016)

Processes

Assigned To	Status	Outcome	Scheduled		Actual	
			Start	Completed	Start	Completed
System Fee Collection						
SICASHIERINTERFACE	Complete	Collected				Sep 17, 2024 13:08:33
Auto generated System Fee Collection						

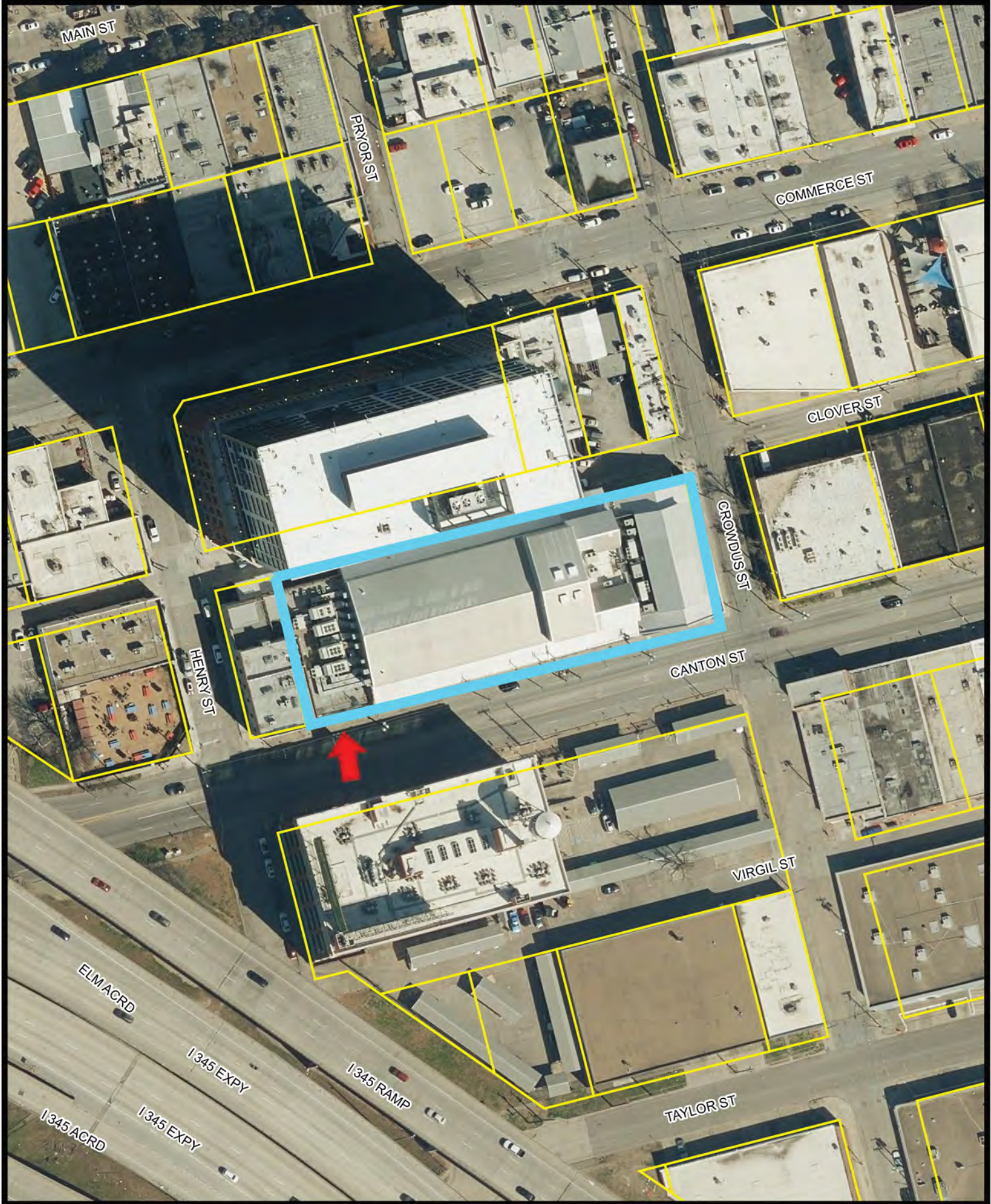

Printed Date: 10/2/2024

 1:1,200 Aerial Map - 2713 & 2727 Canton St

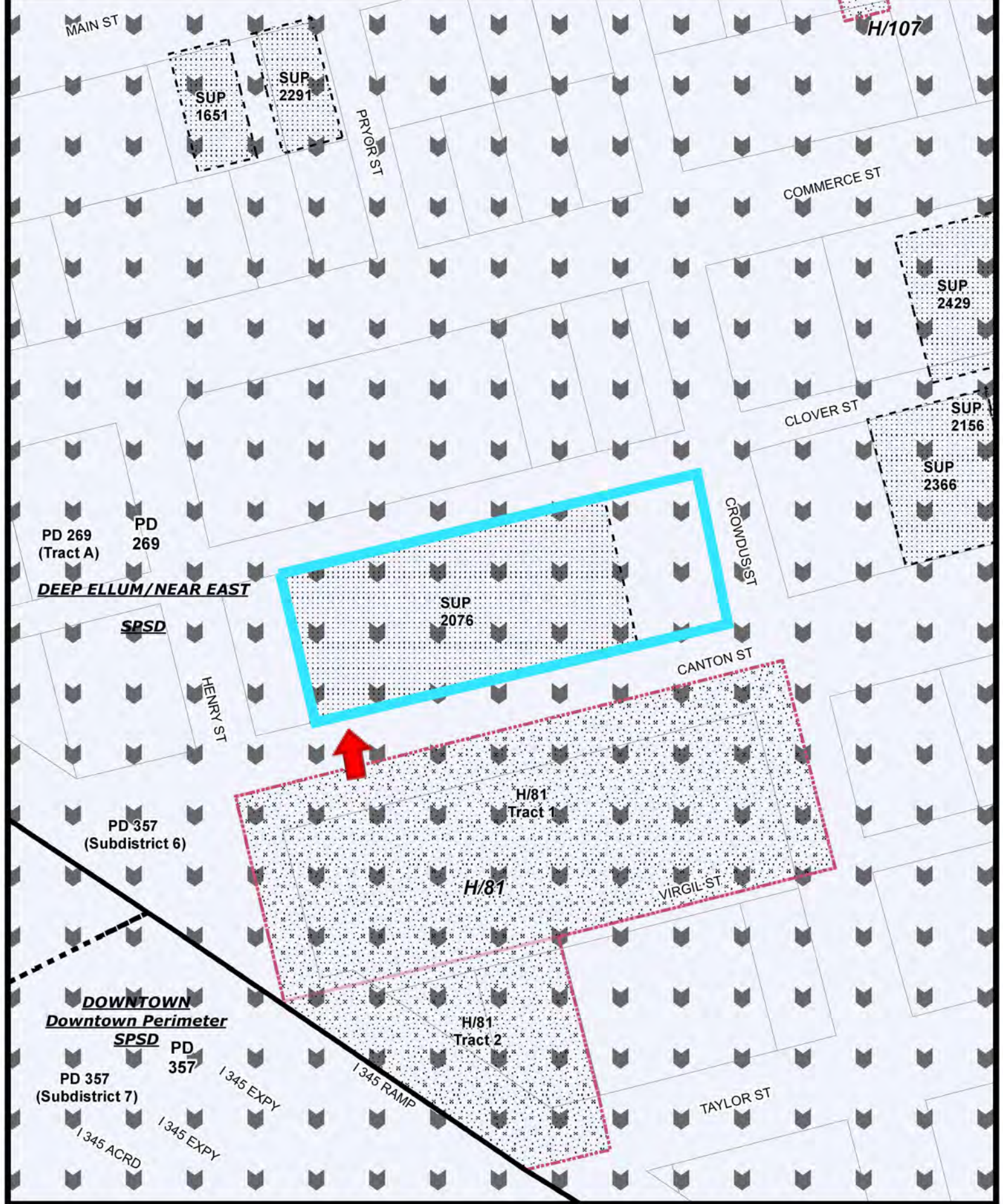

Printed Date: 10/2/2024



240194 THE BOMB FACTORY AT DEEP ELLUM

DALLAS, TX | 4.25.24

© BL 1225232 + TLR 10033



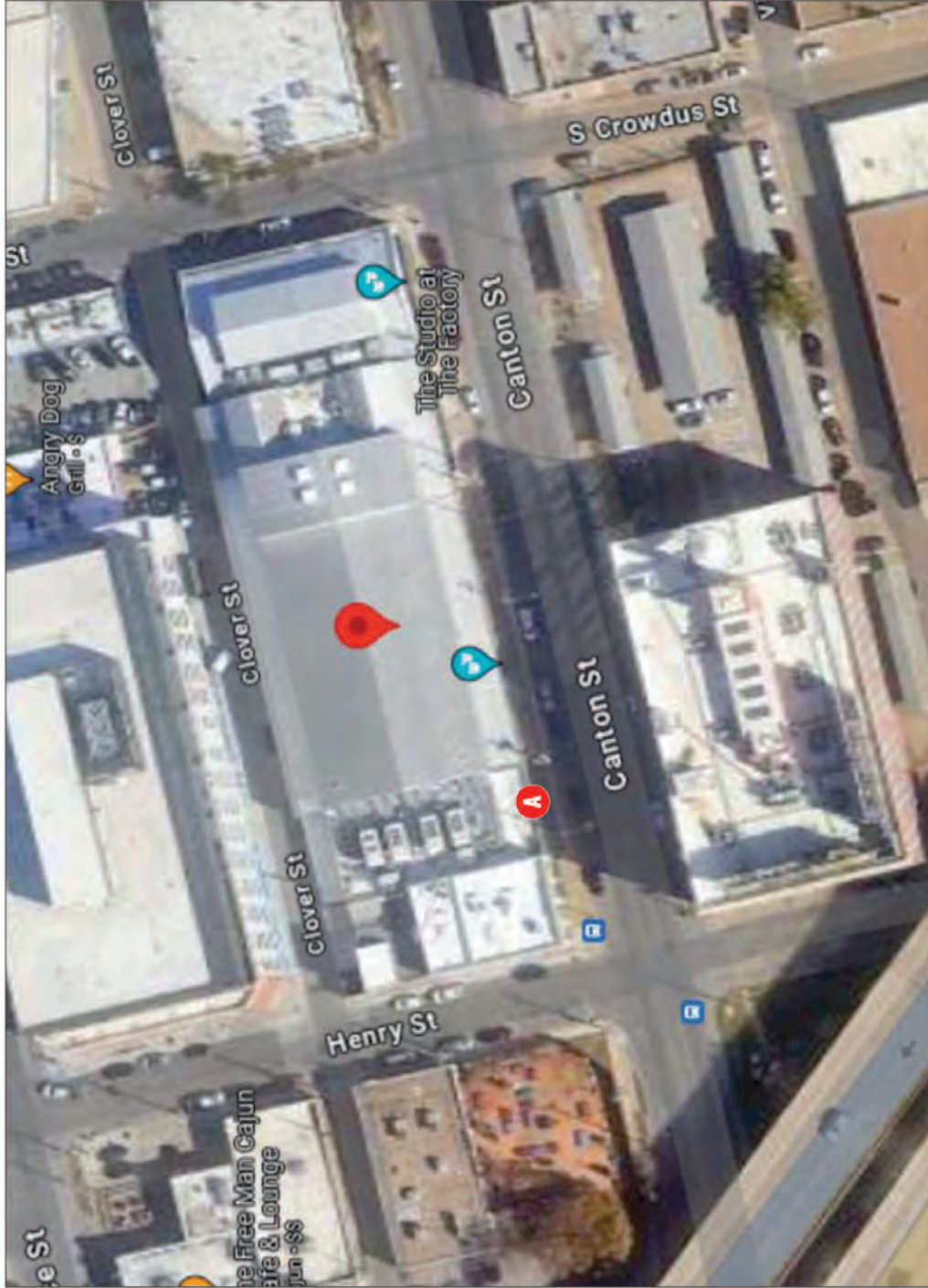

SITE PLAN - AERIAL VIEW

7923 E. McKinney St.
 Denton, TX 76208
 Office: 817.431.5700
 Fax: 817.431.5799



PRESENTATION DOCUMENT
 THE COLORS, SIZES AND PROPORTIONS INCLUDED IN THIS PRESENTATION DOCUMENT WILL BE USED AS A GUIDE ONLY. ALL DIMENSIONS AND PROPORTIONS SHOWN ARE APPROXIMATE. ALL DIMENSIONS AND PROPORTIONS MUST BE VERIFIED ON THE GROUND. ALL DIMENSIONS AND PROPORTIONS MUST BE VERIFIED ON THE GROUND. ALL DIMENSIONS AND PROPORTIONS MUST BE VERIFIED ON THE GROUND.

JOB NUMBER	DATE	BY	REV	NOTES
240154	5-14-24	JC	B6	ADD COMMENTS AND TO CHECK FOR REQUIRED SIGNATURES FOR PERMITS/PLANNING
81435100	5-14-24	JC	B7	ADD COMMENTS AND TO CHECK FOR REQUIRED SIGNATURES FOR PERMITS/PLANNING
81435100	5-28-24	JC	B4	ADD COMMENTS AND TO CHECK FOR REQUIRED SIGNATURES FOR PERMITS/PLANNING
81435100	6-10-24	JC	B9	ADD COMMENTS AND TO CHECK FOR REQUIRED SIGNATURES FOR PERMITS/PLANNING
81435100	7-15-24	CR	B7	ADD COMMENTS AND TO CHECK FOR REQUIRED SIGNATURES FOR PERMITS/PLANNING

THIS DRAWING PACKAGE IS THE PROPERTY OF LEGACY SIGNS & GRAPHICS. BY ACCEPTING THIS DOCUMENT, RECIPIENT ASSUMES CUSTODY AND ACCESS THAT THIS DOCUMENT WILL NOT BE REPRODUCED OR REPRODUCED IN WHOLE OR IN PART ITS CONTENTS REFERRED IN ANY MANNER OTHER THAN TO THE INTENDED PARTY WITHOUT EXPRESS WRITTEN PERMISSION FROM LEGACY SIGNS & GRAPHICS. 817.431.5700

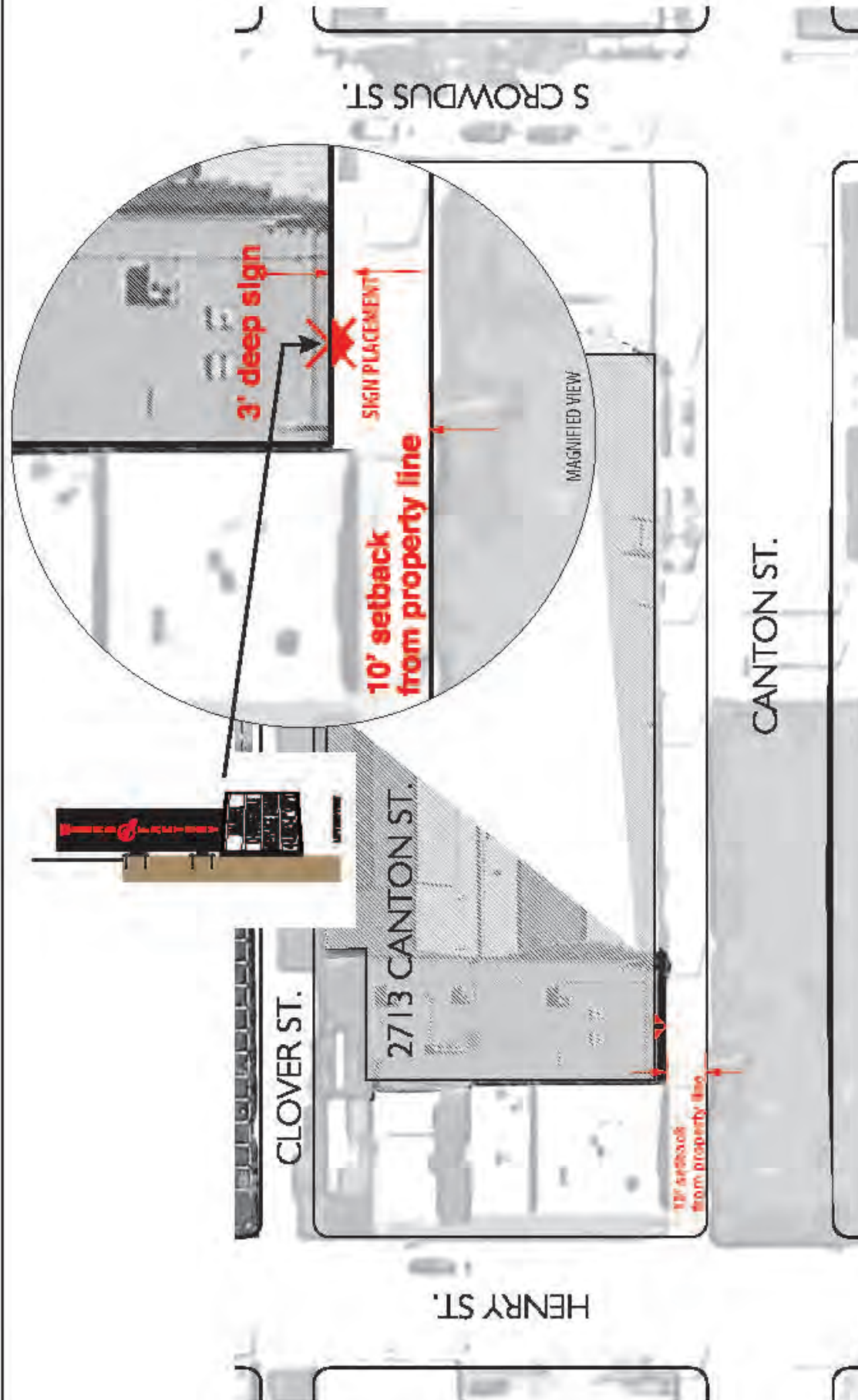

SITE PLAN

7923 E. McKinney St.
 Denton, TX 76208
 Office: 817.431.5700
 Fax: 817.431.5799



PRESENTATION DOCUMENT

THE DIMENSIONS AND PROPORTIONS SHOWN IN THIS PRESENTATION DOCUMENT ARE FOR INFORMATION ONLY AND ARE NOT TO BE USED FOR CONSTRUCTION OR FOR ANY OTHER PURPOSE. THE DIMENSIONS AND PROPORTIONS SHOWN IN THIS PRESENTATION DOCUMENT ARE FOR INFORMATION ONLY AND ARE NOT TO BE USED FOR CONSTRUCTION OR FOR ANY OTHER PURPOSE.

DATE	BY	REV	NOTES
5.3.24	X	16	ADDITIONAL SIGNAGE FOR THE PROPERTY
5.3.24	X	15	ADDITIONAL SIGNAGE FOR THE PROPERTY
5.3.24	X	14	ADDITIONAL SIGNAGE FOR THE PROPERTY
5.3.24	X	13	ADDITIONAL SIGNAGE FOR THE PROPERTY
5.3.24	X	12	ADDITIONAL SIGNAGE FOR THE PROPERTY
5.3.24	X	11	ADDITIONAL SIGNAGE FOR THE PROPERTY
5.3.24	X	10	ADDITIONAL SIGNAGE FOR THE PROPERTY
5.3.24	X	9	ADDITIONAL SIGNAGE FOR THE PROPERTY
5.3.24	X	8	ADDITIONAL SIGNAGE FOR THE PROPERTY
5.3.24	X	7	ADDITIONAL SIGNAGE FOR THE PROPERTY
5.3.24	X	6	ADDITIONAL SIGNAGE FOR THE PROPERTY
5.3.24	X	5	ADDITIONAL SIGNAGE FOR THE PROPERTY
5.3.24	X	4	ADDITIONAL SIGNAGE FOR THE PROPERTY
5.3.24	X	3	ADDITIONAL SIGNAGE FOR THE PROPERTY
5.3.24	X	2	ADDITIONAL SIGNAGE FOR THE PROPERTY
5.3.24	X	1	ADDITIONAL SIGNAGE FOR THE PROPERTY

THIS DRAWING IS THE PROPERTY OF LEGACY SIGNS OF TEXAS. BY ACCEPTING THIS DRAWING, THE CLIENT ASSUMES ALL LIABILITY FOR ANY ERRORS OR OMISSIONS THAT MAY BE FOUND IN THIS DRAWING. LEGACY SIGNS OF TEXAS DOES NOT WARRANT THE ACCURACY OF ANY INFORMATION OTHER THAN THAT WHICH IS SPECIFICALLY STATED ON THIS DRAWING. LEGACY SIGNS OF TEXAS IS NOT RESPONSIBLE FOR ANY DAMAGE TO ANY PROPERTY OR PERSONS ARISING FROM THE USE OF THIS DRAWING.



EXISTG. CONDITIONS



A PROPOSED NEW SOUTH ELEVATION

(1) REQUIRED - MANUFACTURE & INSTALL

SCALE: 1/8" = 1'-0"

132 SQFT

7923 E. McKinney St.
 Denton, TX 76208
 Office: 817.431.5700
 Fax: 817.431.5799



PRESENTATION DOCUMENT

THE COLORS, SIZES AND PROPORTIONS INCLUDED IN THIS PRESENTATION DOCUMENT ARE FOR PRESENTATION PURPOSES ONLY AND ARE NOT TO BE USED FOR CONSTRUCTION. ALL DIMENSIONS AND PROPORTIONS MUST BE RECHECKED TO CHANGE UPON THE RESULTS OF A TECHNICAL SURVEY.

DATE	BY	REV	NOTES
5-14-24	K	06	CALL OUT MATERIAL AND FINISHES FOR MANUFACTURE FROM SHEET LAMINATED MANUFACTURING
5-14-24	K	07	ADD SITE PLAN SHOWING SIGN LOCATION
5-24-24	K	08	ADD COLOR NOTES
6-10-24	K	09	REMOVE FINISH NOTES TO BOTTOM OF SHEET
7-15-24	CR	01	ADDED SIGN HEIGHT & SIGN DIMENSIONS

THIS DRAWING PACKAGE IS THE PROPERTY OF LEGACY SIGNS OF TEXAS. BY ACCEPTING THIS DOCUMENT, RECIPIENT ASSUMES CUSTOMY AND AGREES THAT THIS DOCUMENT WILL NOT BE REPRODUCED OR REPRODUCED IN WHOLE OR IN PART ITS CONTENTS REVEALED IN ANY MANNER OTHER THAN TO THE INTENDED PARTY WITHOUT EXPRESS WRITTEN PERMISSION FROM LEGACY SIGNS OF TEXAS. 817.431.5700

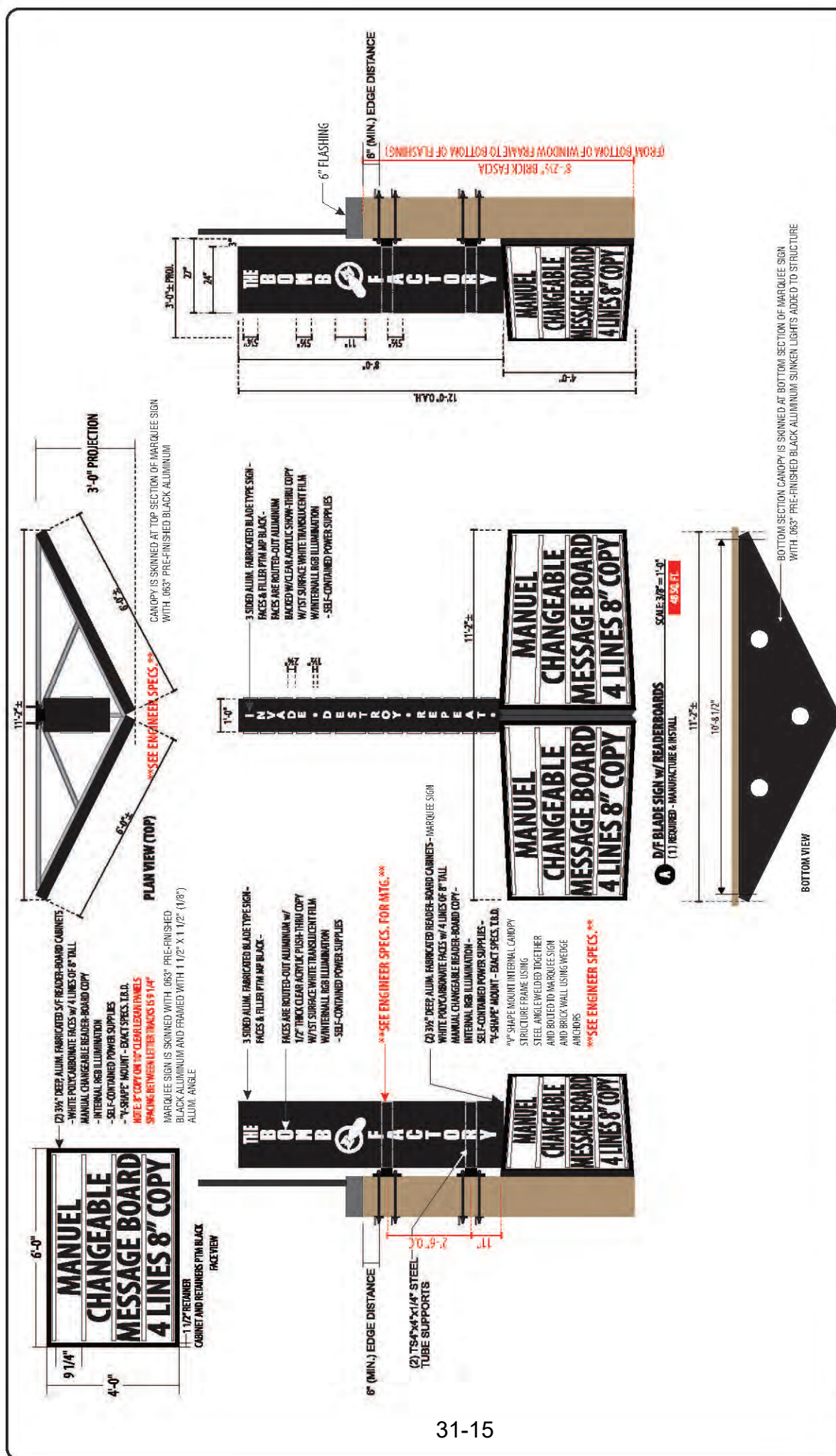

PLAN VIEW (TOP)

3'-0" PROJ. 27" 24" 11'-2"±

CANOPY IS SKINNED AT TOP SECTION OF MARQUEE SIGN WITH .063" PRE-FINISHED BLACK ALUMINUM

SEE ENGINEER SPECS.

FACE VIEW

6'-0" 9 1/4" 4'-0" 1'-1/2" RETAINER CABINET AND RETAINERS PTM BLACK

(2) 3/4" DEEP ALUM. FABRICATED SF READER-BOARD CABINETS - WHITE POLY CARBONATE FACES w/ 4 LINES OF 8" TALL MANUAL CHANGEABLE READER-BOARD COPY - INTERNAL RGB ILLUMINATION - SELF-CONTAINED POWER SUPPLIES - "V" SHAPE MOUNT - EXACT SPECS. T.B.D. NOTE: COUPLER "U" COUPLER PANELS SPACING BETWEEN LETTER THICKS 6'S 1/4"

MARQUEE SIGN IS SKINNED WITH .063" PRE-FINISHED BLACK ALUMINUM AND FRAMED WITH 1 1/2" X 1 1/2" (1/8") ALUM. ANGLE

3 SIDED ALUM. FABRICATED BLADE TYPE SIGN - FACES & FILLER PTM WP BLACK - FACES ARE ROUTED-OUT ALUMINUM 1/2" THICK CLEAR ACRYLIC PUSH-THRU COPY w/ 1ST SURFACE WHITE TRANSLUCENT FILM W/ INTERNAL RGB ILLUMINATION - SELF-CONTAINED POWER SUPPLIES

SEE ENGINEER SPECS. FOR MTC.

(2) 3/4" DEEP ALUM. FABRICATED READER-BOARD CABINETS - MARQUEE SIGN WHITE POLY CARBONATE FACES w/ 4 LINES OF 8" TALL MANUAL CHANGEABLE READER-BOARD COPY - INTERNAL RGB ILLUMINATION - SELF-CONTAINED POWER SUPPLIES - "V" SHAPE MOUNT - EXACT SPECS. T.B.D. "V" SHAPE MOUNT INTERNAL CANOPY STRUCTURE FRAME USING STEEL ANGLE WELDED TOGETHER AND BOLTED TO MARQUEE SIGN AND BRICK WALL USING WEDGE ANCHORS

SEE ENGINEER SPECS.

FACE VIEW

1'-0" 11'-2"±

MADE • DESTROY • REPEAT •

MANUEL CHANGEABLE MESSAGE BOARD 4 LINES 8" COPY

MANUEL CHANGEABLE MESSAGE BOARD 4 LINES 8" COPY

FACE VIEW

11'-2"±

MANUEL CHANGEABLE MESSAGE BOARD 4 LINES 8" COPY

MANUEL CHANGEABLE MESSAGE BOARD 4 LINES 8" COPY

FACE VIEW

11'-2"±

MANUEL CHANGEABLE MESSAGE BOARD 4 LINES 8" COPY

MANUEL CHANGEABLE MESSAGE BOARD 4 LINES 8" COPY

FACE VIEW

11'-2"±

MANUEL CHANGEABLE MESSAGE BOARD 4 LINES 8" COPY

MANUEL CHANGEABLE MESSAGE BOARD 4 LINES 8" COPY

FACE VIEW

11'-2"±

MANUEL CHANGEABLE MESSAGE BOARD 4 LINES 8" COPY

MANUEL CHANGEABLE MESSAGE BOARD 4 LINES 8" COPY

FACE VIEW

11'-2"±

MANUEL CHANGEABLE MESSAGE BOARD 4 LINES 8" COPY

MANUEL CHANGEABLE MESSAGE BOARD 4 LINES 8" COPY

FACE VIEW

11'-2"±

MANUEL CHANGEABLE MESSAGE BOARD 4 LINES 8" COPY

MANUEL CHANGEABLE MESSAGE BOARD 4 LINES 8" COPY

FACE VIEW

11'-2"±

MANUEL CHANGEABLE MESSAGE BOARD 4 LINES 8" COPY

MANUEL CHANGEABLE MESSAGE BOARD 4 LINES 8" COPY

JOB NUMBER		DATE	BY	REV	NOTES
240724		5/14/24	JK	87	CALL OUT MATERIAL ON CROSS SECTIONS COORDINATE WITH APPROV MARQUEE DRAWING
JOB DESCRIPTION		5/14/24	JK	88	ADD 100% TRANSPARENT BRICK FLASHING
JOB NAME		5/24/24	JK	89	ADD COLOR CODES
ADDRESS		6/10/24	JK	89	SKIN W/ .063" PRE-FINISHED BLACK ALUM
SALES		7/15/24	CR	89	ADD 100% TRANSPARENT BRICK FLASHING
PROJECT MANAGER					

PRESENTATION DOCUMENT

THE COLORS, SIZES AND PROPORTIONS SHOWN IN THIS PRESENTATION DOCUMENT ARE PRELIMINARY. THE FINAL DESIGN AND PROPORTIONS WILL BE PROVIDED IN THE FINAL CONTRACT DOCUMENTS. THE CONTRACTOR SHALL BE RESPONSIBLE FOR OBTAINING ALL NECESSARY PERMITS AND APPROVALS. PROPORTIONS MAY BE REQUIRED TO CHANGE UPON THE RESULT OF A TECHNICAL SURVEY.

7923 E. McKinney St.
Denton, TX 76208
Office: 817.431.5700
Fax: 817.431.5799

LEGACY SIGNS
OF TEXAS

THIS DRAWING PACKAGE IS THE PROPERTY OF LEGACY SIGNS OF TEXAS. BY ACCEPTING THIS DOCUMENT, THE RECIPIENT ASSUMES FULL RESPONSIBILITY AND AGREES THAT THIS DOCUMENT WILL NOT BE REPRODUCED OR REUSED IN ANY MANNER WITHOUT THE WRITTEN PERMISSION OF LEGACY SIGNS OF TEXAS. 817.431.5700

5

Date:	3/20/24	City, State:	Dallas, TX	SHEET:	1 OF 2
Client:	Legacy Signs of Texas	Overall Height:	30'-0" Max.		Sean M. McFarland, P.E.
Sign:	The Bomb Factory at Deep Ellum	Wind Speed	105 mph		McFarland Engineering

Project Description	2713 Canton St
ME Job:	65617
Content:	Page
Design Loads	1
Connection Design	1-2

HORIZONTAL TUBE IN (2) PLACES
BASEPLATE DESIGN
ULTIMATE LOADS
30 PSF

Overall Size: 12'-0" x 11'-2"
 Mounting Height: 30'-0" Max.
 Mounting Style: Cantilevered Wall Sign

Structural Variables and Code Loading Specifications
 Sign Type: Cantilevered Wall Sign
 Existing Wall Material: Other
 Sign Weight Per Foot: 15
 Code: 2021 IBC W/ Amends
 Wind Speed: 105
 Wind Exposure: C
 Wind Loads Per ASCE 7-16

Connection Design
 Using ASCE 7-16 (Simplified Procedure)
 Topography: Homogeneous
 Exposure: C
 Enclosure: Enclosed
 Structure: Components and Cladding
 Building: Category II

$I = 1.15$ (Table 6-1)
 $\lambda = 1.40$ (Figure 6-3, Exp. C, height = 30 ft)
 Zone = 5 (End-Wall - Worst Case)
 Effective Wind Area = 10 Sq. Ft.
 Net Wind Pressure = -19.5 (Figure 6-3)

Total Load
 $P_{net} = (\lambda \cdot b \cdot d) \cdot P_{net}$
 $P_{net} (30) = -31.40$ PSF

Sign Loads
 Area = 105.36 FT²
 Pressure (Suction) Force = -3308 LBF

Horizontal Supports (2)
 Moment Arm = 1.5 FT
 Total Moment = 4961 LB FT (WL)

Sxx Req'd = 1.86 in³ (Each Support (95% of Total Load Approx))
 Sxx Provided = 3.86 in³ (OK) (USE: (2) TS4x4x1/4" Steel Square Tubes, 46 KSI)
 Attach Reader Board Cabinets to Fully Welded 1-1/2"x1-1/2"x1/8" Triangulated Steel Tube Frame to Wall with Total (8) 1/2" Dia. Thru Bolts. Attach Each Reader Board Cabinet to Frame with (4) 3/8" Dia. Thru Bolts.



Date:	3/20/24	City, State:	Dallas, TX	SHEET:	2 OF 2
Client:	Legacy Signs of Texas	Overall Height:	30'-0" Max.		Sean M. McFarland, P.E.
Sign:	The Bomb Factory at Deep Ellum	Wind Speed	105 mph		McFarland Engineering

2713 Canton St

ME Job: 65617

Baseplate Design -
 A36 Steel
 E70 Electrodes
 A307 A.B.'s
 # of Bolts = 4
 Column Mom = 4,714 #-FT

D = 4.00 IN
 e = 1.00 IN
 b = 4.00 IN
 d = 4.00 IN
 Baseplate t = 0.75 IN

Fy = 36ksi
 Fw = 928 #/in¹⁶h
 Ft = 20 ksi
 Dia. Bolt = 0.625

P Bolt = $M \cdot 12 / (in/ft)$
 2 bolts (D + e + t) = 4,919 # < 6,100 #

t req'd = $[(6 \cdot P \cdot e \cdot 2 \text{ bolts}) / (0.75 \cdot F_y \cdot (D + 2 \cdot t))] \cdot 1/2$
 = .630 IN < 0.75 IN

Weld = $M \cdot 12 / (in/ft)$
 Fw (b * d + D * 2/3) = 2.86 16h's < 4.00 16h's

USE: (4) 5/8" Dia. Thru Bolts w/ 3/4" Baseplate. Weld to Support with (2) 3/16" Fillet Welds.

LEGACY SIGNS OF TEXAS

7923 E. McKinney St.
 Denton, TX 76208
 Office: 817.431.5700
 Fax: 817.431.5799

PRESENTATION DOCUMENT

THE COLOUR, SIZE AND PROPORTIONS INCLUDED IN THIS PRESENTATION DOCUMENT ARE FOR INFORMATION ONLY AND ARE NOT TO BE USED FOR CONSTRUCTION. THE USER SHALL BE RESPONSIBLE FOR OBTAINING ALL NECESSARY PERMITS AND APPROVALS FROM THE APPROPRIATE AUTHORITIES. PROPORTIONS MAY BE REQUIRED TO CHANGE UPON THE RESULTS OF A TECHNICAL SURVEY.

DATE	BY	REV	NOTES
5-14-24	K.	85	ALL LOT MATERIAL AND THE ASSOCIATED MANUFACTURING SHALL BE APPROVED AND SIGNED BY THE USER.
5-14-24	K.	87	ADD SITE AREA SIGNING BOARD TO PLAN.
5-24-24	K.	88	JOB SPECIFICATIONS.
6-10-24	K.	89	REMOVE FINISH HEIGHTS FROM THE PLAN.
7-15-24	CR.	91	REMOVE FINISH HEIGHTS FROM THE PLAN.

THIS DRAWING PACKAGE IS THE PROPERTY OF LEGACY SIGNS OF TEXAS. BY ACCEPTING THIS DOCUMENT, RECEIPT ASSUMES CUSTODY AND AGREES THAT THIS DOCUMENT WILL NOT BE REPRODUCED OR REPRODUCED IN WHOLE OR IN PART ITS CONTENTS REVEALED IN ANY MANNER OTHER THAN TO THE INTENDED PARTY WITHOUT EXPRESS WRITTEN PERMISSION FROM LEGACY SIGNS OF TEXAS. 817.431.5700

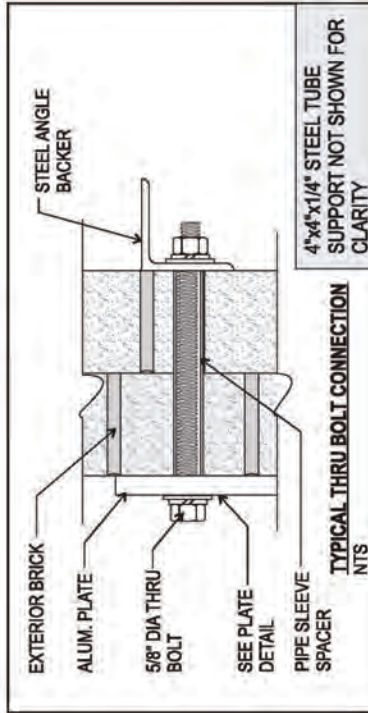
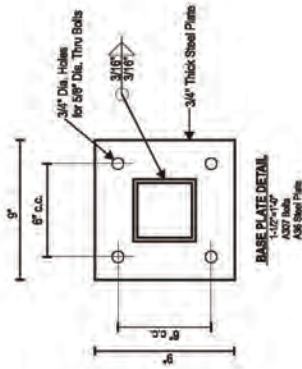

The electronic seal appearing on this document was authorized by Sean M. McFarland, P.E. on March 20, 2024.

Date: 3-20-2024
 Sheet #: 5 OF 6
 NC Firm Registration: F-118
 License Expiration Date: 03/20/24
 Texas Firm Registration: F-8686



Initial Drawing: (68817) DS

ENGINEERING OF ATTACHMENT TO WALL ONLY. NO CABINET ENGINEERING OR EVALUATION OF AS BUILT WALL CONDITIONS PROVIDED OR IMPLIED.

THE BOMB FACTORY AT DEEP ELLUM
 Address: 2713 CANTON ST
 City/State: DALLAS, TX
 Client: LEGACY SIGNS OF TEXAS

Ph: (281) 813-7439
 Email: sean@sgstructures.com
 Web: www.sgstructures.com



7

THIS DRAWING PACKAGE IS THE PROPERTY OF LEGACY SIGNS OF TEXAS. BY ACCEPTING THIS DOCUMENT, RECIPIENT ASSUMES CUSTODY AND AGREES THAT THIS DOCUMENT WILL NOT BE REPRODUCED OR TRANSMITTED IN ANY FORM OR BY ANY MEANS, ELECTRONIC OR MECHANICAL, INCLUDING PHOTOCOPYING, RECORDING, OR BY ANY INFORMATION STORAGE AND RETRIEVAL SYSTEM, WITHOUT PERMISSION FROM LEGACY SIGNS OF TEXAS. 817.431.5700

DATE	BY	REV	NOTES
5-14-24	K	B6	ALL OUT MATERIAL AND THE EXISTING PERMANENT SIGNAGE SHALL BE REMOVED AND REINSTALLED.
5-14-24	K	B7	ADD STEEL ANGLE BRACKETS TO BRACKET.
5-24-24	K	B8	ADD STUD BOLT NOTES.
6-30-24	K	B9	REMOVE FINISH HOLES TO MATCH EXISTING LOCATION.
7-31-24	CP	B12	NOTE TO MANUFACTURE & VERIFY DIMENSIONS.

PRESENTATION DOCUMENT

THE COLORS, SIZES AND PROPORTIONS INCLUDED IN THIS PRESENTATION DOCUMENT ARE FOR PRESENTATION PURPOSES ONLY AND ARE NOT TO BE USED FOR CONSTRUCTION. ANY CHANGES TO THE DESIGN OR PROPORTIONS WILL BE REQUIRED TO BE MADE UPON THE RESULTS OF A TECHNICAL SURVEY.

7923 E. McKinney St.
 Denton, TX 76208
 Office: 817.431.5700
 Fax: 817.431.5799



Connection Specification -
 Attach Reader Board Cabinets to Fully Welded 1-1/2"x1-1/2"x1/8" Triangulated Steel Tube Frame to Wall
 with Total (8) 1/2" Dia. Thru Bolts. Attach Each Reader Board Cabinet with (4) 3/8" Dia. Thru Bolts.

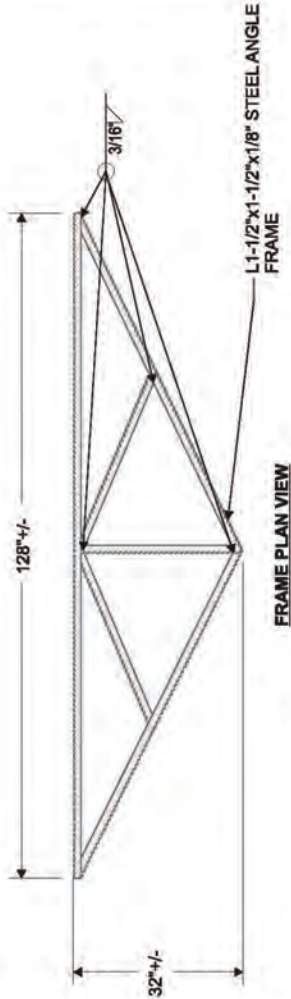

FRAME PLAN VIEW

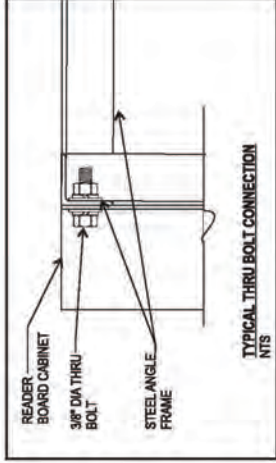

TYPICAL THRU BOLT CONNECTION
NTS

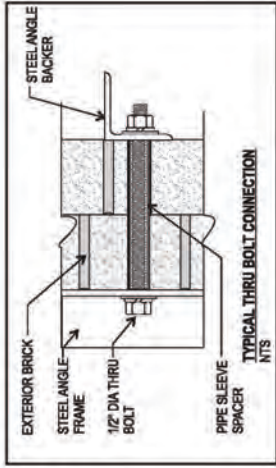

TYPICAL THRU BOLT CONNECTION
NTS

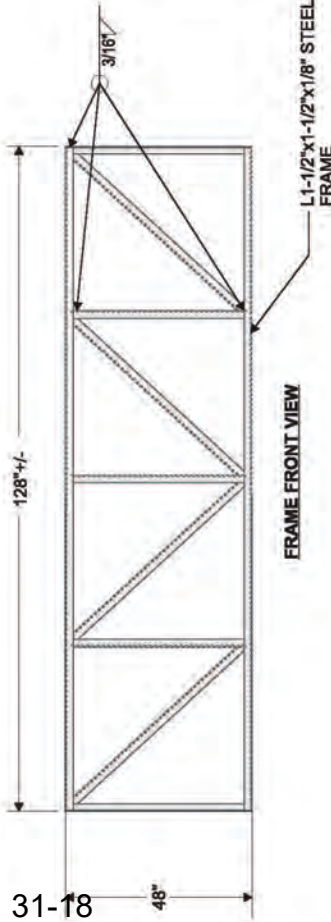

FRAME FRONT VIEW

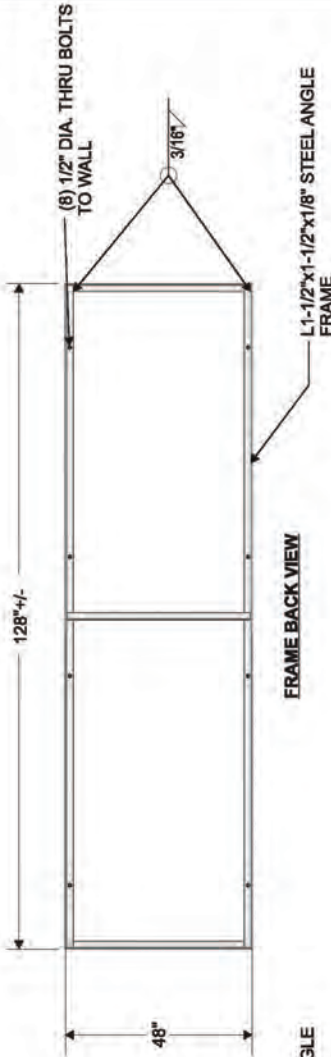

FRAME BACK VIEW

McFarland Engineering
 133 Edgewater Ct.
 Mooresville, NC 27058
 Structural Sign Design
 Engineering Services

THE BOMB FACTORY AT DEEP ELLUM
 Address: 2713 CANTON ST
 City/State: DALLAS, TX
 Client: LEGACY SIGNS OF TEXAS

Initial Drawing: 688171.DS
 ENGINEERING OF ATTACHMENT TO WALL ONLY.
 NO CABINET ENGINEERING OR EVALUATION OF AS BUILT WALL CONDITIONS PROVIDED OR IMPLIED.

DATE	BY	REV	NOTES
5-14-24	K	B6	ALL OUT MATERIAL AND THE EXISTING FOR MARKING SHOULD BE MAINTAINED UNLESS OTHERWISE NOTED
5-14-24	K	B7	ADD STEEL ANGLE BRACKETS TO WALL
5-24-24	K	B8	ADD STRUCTURE NOTES
6-10-24	K	B9	REMOVE FINISH AND LIGHTS TO BOTTOM CORNER
7-15-24	CP	B12	ADDED FINISH AND LIGHTS TO BOTTOM CORNER

Seal of the State of Texas
 Sean M. McFarland
 88579
 LICENSED PROFESSIONAL ENGINEER

The electronic and printed copies of this document are authorized by Sean M. McFarland, PE on March 20, 2024.
 Date: 3-20-2024
 Sheet #: 6 OF 6
 NC Firm Registration: F-118
 Texas Registration: 0202024
 Texas Firm Registration: F-8988

LEGACY SIGNS OF TEXAS

7923 E. McKinney St.
 Denton, TX 76208
 Office: 817.431.5700
 Fax: 817.431.5799

PRESENTATION DOCUMENT
 THE COLORS, SIZES AND PROPORTIONS INCLUDED IN THIS PRESENTATION DOCUMENT ARE THE PROPERTY OF LEGACY SIGNS OF TEXAS. ANY REPRODUCTION OR USE OF THIS DOCUMENT WITHOUT THE WRITTEN PERMISSION OF LEGACY SIGNS OF TEXAS IS PROHIBITED. PROPORTIONS MAY BE REQUIRED TO CHANGE UPON THE RESULTS OF A TECHNICAL SURVEY.

DATE	BY	REV	NOTES
5-14-24	K	B6	ALL OUT MATERIAL AND THE EXISTING FOR MARKING SHOULD BE MAINTAINED UNLESS OTHERWISE NOTED
5-14-24	K	B7	ADD STEEL ANGLE BRACKETS TO WALL
5-24-24	K	B8	ADD STRUCTURE NOTES
6-10-24	K	B9	REMOVE FINISH AND LIGHTS TO BOTTOM CORNER
7-15-24	CP	B12	ADDED FINISH AND LIGHTS TO BOTTOM CORNER

8
 THIS DRAWING PACKAGE IS THE PROPERTY OF LEGACY SIGNS OF TEXAS. BY ACCEPTING THIS DOCUMENT, RECEPT ASSUMES CUSTODY AND AGREES THAT THIS DOCUMENT WILL NOT BE REPRODUCED OR COPIED OR IN PART ITS CONTENTS REVEALED IN ANY MANNER OTHER THAN TO THE INTENDED PARTY WITHOUT EXPRESS WRITTEN PERMISSION FROM LEGACY SIGNS OF TEXAS. 817.431.5700