

PROJECT DATA TABLE	
TOTAL SITE AREA	0.99 AC (43,087 SF)
LAND USE	MULTIFAMILY RESIDENTIAL
MIN. FRONT YARD SETBACK BELOW 42' IN HEIGHT	15 FT
MIN. FRONT YARD SETBACK ABOVE 42' IN HEIGHT	45 FT
MIN. SIDE YARD SETBACK AT EASTERN PROPERTY LINE	15 FT
MIN. SIDE YARD SETBACK AT WESTERN PROPERTY LINE	10 FT
MIN. REAR YARD SETBACK	10 FT
MAX. BUILDING HEIGHT	185 FT (+16' FOR MECHANICAL SCREENING) (+26' FOR ELEVATOR OVERRUNS)
MAX. LOT COVERAGE BELOW 42' IN HEIGHT:	72%
MAX. LOT COVERAGE ABOVE 42' IN HEIGHT:	55%
MAX. UNIT COUNT	230
LOADING SPACES REQUIRED	2 MEDIUM (35' X 11') AS SHOWN ON THE DEVELOPMENT PLAN

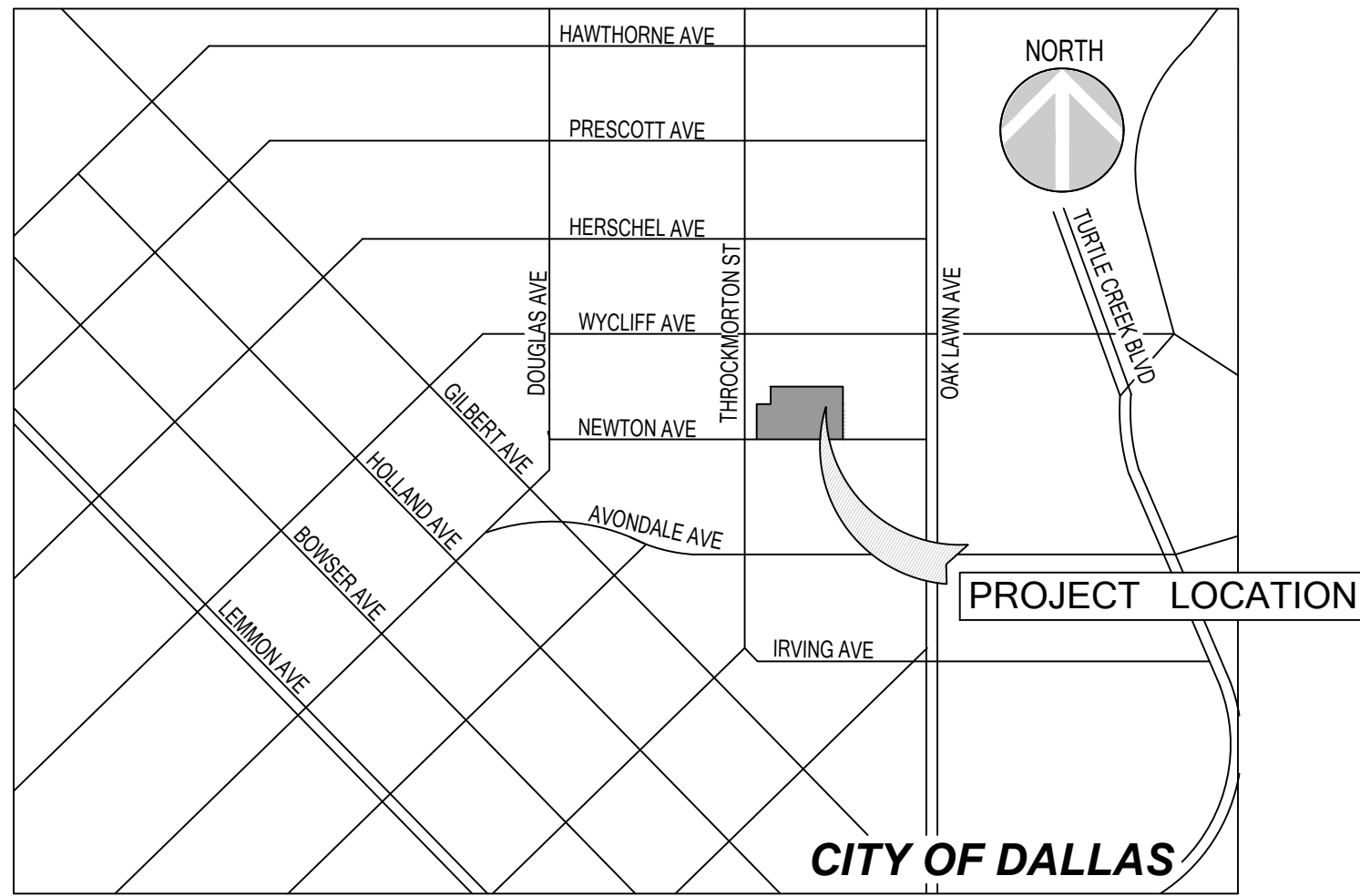

VICINITY MAP  
(NOT TO SCALE)

- EXTENT OF BUILDING LESS THAN 42' IN HEIGHT
- EXTENT OF BUILDING GREATER THAN 42' IN HEIGHT
- APPROXIMATE LOCATION OF PUBLIC OPEN SPACE, MUST FRONT NEWTON AVENUE

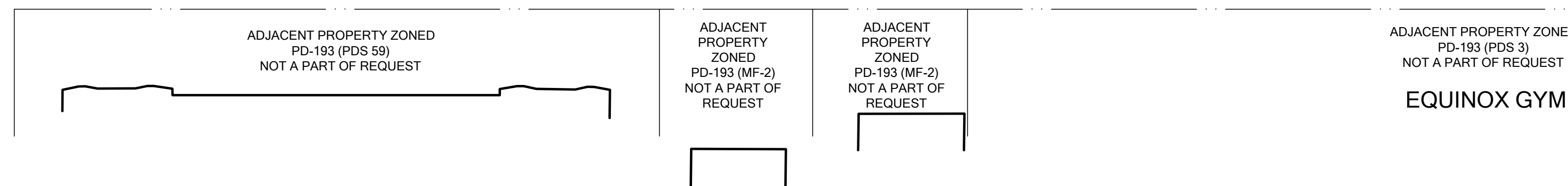
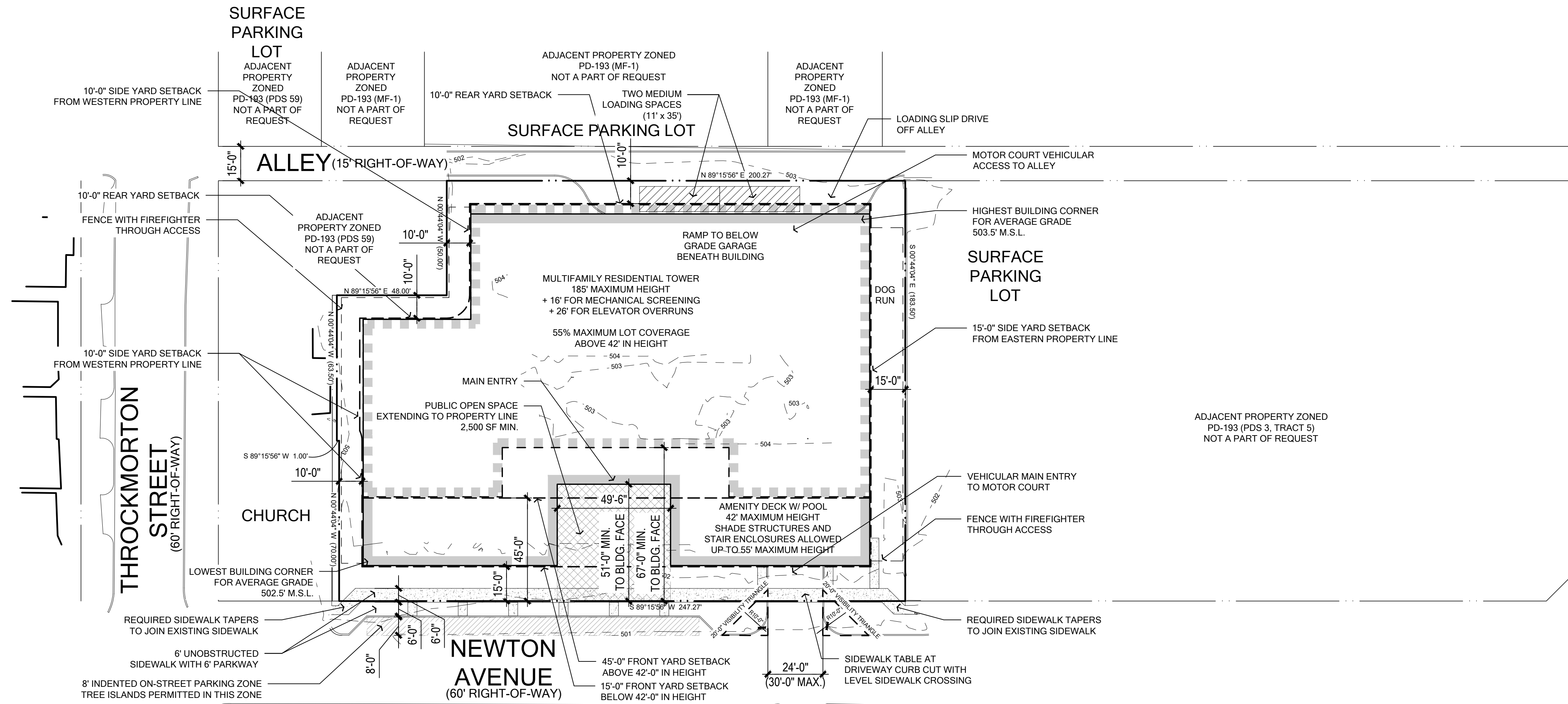

OAK LAWN AVENUE

