

THIS DOCUMENT, TOGETHER WITH THE CONCEPTS AND DESIGNS PRESENTED HEREIN, IS AN INSTRUMENT OF SERVICE. IT IS INTENDED ONLY FOR THE SPECIFIC PURPOSE AND CLIENT FOR WHICH IT WAS PREPARED. REUSE OF AND IMPROPER RELIANCE ON THIS DOCUMENT WITHOUT WRITTEN AUTHORIZATION AND ADAPTATION BY KIMLEY-HORN AND ASSOCIATES, INC. SHALL BE WITHOUT LIABILITY TO KIMLEY-HORN AND ASSOCIATES, INC.

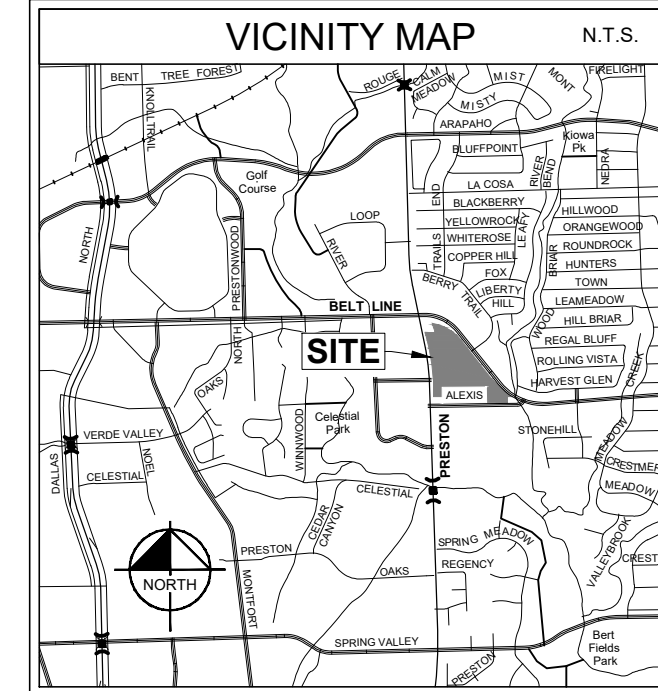
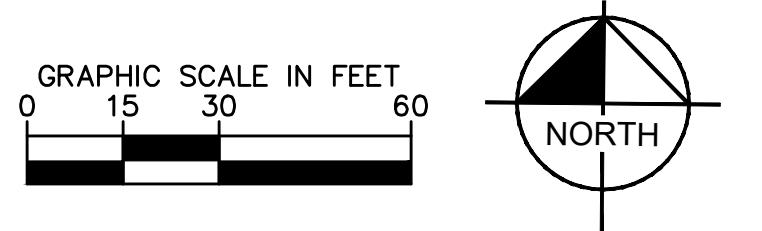
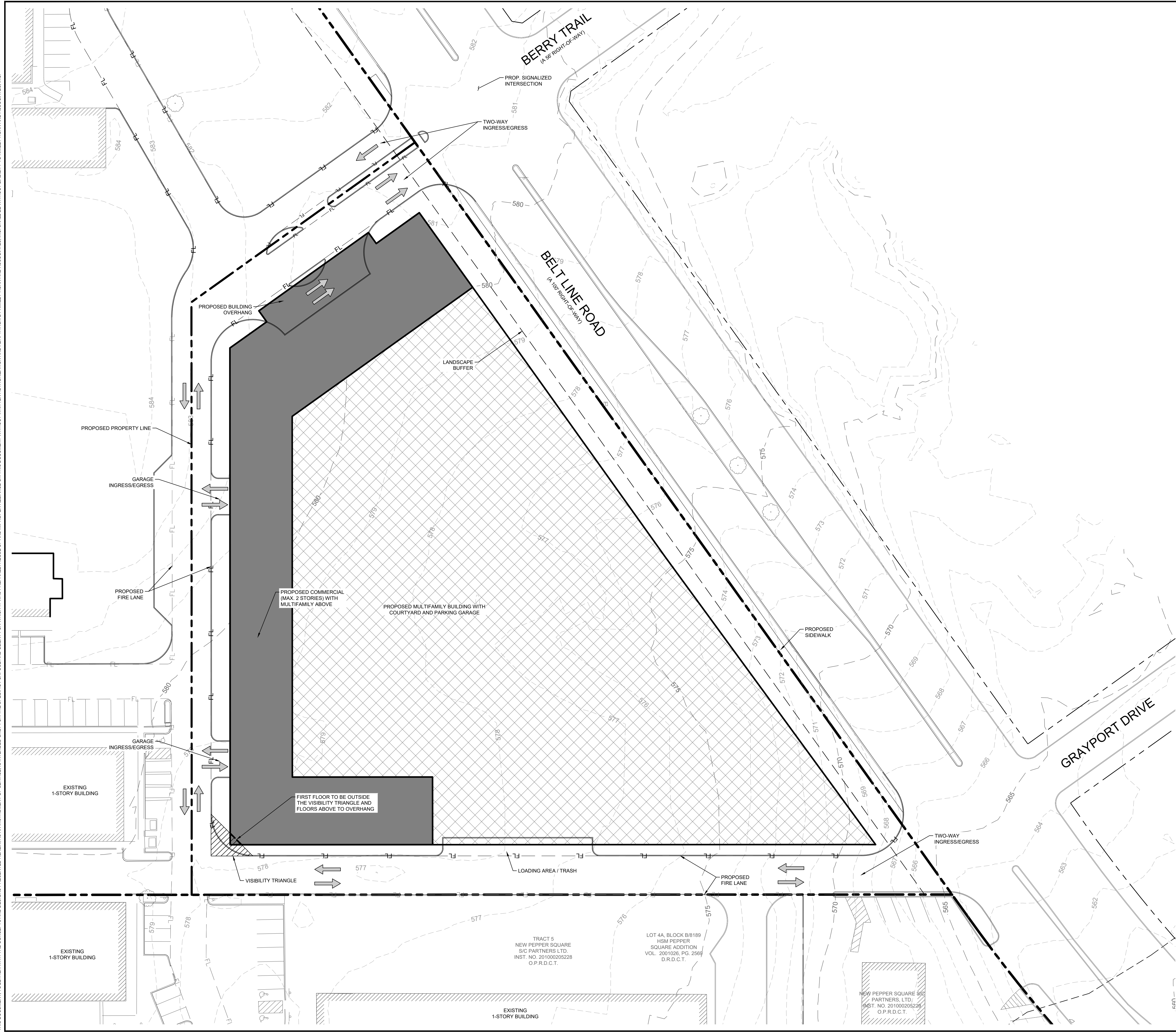

LEGEND

- PROPOSED PROPERTY LINE / LIMITS OF DEVELOPMENT PLAN
- EXISTING CONTOURS
- PROPOSED MULTIFAMILY BUILDING
- PROPOSED COMMERCIAL WITH MULTIFAMILY

SITE DATA SUMMARY TABLE

LOCATION	PRESTON ROAD AT BELT LINE ROAD, DALLAS, TX
EXISTING ZONING	CR - COMMUNITY RETAIL
OVERALL SITE AREA (GROSS)	3.63 AC. (158,256 SQ. FT.)
PROPOSED ZONING	PD - PLANNED DEVELOPMENT
CURRENT USE	RETAIL
PROPOSED USE	MULTIFAMILY + RETAIL
MAX BUILDING HEIGHT	75'
PROPOSED USE : MULTIFAMILY	
NUMBER OF UNITS (PHASE 1)	250 UNITS
NUMBER OF UNITS (OVERALL) PERMITTED TO DATE	250 UNITS
BUILDING COVERAGE	113,196 SQ. FT.

PARKING RATIOS
 SEE PD FOR PARKING REQUIREMENTS
 PROVIDED PARKING TO MEET THE REQUIREMENTS

DEVELOPMENT PLAN
 FOR
PEPPER SQUARE SHOPPING CENTER
ADDITION DALLAS, TEXAS
 DATE ISSUED: APRIL 12, 2024
 Z212-358

NO.	REVISIONS	DATE	BY

13455 NOEL ROAD, TWO GALLERIA OFFICE TOWER, SUITE 700
 DALLAS, TEXAS 75240
 PHONE: 972.770.9000 FAX: 972.695.8500
 TEXAS REGISTERED ENGINEERS FROM F-928

PROJECT NO.	063928006
DATE:	APR 2024
SCALE:	AS SHOWN
DESIGNED BY:	CRB
DRAWN BY:	AL
CHECKED BY:	SES

PEPPER SQUARE
 CITY OF DALLAS
 DALLAS COUNTY, TEXAS

DEVELOPMENT PLAN
 SHEET NUMBER
DEV