

Traffic Management Plan

Oak Hill Academy – High School

Z245-172(LL)

April 3, 2025

Introduction

The services of Lambeth Engineering Associates, PLLC, (herein Lambeth Engineering) were retained to conduct a traffic management plan (TMP) for Oak Hill Academy – High School (Oak Hill). The purpose of this TMP is to ensure safe vehicular and pedestrian circulation during peak morning drop-off and afternoon pick-up periods for Oak Hill's high school students at their new high school campus located in Cochran Chapel Church (educational building) at 9027 Midway Road in Dallas, Texas.

Oak Hill is planning to have a small growth over the course of several years.

Below is general information about Oak Hill.

School:

- Current Location: 9407 Midway Road, Dallas, Texas, 75220;
Oak Hill is located northwest of the W. Northwest Highway/Midway Road intersection. Pre-K through 12th grades are at the existing location.
- Future High School Location: 9027 Midway Road, Dallas, Texas, 75209;
The high school is being moved to the new location and Pre-K - 8th grades will remain at the current location.
The future Oak Hill Academy High School location is located southwest of the W. Northwest Highway/Midway Road intersection, located in Cochran Chapel Church.
- School District: Private School
- School Times:
 - Monday – Thursday: 8:00 AM – 3:30 PM
 - Friday: 8:00 AM – 2:30 PM

Zoning:

- Existing Zoning: R-10(A) and R-1ac(A)
- Proposed Zoning: SUP
- Project: Oak Hill is relocating their high school students from their current campus at 9407 Midway Road to Cochran Chapel Church at 9027 Midway Road.

Students:

- Existing High School Student Enrollment: 40 students in 9th – 12th grade
- Projected Student Enrollment:
 - Phase 1: 48 students in 9th – 12th grade
 - Buildout: 85 students in 9th – 12th grade
 - It is important to note that the planned growth will happen over time with natural growth. The school anticipates this could be a 5-year period to reach buildout, which would give the school ample time to adjust the traffic flow accordingly to ensure vehicles remain on site. **Table 1** summarizes the total number of students per grade

Table 1. Student Enrollment

Grade	Current Enrollment	Phase 1 Enrollment	Buildout Enrollment
9 th	9	12	22
10 th	10	12	21
11 th	5	12	21
12 th	16	12	21
9th - 12th:	40	48	85
Total:	40	48	85

School Access:

- Surrounding Roadways:
 - Midway Road: Four-lane, divided roadway
 - Northwest Highway (Loop 12): Six-lane, divided roadway
- Sidewalks are provided on both sides of Midway Road, adjacent to the school.

Traffic Management Plan

Queue

Lambeth Engineering met with Oak Hill staff and Brit Smart, Executive Director, during the process of developing the TMP. Traffic observations were conducted on the following dates and times:

- Monday, March 25, 2024 – PM Dismissal
- Tuesday, March 26, 2024 – AM Arrival
- Tuesday, March 26, 2024 – PM Dismissal
- Wednesday, March 27, 2024 – PM Dismissal

The peak queue of parent vehicles picking up students was observed to be about 18 vehicles. For planning purposes, a rate of one parent vehicle per 2.5 students is used for this TMP.

As expected, the peak period of parent vehicles accumulating at the school occurred during the afternoon dismissal period. All traffic clears the campus within ten (10) minutes once school is dismissed.

The projected vehicular accumulation is summarized in **Table 2** below. As shown, the proposed site plan has adequate space to accommodate all parent vehicles on-site.

Table 2. TMP Summary

Planned Student Capacity	Travel Modes	Loading Zone	Projected Parent Vehicles	Provided Queue Space for Parents On-Site	Surplus Availability for Parents On-Site
85 Students	Parents 100% Walkers 0% Buses 0%	9 th - 12 th	34 Veh. (799 Feet)	40 Veh. (941 Feet)	6 Veh. (142 Feet)
Grades	School Times				
9 th - 12 th	Beginning: 8:00 AM Dismissal: 3:30 PM (Monday - Thursdays) Dismissal: 2:30 PM (Fridays)				

Recommendations

The TMP recommendations are described below and shown in **Exhibits 1**.

Students

1. 9th – 12th Grade Students: Drop off and pick up on the north side of the school.
2. Students waiting for parents to pick them up should remain in the designated area and wait for their parents' arrival.
3. No students were observed walking home. All students are picked up by parent vehicle.

Parents

4. Parents pick up students in the following location:
 - a. 9th – 12th grade parents enter the middle driveway on Midway Road. Parents will join the queue lane, and students will unload/load at the designated area, to the north of the school. Parents will then exit via the center or southernmost school driveway.
 - b. Parents will not be allowed to park in the parking spaces behind the queue lanes during drop-off and pick-up.

Buses

5. No school buses are planned to serve Oak Hill.

Staff

6. Staff will continue monitoring students at the loading area where parents are picking up students until all students are dismissed.

7. If a student is not near the loading area when the parent arrives, staff will direct the parent to move forward so that other parents may approach the loading area and the queue line is not delayed.
8. Staff will direct parent vehicles to exit the southernmost driveway in the event parent vehicles begin to back up from waiting to turn left onto northbound Midway Road.

Licensed Peace Officers

9. A designated, licensed peace officer is not assigned to Oak Hill, and one is not recommended.

Parking Restrictions

10. Staff will notify parents not to park on Midway Road.
11. It is recommended that parents will not be allowed to park in spaces behind the queue lanes. If parents need to park, parents should park in the spaces away from the queue lane.

School Zones

12. Currently there is no school zone on Midway Road at the new campus.
13. No students are expected to walk to school. Therefore, a school zone is not recommended at this time. If students do walk to school in the future, a school zone should be considered.

Off-Site Improvements

14. Install "Do Not Enter" signs at the southern driveway entrance, as shown in the **Exhibit 1**.

Summary

The Oak Hill Academy Traffic Management Plan is designed to provide safe vehicular and pedestrian movement to and from school and can accommodate the projected vehicular queues on campus without blocking through traffic.

If traffic congestion or unsafe movements are noticed, or parent vehicles begin to back near to Midway Road, the plan should be reviewed and updated promptly.

END

REVIEW AND COMMITMENT

The Oak Hill Academy traffic management plan (TMP) was developed with the intent of optimizing safety and accommodating vehicular traffic queues generated during school peak hours. A concerted effort and full participation by the school administration are essential to maintain safe and efficient traffic operations.

By consent of this TMP submittal, the school administration agrees to the strategies presented herein for which the school is held responsible unless the City of Dallas deems further measures are appropriate.

The school is also committed to continually reviewing and assessing the effectiveness of this plan and if warranted, implementing changes in the interest of increasing safety and minimizing impacts on the surrounding community.

Brit Smart
Signature

Brit Smart
Name

10/29/2024
Date

10/29/2024
Title

Planned Student Capacity	Travel Modes	Loading Zone	Projected Parent Vehicles	Provided Queue Space for Parents On-Site	Surplus Availability for Parents On-Site
85 Students	Parents 100% Walkers 0% Buses 0%	9 th - 12 th	34 Veh. (799 Feet)	40 Veh. (941 Feet)	6 Veh. (142 Feet)
Grades	School Times				
9 th - 12 th	Beginning: 8:00 AM Dismissal: 3:30 PM (Monday - Thursdays) Dismissal: 2:30 PM (Fridays)				

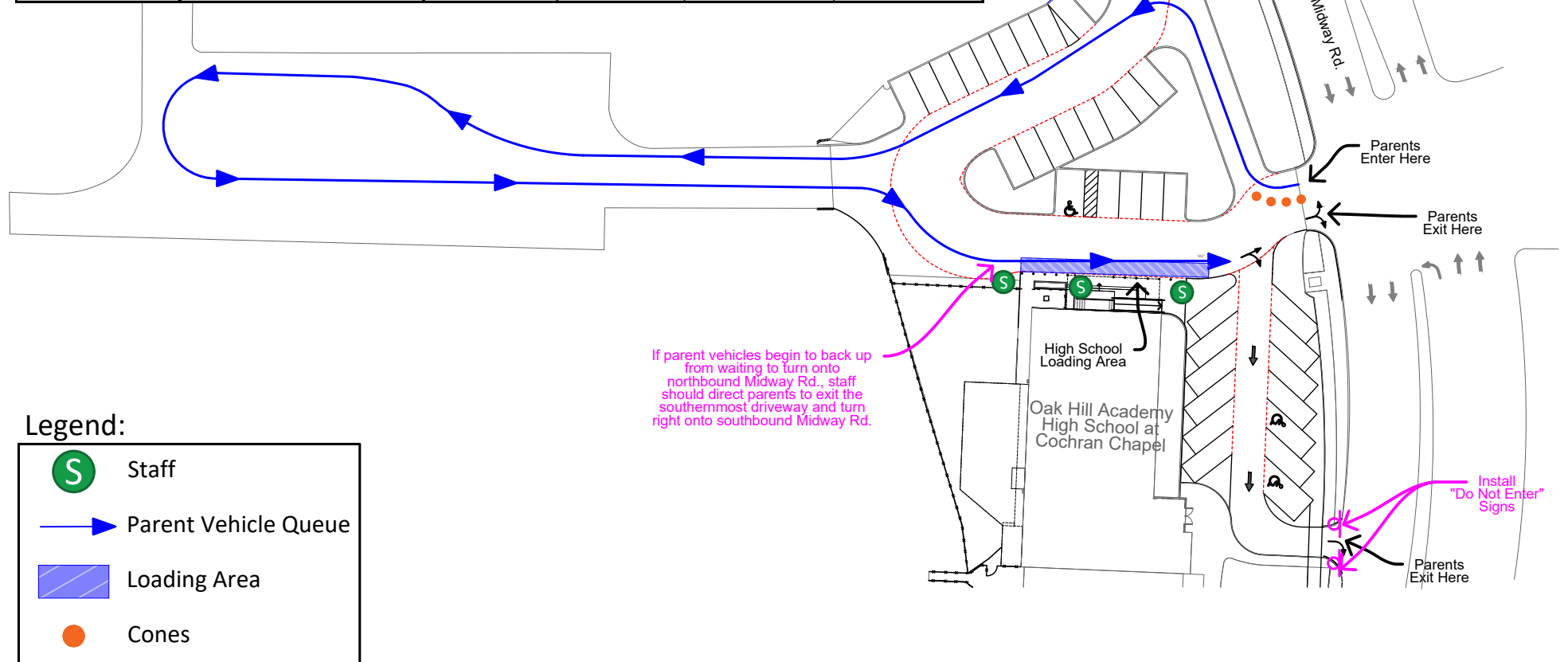

Legend:

	Staff
	Parent Vehicle Queue
	Loading Area
	Cones



1

Oak Hill Academy HS TMP