

CITY PLAN COMMISSION

THURSDAY, FEBRUARY 15, 2024

FILE NUMBER: S234-049

SENIOR PLANNER: Sharmila Shrestha

LOCATION: Reeder Road, north of Royal Lane

DATE FILED: January 18, 2024

ZONING: IR

CITY COUNCIL DISTRICT: 6

SIZE OF REQUEST: 0.2755-acres

APPLICANT/OWNER: Amjad Mitha

REQUEST: An application to create one 0.2755-acre lot from a tract of land in City Block 6548 on property located on Reeder Road, north of Royal Lane.

SUBDIVISION HISTORY: There has been no recent platting activity within close proximity to this request.

STAFF RECOMMENDATION: The request complies with the requirements of the IR Industrial/Research District; therefore, staff recommends approval of the request subject to compliance with the following conditions:

General Conditions:

1. The final plat must conform to all requirements of the Dallas Development Code, Texas Local Government Code, Texas Land Surveying Practices Act and the General Rules and Regulations of the Texas Board of Land Surveying.
2. Department of Development Services, Engineering Division must verify that the plat conforms with the water, wastewater, and easement requirements under the provisions of Chapter 49 of the Dallas City Code.
3. Compliance with all plans, contracts, ordinances, and requirements of the City of Dallas. *Section 51A-8.102(a), (b), (c), and (d)*
4. The number and location of fire hydrants must comply with the Dallas Fire Code.
5. Any new or existing structure may not extend across new property lines. *Section 51A-8.503(e)*
6. On the final plat, all easement abandonments, and ROW abandonments must be by separate instrument with the recording information shown on the face of the plat. A release from the Real Estate Division is required prior to the plat being submitted to the Chairman for signature.
7. On the final plat, include two boundary corners tagged with these coordinates: "Texas State Plane Coordinate System, North Central Zone, North American Datum of 1983 on Grid Coordinate values, No Scale and no Projection."
8. On the final plat, monument all set corners per the Monumentation Ordinance. Prior to submittal of the final plat for the Chairman's signature. The monuments must be verified by the Chief City Surveyors Office in the Public Works Department. *Section 51A-8.617*

9. Provide ALL supporting documentation (i.e. deeds, plats, ordinances, easements...etc) with a completed Final Plat Checklist to the Survey Plat Review Group (**SPRG**) with the Final Plat Submittal **after** City Plan Commission Approval.
10. Prior to the final plat, submit a tree survey to the Arborist. A release from the arborist is required prior to an early release request or the recordation of the plat, whichever occurs first.
11. The number of lots permitted by this plat is one.

Paving & Drainage Conditions:

12. Submit a full set of Civil Engineering Plans (drainage, paving, street signage/markings/lighting) prepared per City Standards by a licensed (TX) Professional Engineer to Engineering Division in Room 200, Oak Cliff Municipal Center (i.e. 311T/DP). Additions and alterations to the public infrastructure require approval and may require private development contracts with bonds. 51A-8.102 (c); 8.601(b)(4),(5),(6),(7),(8),(9)
13. Detention may be required if the capacity of available outfall is not adequate to carry the developed runoff. Section 51A-8.611(c).
14. Place a note on the final plat stating "Lot-to-Lot drainage will not be allowed without proper City of Dallas Engineering Division approval" 51A 8.611(e)

Right of Way Requirements:

15. On the final plat, dedicate 30 feet of right-of-way (via fee simple) from the established center line of Reeder Road. *Section 51A 8.602(c)*

Survey (SPRG) Conditions:

16. Prior to final plat, submit a completed final plat checklist and all supporting documents.
17. On the final plat, show the correct recording information for the subject property.
18. On the final plat, show how all adjoining right-of-way was created. Section 51A-8.403(a)(1)(A)(xxii).
19. On the final plat, show distances/width across all adjoining rights-of-way.
20. On the final plat, show recording information on all existing easements within 150 feet of the property.
21. On the final plat, show all additions or tracts of land within 150 feet of the property with recording information.

Dallas Water Utilities Conditions:

22. Additional design information is required for assessment. Site plan must be submitted showing proposed development, building finished floor elevation, development, existing mains – including downstream manhole, and proposed water and wastewater service locations. Submit water/wastewater engineering

plans to 320 E. Jefferson Blvd., Room 200, Attention: Water and Wastewater Engineering.

23. Engineer must furnish plans for water and sanitary sewer. Developer must furnish a contract for water and sanitary sewer. Sections 49-60(g)(1) and (2) and 49-62(b), (c), and (f).
24. Water main improvements is required by Private Development Contract. Submit water/wastewater Engineering Plans to 320 E. Jefferson Blvd., Room 200, Attention: Water and Wastewater Engineering.

Real Estate/ Street Name / GIS, Lot & Block Conditions:

25. Prior to the final plat, remove fence shown on the plat in right-of-way on Reeder Road. Provide pictures or documentation that shows the fence has been removed from Reeder Road.
26. On the final plat, change “Sprowles Street” to “Stemmons Freeway/ Interstate Highway No. 35E”.
27. On the final plat, identify the property as Lot 1 in City Block C/6548.

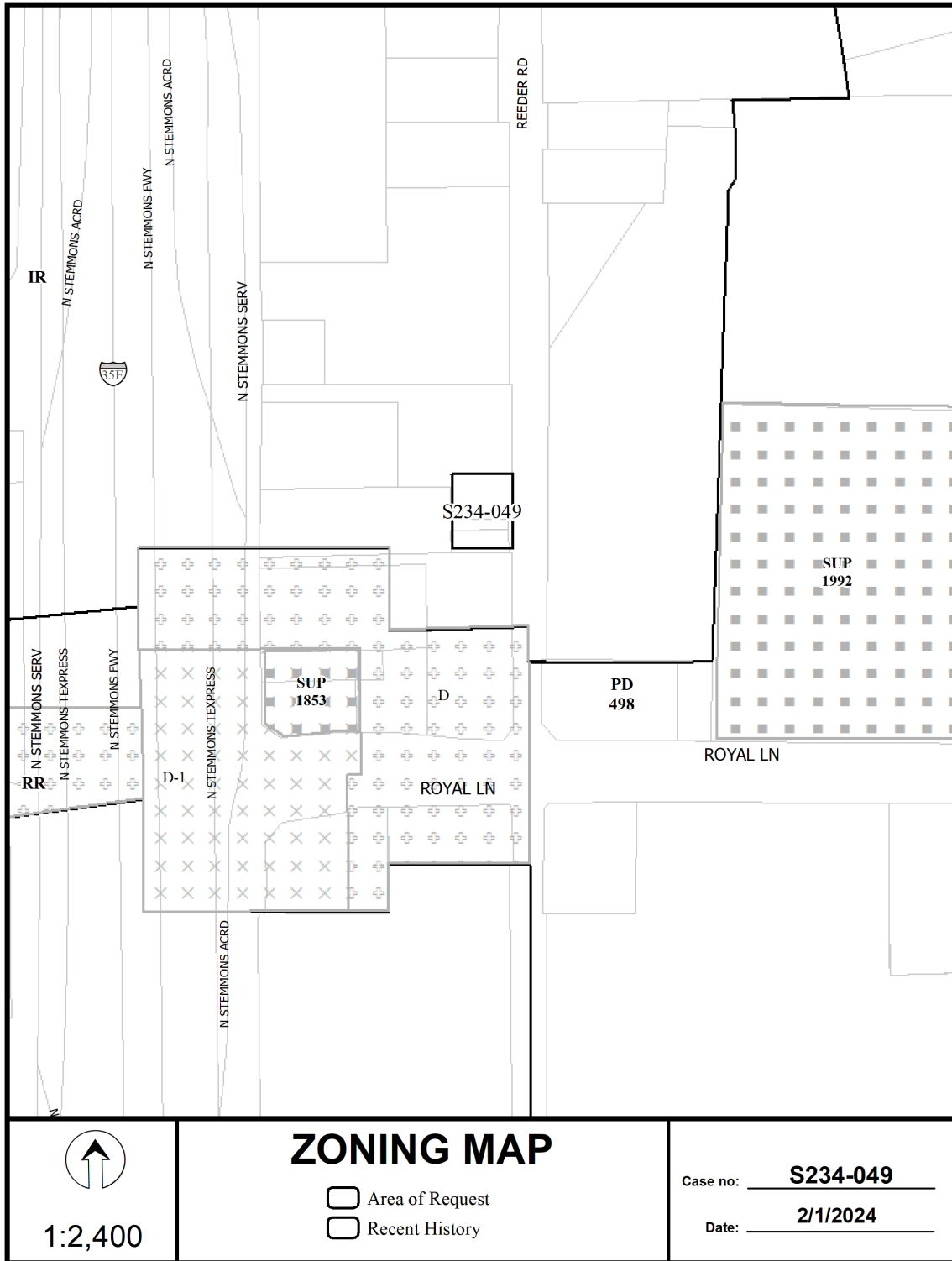



 1:2,400	<h2 style="text-align: center;">AERIAL MAP</h2> <p> <input type="checkbox"/> Area of Request <input type="checkbox"/> Recent History </p>	Case no: <u> S234-049 </u> Date: <u> 2/1/2024 </u>
--	--	---

