

**SITE LEGEND**

- PROPERTY LINE
- - - EASEMENT
- ▲— EDGE OF ASPHALT
- OHE— EXISTING OVERHEAD ELECTRIC
- - - EXISTING PROPERTY
- TRACT 1: PROPOSED SINGLE-FAMILY RESIDENTIAL (15.21 ACRES, 90 LOTS)
- TRACT 2: PROPOSED EDCCG COMMERCIAL (3.24 ACRES)
- TRACT 3: OPEN SPACE - DEVELOPMENT PROHIBITED EXCEPT FOR UNDERGROUND UTILITIES (11.44 ACRES)

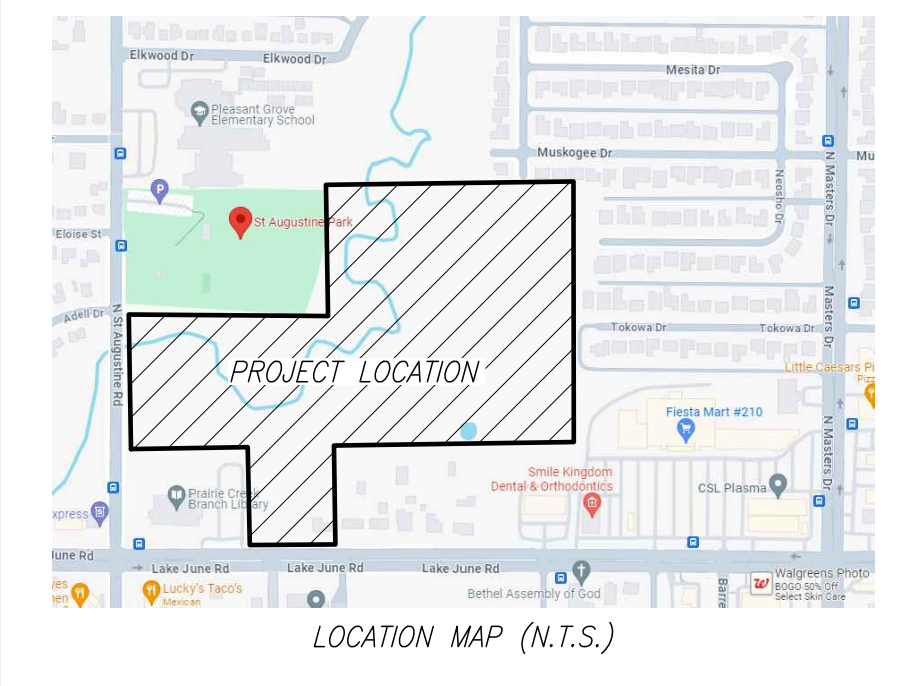

**GENERAL NOTES:**

1. ACCORDING TO THE FEDERAL EMERGENCY MANAGEMENT AGENCY, FLOOD INSURANCE RATE MAP NUMBER 48113C0370K DATED JULY 07, 2014, DALLAS COUNTY, TEXAS, UNINCORPORATED AREAS, THIS LOT IS WITHIN A SPECIAL FLOOD HAZARD AREA WITH BASE FLOOD ELEVATIONS.

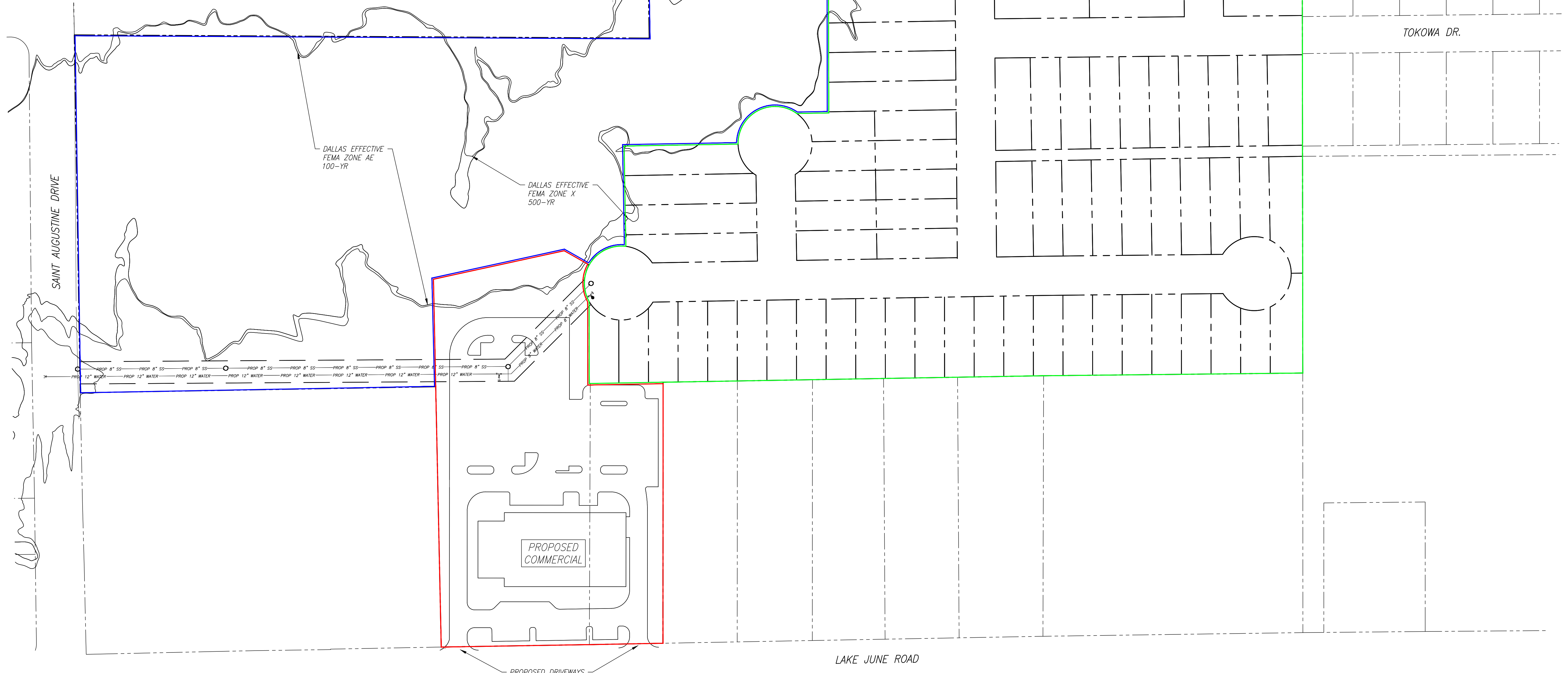
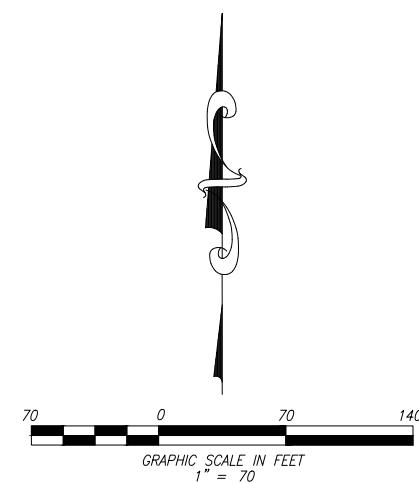

REVISIONS		
#	REVISION	DATE

DEVELOPER/OWNER:  
 GREENLEAF VENTURES, LLC  
 11700 PRESTON ROAD  
 DALLAS, TEXAS 75230  
 (214) 755-9905

CONCEPTUAL PLAN  
 EXHIBIT A

LAKE JUNE RESIDENTIAL DEVELOPMENT  
 BLOCK 6715  
 SOLOMON CARVER SURVEY  
 ABSTRACT NO. 260  
 CITY OF DALLAS  
 DALLAS COUNTY, TEXAS

**HSE HANNA SURVEYING & ENGINEERING LLC.**  
 HANNA SURVEYING AND ENGINEERING, L.L.C.  
 11729 E. FM 917  
 ALVARADO, TX 76009  
 (682) 553-9474

ENGINEERING FIRM NUMBER F-22119  
 SURVEYING FIRM NUMBER 10194633  
 SAM@HANNA-SE.COM

PRELIMINARY FOR REVIEW ONLY  
 THESE DOCUMENTS ARE FOR DESIGN REVIEW AND NOT INTENDED FOR CONSTRUCTION, BIDDING OR PERMIT PURPOSES. THEY WERE PREPARED BY, OR UNDER THE SUPERVISION OF:  
 SAMUEL C. HANNA  
 P.E.# 109945

ISSUE DATE:  
 JULY 1, 2024  
 PROJECT NO.:  
 20-001

SHEET NUMBER  
**C-1.0**  
 1 OF 1