

**PLANT SCHEDULE PHASE 1**

SHRUBS	CITY	BOTANICAL / COMMON NAME	CONT.	HT.	REMARKS
10		Gleditsia triacanthos / Argentine	29	2-3'	
9		Iron treebush / Lady Banks Rose	29	2-4'	
8		Trachypogon aristatus / Confederate Jasmine	29	2-3'	

CONT. 1.0% of  
1.0% of  
Material: decomposed granite / Decomposed Granite  
ROCK





CITY OF DALLAS

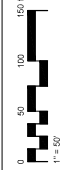

**IRRIGATION NOTES**

1. SHOW IRRIGATION PIPING AS NEEDED TO PROVIDE GPM INDICATION FOR BACKGROUND VIEWS AT ENTRY, TRELLIS, TRELLIS, AND WALKWAY.
2. CAP ANY EXISTING IRRIGATION IN PIPING.
3. VERIFY ALL IRRIGATION PIPING IS INSTALLED AND WORKING.
4. VERIFY ALL IRRIGATION PIPING IS INSTALLED AND WORKING BEFORE ANY IRRIGATION EQUIPMENT IS DAMAGED DURING CONSTRUCTION.



HARWOOD INTERNATIONAL  
ARCHITECT

201 HARKWOOD ST  
DALLAS, TX 75201  
PHONE: 214.922.1111  
FAX: 214.922.1112  
WWW.HARWOODINTERNATIONAL.COM

**CONSTRUCTION MANAGEMENT**  
HARWOOD CONTRACTING  
CONTRACT MANAGER: JAMES HARWOOD  
PHONE: 214.922.1111  
FAX: 214.922.1112  
WWW.HARWOODINTERNATIONAL.COM

**CONTRACTOR**  
HARWOOD CONTRACTING  
CONTRACT MANAGER: JAMES HARWOOD  
PHONE: 214.922.1111  
FAX: 214.922.1112  
WWW.HARWOODINTERNATIONAL.COM

**CIVIL**  
HARWOOD CONTRACTING  
CONTRACT MANAGER: JAMES HARWOOD  
PHONE: 214.922.1111  
FAX: 214.922.1112  
WWW.HARWOODINTERNATIONAL.COM

**STRUCTURAL**  
LA PAGES PARTNERS INC.  
CONTRACT MANAGER: MICHAEL A. PAGES, P.E.  
PHONE: 214.677.1276  
FAX: 214.677.1277  
WWW.LAPAGES.COM

**MEP**  
HARWOOD CONTRACTING  
CONTRACT MANAGER: JAMES HARWOOD  
PHONE: 214.922.1111  
FAX: 214.922.1112  
WWW.HARWOODINTERNATIONAL.COM

**MECHANICAL**  
HARWOOD CONTRACTING  
CONTRACT MANAGER: JAMES HARWOOD  
PHONE: 214.922.1111  
FAX: 214.922.1112  
WWW.HARWOODINTERNATIONAL.COM

**ELECTRICAL**  
HARWOOD CONTRACTING  
CONTRACT MANAGER: JAMES HARWOOD  
PHONE: 214.922.1111  
FAX: 214.922.1112  
WWW.HARWOODINTERNATIONAL.COM

**PLUMBING**  
HARWOOD CONTRACTING  
CONTRACT MANAGER: JAMES HARWOOD  
PHONE: 214.922.1111  
FAX: 214.922.1112  
WWW.HARWOODINTERNATIONAL.COM

**PLUMBING**  
HARWOOD CONTRACTING  
CONTRACT MANAGER: JAMES HARWOOD  
PHONE: 214.922.1111  
FAX: 214.922.1112  
WWW.HARWOODINTERNATIONAL.COM

**ELECTRICAL**  
HARWOOD CONTRACTING  
CONTRACT MANAGER: JAMES HARWOOD  
PHONE: 214.922.1111  
FAX: 214.922.1112  
WWW.HARWOODINTERNATIONAL.COM

**ELECTRICAL**  
HARWOOD CONTRACTING  
CONTRACT MANAGER: JAMES HARWOOD  
PHONE: 214.922.1111  
FAX: 214.922.1112  
WWW.HARWOODINTERNATIONAL.COM

**ELECTRICAL**  
HARWOOD CONTRACTING  
CONTRACT MANAGER: JAMES HARWOOD  
PHONE: 214.922.1111  
FAX: 214.922.1112  
WWW.HARWOODINTERNATIONAL.COM

**ELECTRICAL**  
HARWOOD CONTRACTING  
CONTRACT MANAGER: JAMES HARWOOD  
PHONE: 214.922.1111  
FAX: 214.922.1112  
WWW.HARWOODINTERNATIONAL.COM

**REFERENCE NOTES SCHEDULE**

ITEM	DESCRIPTION	QUANTITY	UNIT
1	PLANTING ACCESSORIES		
2	PLANTING ACCESSORIES		
3	PLANTING ACCESSORIES		
4	PLANTING ACCESSORIES		
5	PLANTING ACCESSORIES		
6	PLANTING ACCESSORIES		
7	PLANTING ACCESSORIES		
8	PLANTING ACCESSORIES		
9	PLANTING ACCESSORIES		
10	PLANTING ACCESSORIES		
11	PLANTING ACCESSORIES		
12	PLANTING ACCESSORIES		
13	PLANTING ACCESSORIES		
14	PLANTING ACCESSORIES		
15	PLANTING ACCESSORIES		
16	PLANTING ACCESSORIES		
17	PLANTING ACCESSORIES		
18	PLANTING ACCESSORIES		
19	PLANTING ACCESSORIES		
20	PLANTING ACCESSORIES		

**PLANT SCHEDULE PHASE 2**

SPACING	QTY	BOTANICAL / COMMON NAME	CONT.	SPACING	REMARKS
3' gal.	3 gal.	California populus / American Redbud	3 gal.	3' gal.	1' to 2' tall
3' gal.	3 gal.	Mahoe / Backstop / Pink Sap	3 gal.	3' gal.	1' to 2' tall
3' gal.	3 gal.	Sakaki / Japanese Camellia	3 gal.	3' gal.	1' to 2' tall
3' gal.	3 gal.	Sakaki / Japanese Camellia	3 gal.	3' gal.	1' to 2' tall
3' gal.	3 gal.	Syngonium podocarpus / Cordoba	3 gal.	3' gal.	1' to 2' tall
3' gal.	3 gal.	Syngonium podocarpus / Cordoba	3 gal.	3' gal.	1' to 2' tall
3' gal.	3 gal.	Syngonium podocarpus / Cordoba	3 gal.	3' gal.	1' to 2' tall
3' gal.	3 gal.	Syngonium podocarpus / Cordoba	3 gal.	3' gal.	1' to 2' tall
3' gal.	3 gal.	Syngonium podocarpus / Cordoba	3 gal.	3' gal.	1' to 2' tall
3' gal.	3 gal.	Syngonium podocarpus / Cordoba	3 gal.	3' gal.	1' to 2' tall
3' gal.	3 gal.	Syngonium podocarpus / Cordoba	3 gal.	3' gal.	1' to 2' tall
3' gal.	3 gal.	Syngonium podocarpus / Cordoba	3 gal.	3' gal.	1' to 2' tall
3' gal.	3 gal.	Syngonium podocarpus / Cordoba	3 gal.	3' gal.	1' to 2' tall
3' gal.	3 gal.	Syngonium podocarpus / Cordoba	3 gal.	3' gal.	1' to 2' tall
3' gal.	3 gal.	Syngonium podocarpus / Cordoba	3 gal.	3' gal.	1' to 2' tall
3' gal.	3 gal.	Syngonium podocarpus / Cordoba	3 gal.	3' gal.	1' to 2' tall
3' gal.	3 gal.	Syngonium podocarpus / Cordoba	3 gal.	3' gal.	1' to 2' tall
3' gal.	3 gal.	Syngonium podocarpus / Cordoba	3 gal.	3' gal.	1' to 2' tall

**PLANTING ACCESSORIES**

ITEM	DESCRIPTION	QUANTITY	UNIT
1	PLANTING ACCESSORIES		
2	PLANTING ACCESSORIES		
3	PLANTING ACCESSORIES		
4	PLANTING ACCESSORIES		
5	PLANTING ACCESSORIES		
6	PLANTING ACCESSORIES		
7	PLANTING ACCESSORIES		
8	PLANTING ACCESSORIES		
9	PLANTING ACCESSORIES		
10	PLANTING ACCESSORIES		
11	PLANTING ACCESSORIES		
12	PLANTING ACCESSORIES		
13	PLANTING ACCESSORIES		
14	PLANTING ACCESSORIES		
15	PLANTING ACCESSORIES		
16	PLANTING ACCESSORIES		
17	PLANTING ACCESSORIES		
18	PLANTING ACCESSORIES		
19	PLANTING ACCESSORIES		
20	PLANTING ACCESSORIES		

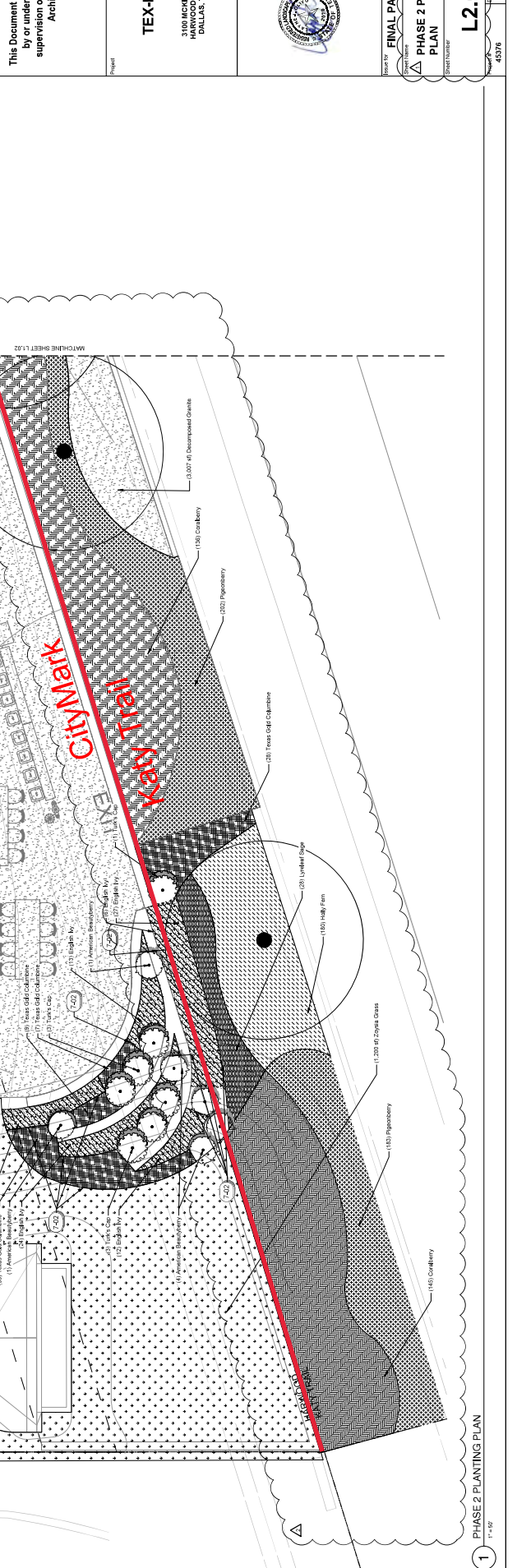

1 PHASE 2 PLANTING PLAN  
1" = 40'

This Document was produced by or under the direct supervision of Registered Architect

**TEX-MEX**  
1701 JACKSON ST.  
HARWOOD DISTRICT  
DALLAS, TX 75201

0022-06-20

FINAL PACKAGE  
PHASE 2 PLANTING PLAN  
L2.02



**HARWOOD INTERNATIONAL ARCHITECT**  
 14103 CHERRY HILLS DRIVE  
 SUITE 100 DALLAS, TX 75244  
 PHONE: 214.343.4444  
 FAX: 214.343.4445  
 WWW.HARWOODINTERNATIONAL.COM

**HDF**  
 ARCHITECTURE  
 INTERIORS  
 DEVELOPMENT  
 ADDRESS: 2801 MARKWOOD  
 SUITE 100 DALLAS, TX 75228  
 PHONE: 214.343.4444  
 FAX: 214.343.4445  
 WWW.HARWOODINTERNATIONAL.COM

**CONSTRUCTION MANAGEMENT**  
 COMPANY: HARWOOD CONSTRUCTION  
 CONTACT: JAMES HARWOOD  
 EMAIL: JAMES@HARWOOD.COM

**CIVIL**  
 COMPANY: H&F ASSOCIATES INC.  
 CONTACT: BRIAN SATARVA PE  
 EMAIL: BSATARVA@H&F.COM

**STRUCTURAL**  
 COMPANY: L.A. PRESS PARTNERS INC.  
 CONTACT: MORGAN SMITH P.E.  
 EMAIL: SMITH@LAPRESS.COM

**MEP**  
 COMPANY: RMB ENGINEERS  
 CONTACT: RMB ENGINEERS  
 EMAIL: RMB@RMBENGINEERS.COM

**MECHANICAL/ELECTRICAL**  
 COMPANY: RMB ENGINEERS  
 CONTACT: RMB ENGINEERS  
 EMAIL: RMB@RMBENGINEERS.COM

**PLUMBING**  
 COMPANY: RMB ENGINEERS  
 CONTACT: RMB ENGINEERS  
 EMAIL: RMB@RMBENGINEERS.COM

NO.	DATE	DESCRIPTION
1	06/20/2022	ISSUED FOR PERMIT
2	06/20/2022	REVISIONS
3	06/20/2022	DESIGN CLARIFICATION

This Document was produced by or under the direct supervision of Registered Architect

**TEX-MEX**  
 1700 JACKSON AT HARWOOD DISTRICT  
 DALLAS, TX 75201



**FINAL PACKAGE**  
 LANDSCAPE PLAN  
 SHEET NUMBER: L1.00  
 DRAWING DATE: 06/20/2022  
 PROJECT NO: 45074

CITY OF DALLAS

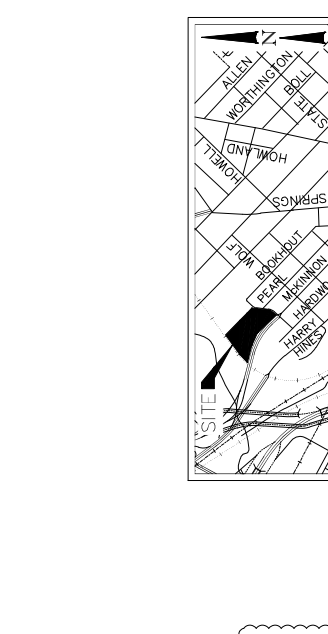
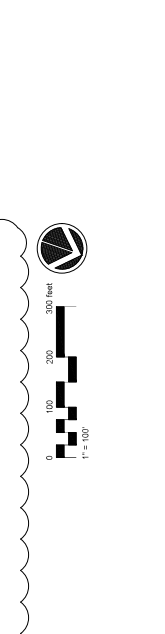
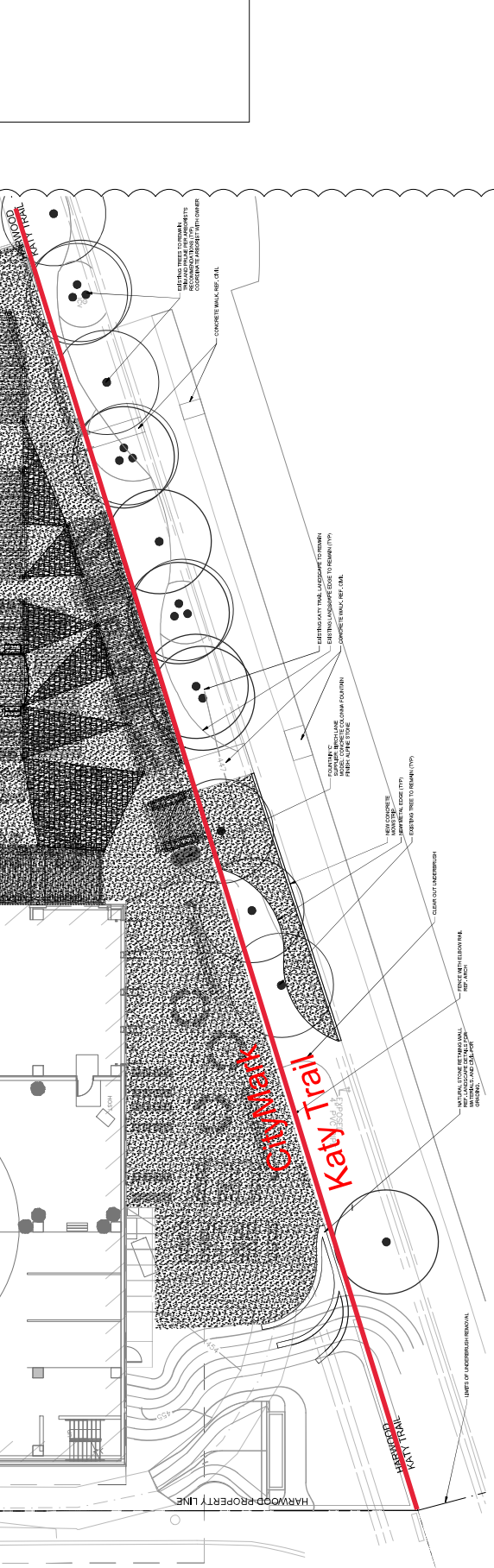

**PLANTING NOTES**

1. BEFORE CONSTRUCTION, THE LANDSCAPE CONTRACTOR SHALL BE RESPONSIBLE FOR VERIFYING THE TREE AND SHRUB SPECIFICATIONS AND THE EXISTING UTILITIES. THE LANDSCAPE CONTRACTOR SHALL MAINTAIN ALL EXISTING UTILITIES AND PROVIDE PROTECTION TO ALL UTILITIES AND SERVICE LINES. THE LANDSCAPE CONTRACTOR SHALL BE RESPONSIBLE FOR OBTAINING ALL NECESSARY PERMITS AND APPROVALS FROM THE CITY OF DALLAS AND THE UTILITY COMPANIES. THE LANDSCAPE CONTRACTOR SHALL BE RESPONSIBLE FOR OBTAINING ALL NECESSARY PERMITS AND APPROVALS FROM THE CITY OF DALLAS AND THE UTILITY COMPANIES.
2. ALL PLANTING SHALL BE INSTALLED IN ACCORDANCE WITH THE CITY OF DALLAS LANDSCAPE SPECIFICATIONS AND THE LANDSCAPE CONTRACTOR SHALL BE RESPONSIBLE FOR OBTAINING ALL NECESSARY PERMITS AND APPROVALS FROM THE CITY OF DALLAS AND THE UTILITY COMPANIES.
3. ALL PLANTING SHALL BE INSTALLED IN ACCORDANCE WITH THE CITY OF DALLAS LANDSCAPE SPECIFICATIONS AND THE LANDSCAPE CONTRACTOR SHALL BE RESPONSIBLE FOR OBTAINING ALL NECESSARY PERMITS AND APPROVALS FROM THE CITY OF DALLAS AND THE UTILITY COMPANIES.
4. ALL PLANTING SHALL BE INSTALLED IN ACCORDANCE WITH THE CITY OF DALLAS LANDSCAPE SPECIFICATIONS AND THE LANDSCAPE CONTRACTOR SHALL BE RESPONSIBLE FOR OBTAINING ALL NECESSARY PERMITS AND APPROVALS FROM THE CITY OF DALLAS AND THE UTILITY COMPANIES.
5. ALL PLANTING SHALL BE INSTALLED IN ACCORDANCE WITH THE CITY OF DALLAS LANDSCAPE SPECIFICATIONS AND THE LANDSCAPE CONTRACTOR SHALL BE RESPONSIBLE FOR OBTAINING ALL NECESSARY PERMITS AND APPROVALS FROM THE CITY OF DALLAS AND THE UTILITY COMPANIES.
6. ALL PLANTING SHALL BE INSTALLED IN ACCORDANCE WITH THE CITY OF DALLAS LANDSCAPE SPECIFICATIONS AND THE LANDSCAPE CONTRACTOR SHALL BE RESPONSIBLE FOR OBTAINING ALL NECESSARY PERMITS AND APPROVALS FROM THE CITY OF DALLAS AND THE UTILITY COMPANIES.
7. ALL PLANTING SHALL BE INSTALLED IN ACCORDANCE WITH THE CITY OF DALLAS LANDSCAPE SPECIFICATIONS AND THE LANDSCAPE CONTRACTOR SHALL BE RESPONSIBLE FOR OBTAINING ALL NECESSARY PERMITS AND APPROVALS FROM THE CITY OF DALLAS AND THE UTILITY COMPANIES.
8. ALL PLANTING SHALL BE INSTALLED IN ACCORDANCE WITH THE CITY OF DALLAS LANDSCAPE SPECIFICATIONS AND THE LANDSCAPE CONTRACTOR SHALL BE RESPONSIBLE FOR OBTAINING ALL NECESSARY PERMITS AND APPROVALS FROM THE CITY OF DALLAS AND THE UTILITY COMPANIES.
9. ALL PLANTING SHALL BE INSTALLED IN ACCORDANCE WITH THE CITY OF DALLAS LANDSCAPE SPECIFICATIONS AND THE LANDSCAPE CONTRACTOR SHALL BE RESPONSIBLE FOR OBTAINING ALL NECESSARY PERMITS AND APPROVALS FROM THE CITY OF DALLAS AND THE UTILITY COMPANIES.
10. ALL PLANTING SHALL BE INSTALLED IN ACCORDANCE WITH THE CITY OF DALLAS LANDSCAPE SPECIFICATIONS AND THE LANDSCAPE CONTRACTOR SHALL BE RESPONSIBLE FOR OBTAINING ALL NECESSARY PERMITS AND APPROVALS FROM THE CITY OF DALLAS AND THE UTILITY COMPANIES.
11. ALL PLANTING SHALL BE INSTALLED IN ACCORDANCE WITH THE CITY OF DALLAS LANDSCAPE SPECIFICATIONS AND THE LANDSCAPE CONTRACTOR SHALL BE RESPONSIBLE FOR OBTAINING ALL NECESSARY PERMITS AND APPROVALS FROM THE CITY OF DALLAS AND THE UTILITY COMPANIES.
12. ALL PLANTING SHALL BE INSTALLED IN ACCORDANCE WITH THE CITY OF DALLAS LANDSCAPE SPECIFICATIONS AND THE LANDSCAPE CONTRACTOR SHALL BE RESPONSIBLE FOR OBTAINING ALL NECESSARY PERMITS AND APPROVALS FROM THE CITY OF DALLAS AND THE UTILITY COMPANIES.
13. ALL PLANTING SHALL BE INSTALLED IN ACCORDANCE WITH THE CITY OF DALLAS LANDSCAPE SPECIFICATIONS AND THE LANDSCAPE CONTRACTOR SHALL BE RESPONSIBLE FOR OBTAINING ALL NECESSARY PERMITS AND APPROVALS FROM THE CITY OF DALLAS AND THE UTILITY COMPANIES.
14. ALL PLANTING SHALL BE INSTALLED IN ACCORDANCE WITH THE CITY OF DALLAS LANDSCAPE SPECIFICATIONS AND THE LANDSCAPE CONTRACTOR SHALL BE RESPONSIBLE FOR OBTAINING ALL NECESSARY PERMITS AND APPROVALS FROM THE CITY OF DALLAS AND THE UTILITY COMPANIES.
15. ALL PLANTING SHALL BE INSTALLED IN ACCORDANCE WITH THE CITY OF DALLAS LANDSCAPE SPECIFICATIONS AND THE LANDSCAPE CONTRACTOR SHALL BE RESPONSIBLE FOR OBTAINING ALL NECESSARY PERMITS AND APPROVALS FROM THE CITY OF DALLAS AND THE UTILITY COMPANIES.
16. ALL PLANTING SHALL BE INSTALLED IN ACCORDANCE WITH THE CITY OF DALLAS LANDSCAPE SPECIFICATIONS AND THE LANDSCAPE CONTRACTOR SHALL BE RESPONSIBLE FOR OBTAINING ALL NECESSARY PERMITS AND APPROVALS FROM THE CITY OF DALLAS AND THE UTILITY COMPANIES.

**DEMOLITION NOTES**

1. CONTRACTOR SHALL VERIFY LOCATIONS OF ALL UTILITIES PRIOR TO COMMENCING WORK.
2. CONTRACTOR SHALL BE RESPONSIBLE FOR OBTAINING ALL NECESSARY PERMITS AND APPROVALS FROM THE CITY OF DALLAS AND THE UTILITY COMPANIES.
3. CONTRACTOR SHALL BE RESPONSIBLE FOR OBTAINING ALL NECESSARY PERMITS AND APPROVALS FROM THE CITY OF DALLAS AND THE UTILITY COMPANIES.
4. CONTRACTOR SHALL BE RESPONSIBLE FOR OBTAINING ALL NECESSARY PERMITS AND APPROVALS FROM THE CITY OF DALLAS AND THE UTILITY COMPANIES.
5. CONTRACTOR SHALL BE RESPONSIBLE FOR OBTAINING ALL NECESSARY PERMITS AND APPROVALS FROM THE CITY OF DALLAS AND THE UTILITY COMPANIES.
6. CONTRACTOR SHALL BE RESPONSIBLE FOR OBTAINING ALL NECESSARY PERMITS AND APPROVALS FROM THE CITY OF DALLAS AND THE UTILITY COMPANIES.
7. CONTRACTOR SHALL BE RESPONSIBLE FOR OBTAINING ALL NECESSARY PERMITS AND APPROVALS FROM THE CITY OF DALLAS AND THE UTILITY COMPANIES.
8. CONTRACTOR SHALL BE RESPONSIBLE FOR OBTAINING ALL NECESSARY PERMITS AND APPROVALS FROM THE CITY OF DALLAS AND THE UTILITY COMPANIES.
9. CONTRACTOR SHALL BE RESPONSIBLE FOR OBTAINING ALL NECESSARY PERMITS AND APPROVALS FROM THE CITY OF DALLAS AND THE UTILITY COMPANIES.
10. CONTRACTOR SHALL BE RESPONSIBLE FOR OBTAINING ALL NECESSARY PERMITS AND APPROVALS FROM THE CITY OF DALLAS AND THE UTILITY COMPANIES.
11. CONTRACTOR SHALL BE RESPONSIBLE FOR OBTAINING ALL NECESSARY PERMITS AND APPROVALS FROM THE CITY OF DALLAS AND THE UTILITY COMPANIES.
12. CONTRACTOR SHALL BE RESPONSIBLE FOR OBTAINING ALL NECESSARY PERMITS AND APPROVALS FROM THE CITY OF DALLAS AND THE UTILITY COMPANIES.
13. CONTRACTOR SHALL BE RESPONSIBLE FOR OBTAINING ALL NECESSARY PERMITS AND APPROVALS FROM THE CITY OF DALLAS AND THE UTILITY COMPANIES.
14. CONTRACTOR SHALL BE RESPONSIBLE FOR OBTAINING ALL NECESSARY PERMITS AND APPROVALS FROM THE CITY OF DALLAS AND THE UTILITY COMPANIES.
15. CONTRACTOR SHALL BE RESPONSIBLE FOR OBTAINING ALL NECESSARY PERMITS AND APPROVALS FROM THE CITY OF DALLAS AND THE UTILITY COMPANIES.
16. CONTRACTOR SHALL BE RESPONSIBLE FOR OBTAINING ALL NECESSARY PERMITS AND APPROVALS FROM THE CITY OF DALLAS AND THE UTILITY COMPANIES.
17. CONTRACTOR SHALL BE RESPONSIBLE FOR OBTAINING ALL NECESSARY PERMITS AND APPROVALS FROM THE CITY OF DALLAS AND THE UTILITY COMPANIES.
18. CONTRACTOR SHALL BE RESPONSIBLE FOR OBTAINING ALL NECESSARY PERMITS AND APPROVALS FROM THE CITY OF DALLAS AND THE UTILITY COMPANIES.
19. CONTRACTOR SHALL BE RESPONSIBLE FOR OBTAINING ALL NECESSARY PERMITS AND APPROVALS FROM THE CITY OF DALLAS AND THE UTILITY COMPANIES.
20. CONTRACTOR SHALL BE RESPONSIBLE FOR OBTAINING ALL NECESSARY PERMITS AND APPROVALS FROM THE CITY OF DALLAS AND THE UTILITY COMPANIES.

**IRRIGATION NOTES:**

1. IRRIGATION SYSTEM SHALL BE INSTALLED IN ACCORDANCE WITH THE CITY OF DALLAS IRRIGATION SPECIFICATIONS.
2. IRRIGATION SYSTEM SHALL BE INSTALLED IN ACCORDANCE WITH THE CITY OF DALLAS IRRIGATION SPECIFICATIONS.
3. IRRIGATION SYSTEM SHALL BE INSTALLED IN ACCORDANCE WITH THE CITY OF DALLAS IRRIGATION SPECIFICATIONS.
4. IRRIGATION SYSTEM SHALL BE INSTALLED IN ACCORDANCE WITH THE CITY OF DALLAS IRRIGATION SPECIFICATIONS.
5. IRRIGATION SYSTEM SHALL BE INSTALLED IN ACCORDANCE WITH THE CITY OF DALLAS IRRIGATION SPECIFICATIONS.
6. IRRIGATION SYSTEM SHALL BE INSTALLED IN ACCORDANCE WITH THE CITY OF DALLAS IRRIGATION SPECIFICATIONS.
7. IRRIGATION SYSTEM SHALL BE INSTALLED IN ACCORDANCE WITH THE CITY OF DALLAS IRRIGATION SPECIFICATIONS.
8. IRRIGATION SYSTEM SHALL BE INSTALLED IN ACCORDANCE WITH THE CITY OF DALLAS IRRIGATION SPECIFICATIONS.
9. IRRIGATION SYSTEM SHALL BE INSTALLED IN ACCORDANCE WITH THE CITY OF DALLAS IRRIGATION SPECIFICATIONS.
10. IRRIGATION SYSTEM SHALL BE INSTALLED IN ACCORDANCE WITH THE CITY OF DALLAS IRRIGATION SPECIFICATIONS.
11. IRRIGATION SYSTEM SHALL BE INSTALLED IN ACCORDANCE WITH THE CITY OF DALLAS IRRIGATION SPECIFICATIONS.
12. IRRIGATION SYSTEM SHALL BE INSTALLED IN ACCORDANCE WITH THE CITY OF DALLAS IRRIGATION SPECIFICATIONS.
13. IRRIGATION SYSTEM SHALL BE INSTALLED IN ACCORDANCE WITH THE CITY OF DALLAS IRRIGATION SPECIFICATIONS.
14. IRRIGATION SYSTEM SHALL BE INSTALLED IN ACCORDANCE WITH THE CITY OF DALLAS IRRIGATION SPECIFICATIONS.
15. IRRIGATION SYSTEM SHALL BE INSTALLED IN ACCORDANCE WITH THE CITY OF DALLAS IRRIGATION SPECIFICATIONS.
16. IRRIGATION SYSTEM SHALL BE INSTALLED IN ACCORDANCE WITH THE CITY OF DALLAS IRRIGATION SPECIFICATIONS.
17. IRRIGATION SYSTEM SHALL BE INSTALLED IN ACCORDANCE WITH THE CITY OF DALLAS IRRIGATION SPECIFICATIONS.
18. IRRIGATION SYSTEM SHALL BE INSTALLED IN ACCORDANCE WITH THE CITY OF DALLAS IRRIGATION SPECIFICATIONS.
19. IRRIGATION SYSTEM SHALL BE INSTALLED IN ACCORDANCE WITH THE CITY OF DALLAS IRRIGATION SPECIFICATIONS.
20. IRRIGATION SYSTEM SHALL BE INSTALLED IN ACCORDANCE WITH THE CITY OF DALLAS IRRIGATION SPECIFICATIONS.



NO.	DATE	DESCRIPTION
1	11/15/11	REVISED TYP. REV. 02/22/2022
2	02/22/2022	DESIGN CLARIFICATION 2/22/2022

This Document was produced by or under the direct supervision of Registered Architect

**TEX-MEX**  
1700 JACKSON ST.  
HARWOOD DISTRICT  
DALLAS, TX 75201



**FINAL PACKAGE**  
PHASE I LANDSCAPE PLAN  
Sheet Number: **L1.01**

Project No: 44374  
Drawing Date: 02/22/2022

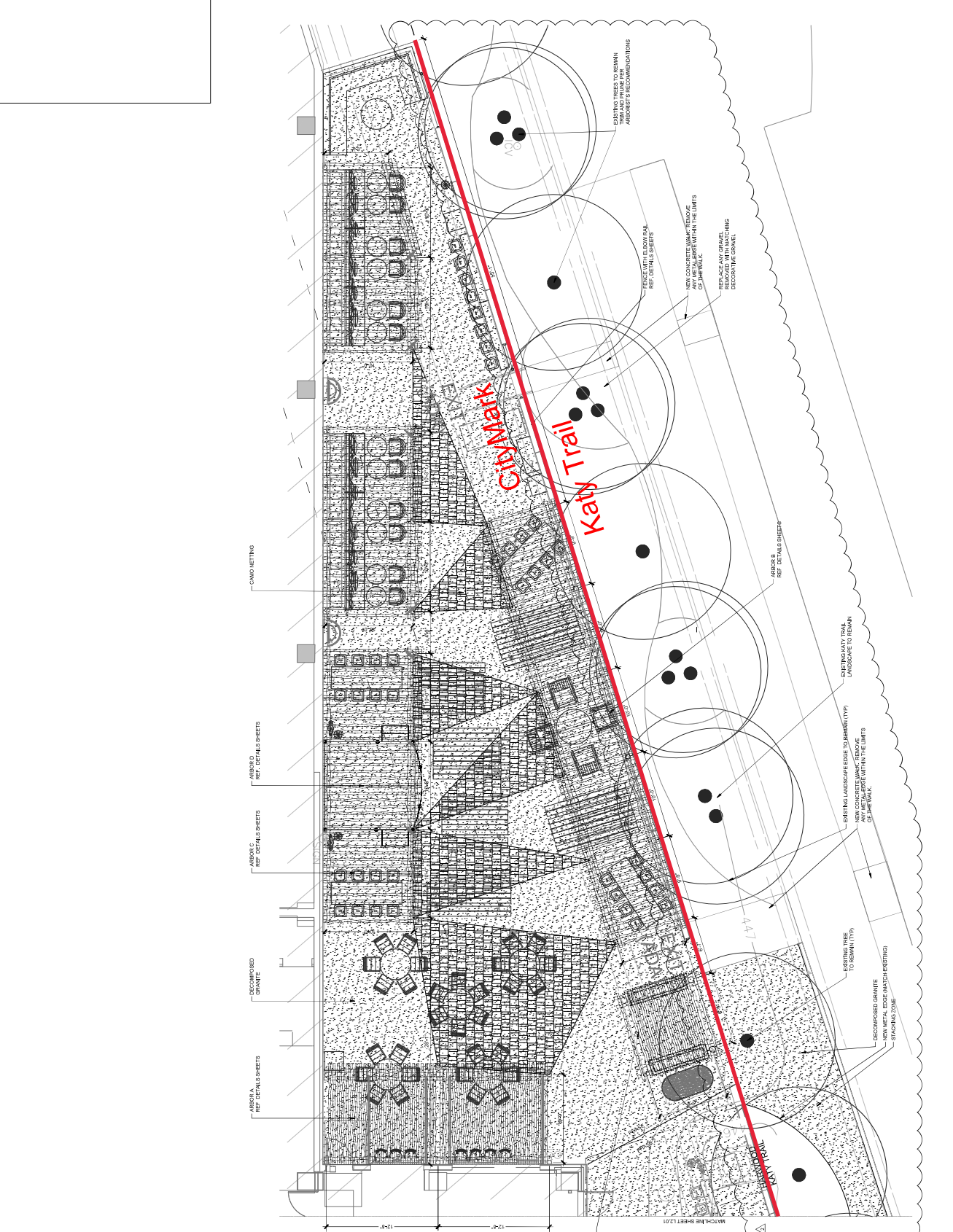



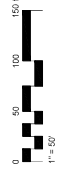

**HARWOOD INTERNATIONAL ARCHITECT**  
 1511 NORTH GILBERT STREET  
 SUITE 1000 DALLAS, TX 75201  
 PHONE: 214.742.1000  
 FAX: 214.742.1001  
 WWW.HARWOODINTERNATIONAL.COM

**HDF ARCHITECTURE INTERIORS DEVELOPMENT**  
 ADDRESS: 2801 HARKWOODS  
 SUITE 1000 DALLAS, TX 75201  
 PHONE: 214.742.1000  
 FAX: 214.742.1001  
 WWW.HARWOODINTERNATIONAL.COM

**CONSTRUCTION MANAGEMENT**  
 COMPANY: H&H CONSTRUCTION  
 CONTACT: JAMES HARRIS  
 EMAIL: JHARRIS@H&H.COM  
 BURL: JHARRIS@H&H.COM

**CIVIL**  
 COMPANY: H&H ASSOCIATES INC.  
 CONTACT: BRIAN SATAPALA PE  
 EMAIL: BSATAPALA@H&H.COM  
 BURL: BSATAPALA@H&H.COM  
 WWW.H&HASSOCIATES.COM

**STRUCTURAL**  
 COMPANY: L.A. PIERCE PARTNERS INC.  
 CONTACT: MORGAN SMITH PE  
 PHONE: 214.742.1000  
 EMAIL: SMITH@LAPIERCE.COM

**M&P**  
 COMPANY: RWB ENGINEERS  
 CONTACT: ANDREW LOCKER  
 BURL: ANDREW@RWB.COM

**IRRIGATION EQUIPMENT**  
 COMPANY: APCA DESIGN GROUPS  
 CONTACT: TERRY DOVALE PRINCIPAL  
 EMAIL: TDOVALE@ACPA.COM  
 WWW.ACPADSG.COM

**PLUMBING**  
 COMPANY: HYDRAVIA DESIGN  
 CONTACT: STEVEN HINDS PRINCIPAL  
 PHONE: 214.742.1000  
 EMAIL: STEVEN@HYDRAVIADESIGN.COM

NO.	DATE	DESCRIPTION
1	06/20/2022	ISSUED FOR PERMIT
2	06/20/2022	DESIGN CLARIFICATION

This Document was produced by or under the direct supervision of Registered Architect

**TEX-MEX**  
 1708 HICKMAN ST  
 HARWOOD DISTRICT  
 DALLAS, TX 75201



**FINAL PACKAGE**

**PHASE 2 LANDSCAPE PLAN**

Sheet Number: **L1.02**

Project No: 45374  
 Drawing Date: 06/20/2022

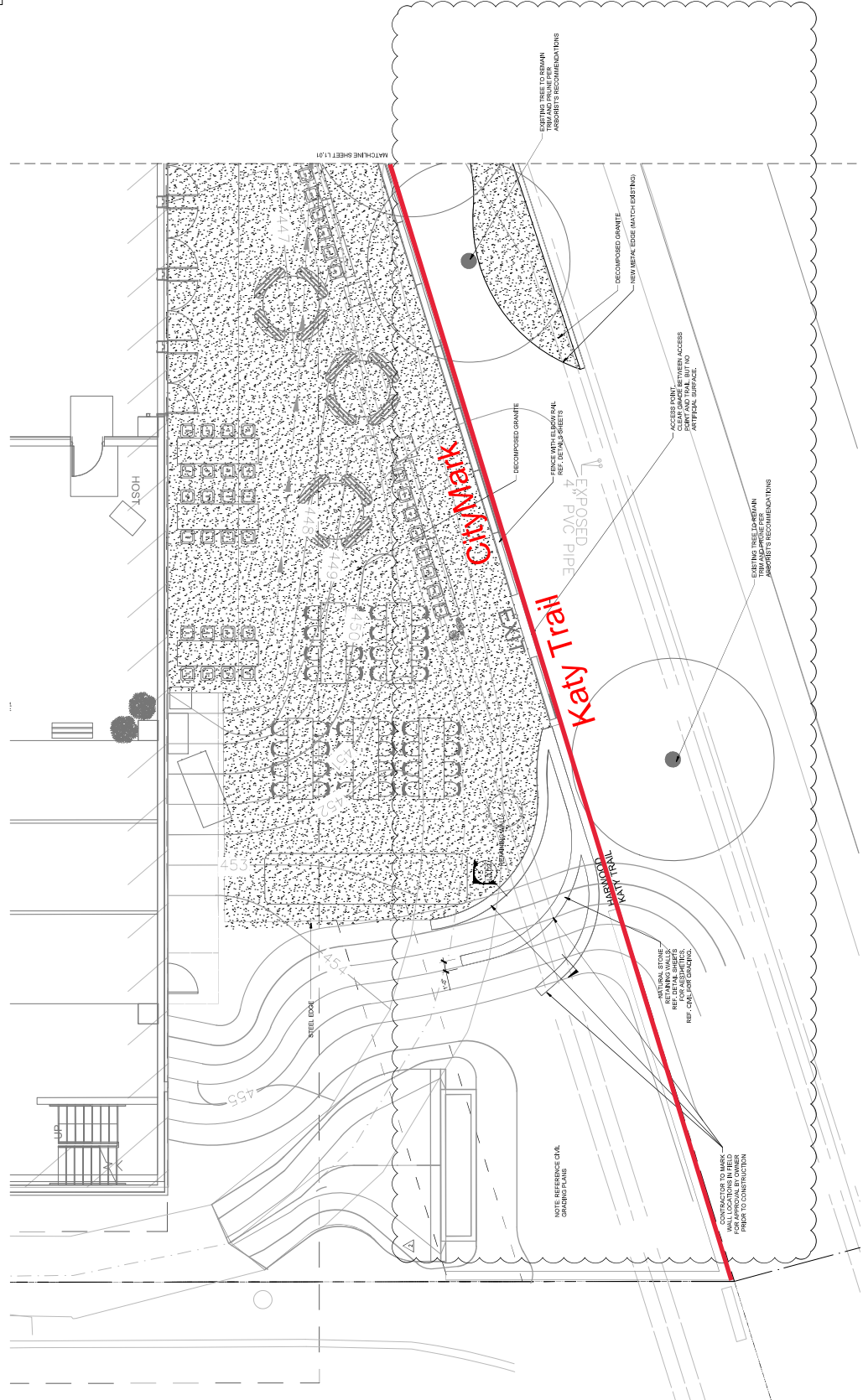

**TEX-MEX**

1500 JACKSON AT HARWOOD DISTRICT DALLAS, TX 75201

**Project**

**Final Package**

**DETAILS**

Sheet Number: **L3.01**

Project No: 40379

Drawing Date: 02/20/2022

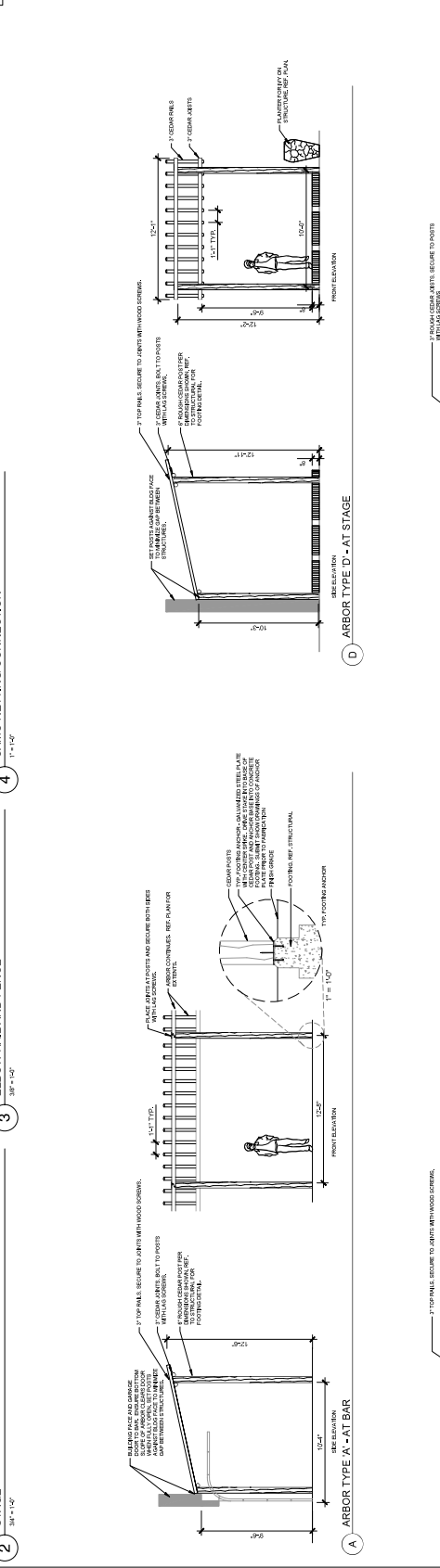
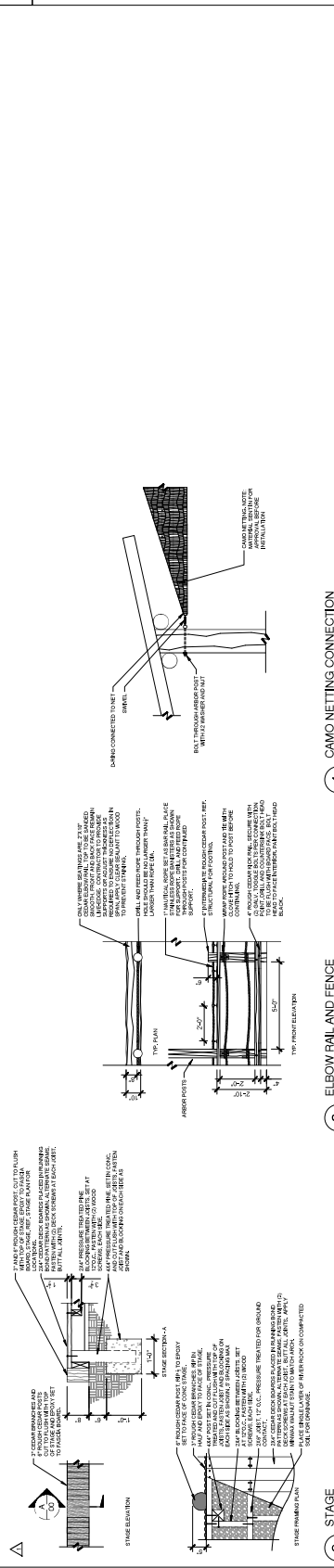

**THIS DOCUMENT WAS PRODUCED BY OR UNDER THE DIRECT SUPERVISION OF REGISTERED ARCHITECT**

**TEX-MEX**

1500 JACKSON AT HARWOOD DISTRICT DALLAS, TX 75201

**Project**

**Final Package**

**DETAILS**

Sheet Number: **L3.01**

Project No: 40379

Drawing Date: 02/20/2022

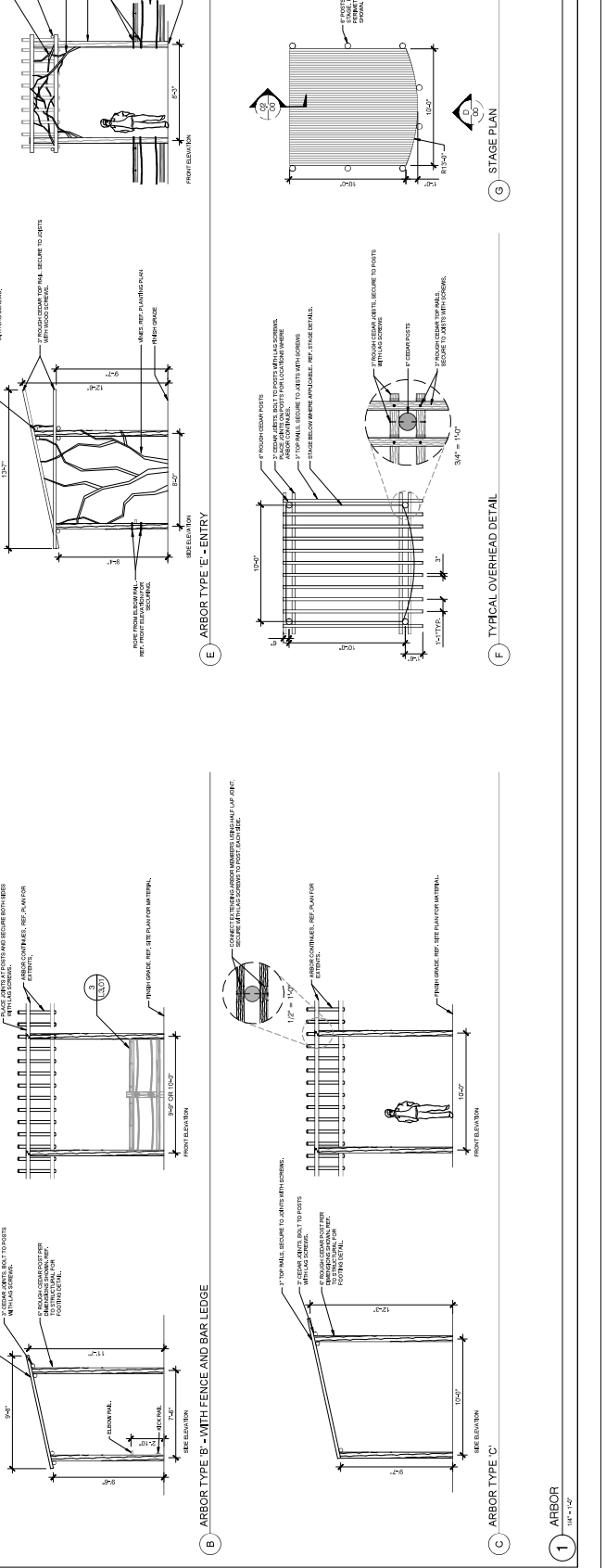

CITY OF DALLAS



CONSTRUCTION MANAGEMENT  
 COMPANY HARWOOD CONSTRUCTION  
 CONTACT JEFFREY HARRIS  
 ADDRESS 200 N. HARWOOD ST.  
 DALLAS, TX 75201  
 PHONE 214.424.0000  
 FAX 214.424.0001  
 WEB WWW.HARWOODCON.COM

CONTRACTOR  
 COMPANY MUELLER CONTRACTORS  
 CONTACT BRUNO BAYRLE  
 ADDRESS 2424 N. GARDEN ST.  
 DALLAS, TX 75205  
 PHONE 972.332.4444  
 FAX 972.332.4445  
 WEB WWW.MUELLERCON.COM

STRUCTURAL  
 COMPANY LA-PRES PARTNERS INC.  
 CONTACT ANDREW L. PRES  
 ADDRESS 2147 W. 20TH ST.  
 DALLAS, TX 75220  
 PHONE 972.731.1000  
 FAX 972.731.1001  
 WEB WWW.LA-PRES.COM

MFP  
 COMPANY RWS ENGINEERS  
 CONTACT ANDREW ROSEN  
 ADDRESS 1400 WEST END AVENUE  
 SUITE 200  
 DALLAS, TX 75201  
 PHONE 214.424.0000  
 FAX 214.424.0001  
 WEB WWW.RWSENGINEERS.COM

RECORD EQUIPMENT  
 COMPANY RECA DESIGN SOLUTIONS  
 CONTACT TED DODD  
 ADDRESS 1000 WEST END AVENUE  
 SUITE 200  
 DALLAS, TX 75201  
 PHONE 214.424.0000  
 FAX 214.424.0001  
 WEB WWW.RECADESIGN.COM

LIGHTING  
 COMPANY BYWATERS DESIGN  
 CONTACT STEVEN WATERS  
 ADDRESS 2142 GARDEN ST.  
 SUITE 200  
 DALLAS, TX 75205  
 PHONE 214.424.0000  
 FAX 214.424.0001  
 WEB WWW.BYWATERSDESIGN.COM

NO.	REVISION	DATE
1	ISSUE FOR PERMIT	06/20/2022
2	REVISIONS	06/20/2022
3	DESIGN CLARIFICATION	07/27/2022
4		
5		
6		
7		

This Document was produced  
 by or under the direct  
 supervision of Registered  
 Architect

TEX-MEX  
 1545 HARMON ST.  
 HARWOOD DISTRICT  
 DALLAS, TX 75201



Sheet Title  
**FINAL PACKAGE**  
**DETAILS**

Sheet Number  
**L3.02**  
 Project # 45079  
 Drawing Code 02/2022



**1 DECOMPOSED GRANITE**  
 30" ± x 4" ±

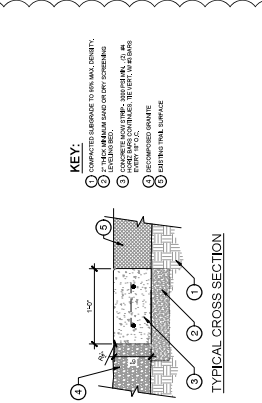

**2 MINE - MODIFIED SOIL**  
 10" ± x 4" ±

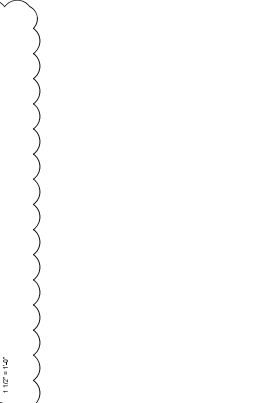

**3 TYPICAL STEEL LEDGING**  
 1" ± x 4" ±

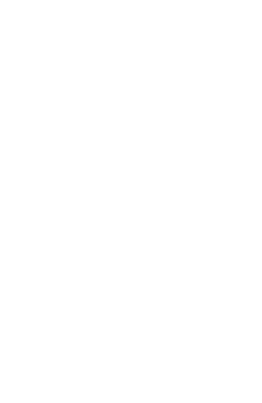

**4 SHRUB PLANTING DETAIL**  
 36" ± x 18" ±



**5 RETAINING WALL**  
 10" ± x 4" ±



**6 RETAINING WALL ELEVATION**  
 18" ± x 14" ±



**7 CONCRETE MOW STRIP**  
 1" ± x 4" ±

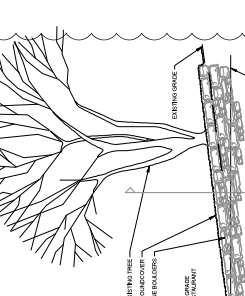

**8 TYPICAL CROSS SECTION**



**9 TYPICAL SIDEWALK**



**10 TYPICAL PLANTING DETAIL**



**11 TYPICAL GRANITE DETAIL**

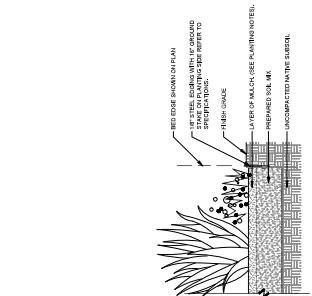

**12 TYPICAL SIDEWALK WITH CURB**

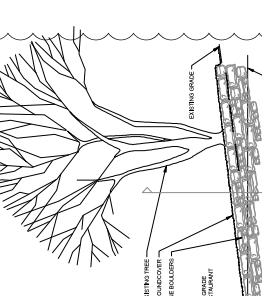

**13 TYPICAL SIDEWALK WITH CURB AND PLANTING**

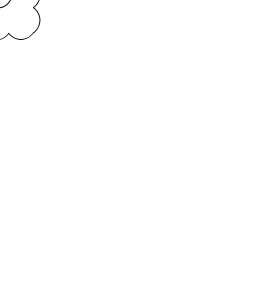

**14 TYPICAL SIDEWALK WITH CURB AND PLANTING DETAIL**



**15 TYPICAL SIDEWALK WITH CURB AND PLANTING DETAIL**



**16 TYPICAL SIDEWALK WITH CURB AND PLANTING DETAIL**

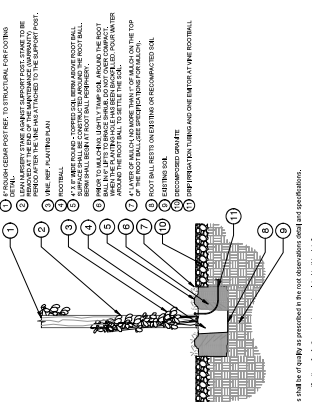

**17 TYPICAL SIDEWALK WITH CURB AND PLANTING DETAIL**

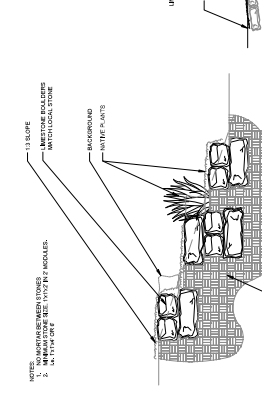

**18 TYPICAL SIDEWALK WITH CURB AND PLANTING DETAIL**



**19 TYPICAL SIDEWALK WITH CURB AND PLANTING DETAIL**



**20 TYPICAL SIDEWALK WITH CURB AND PLANTING DETAIL**



**21 TYPICAL SIDEWALK WITH CURB AND PLANTING DETAIL**

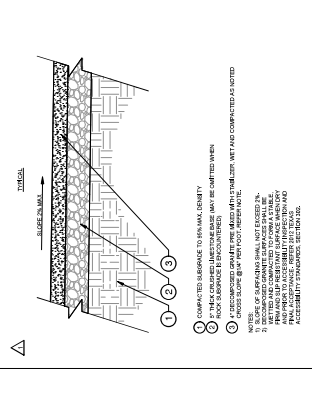

**22 TYPICAL SIDEWALK WITH CURB AND PLANTING DETAIL**

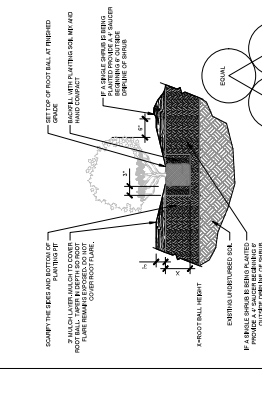

**23 TYPICAL SIDEWALK WITH CURB AND PLANTING DETAIL**

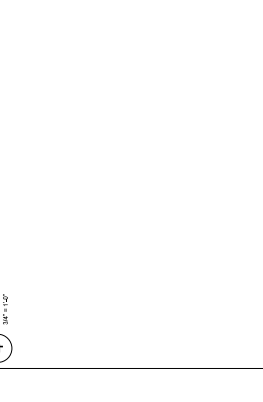

**24 TYPICAL SIDEWALK WITH CURB AND PLANTING DETAIL**



**25 TYPICAL SIDEWALK WITH CURB AND PLANTING DETAIL**



**26 TYPICAL SIDEWALK WITH CURB AND PLANTING DETAIL**