

ALCOHOL MEASUREMENT PLAT

AI SUSHI SAKE GRILL
 4123 Cedar Springs Road
 Suite 102
 Dallas, Tx. 75219
 Mapsco Page 35-W
 TX One Licensing

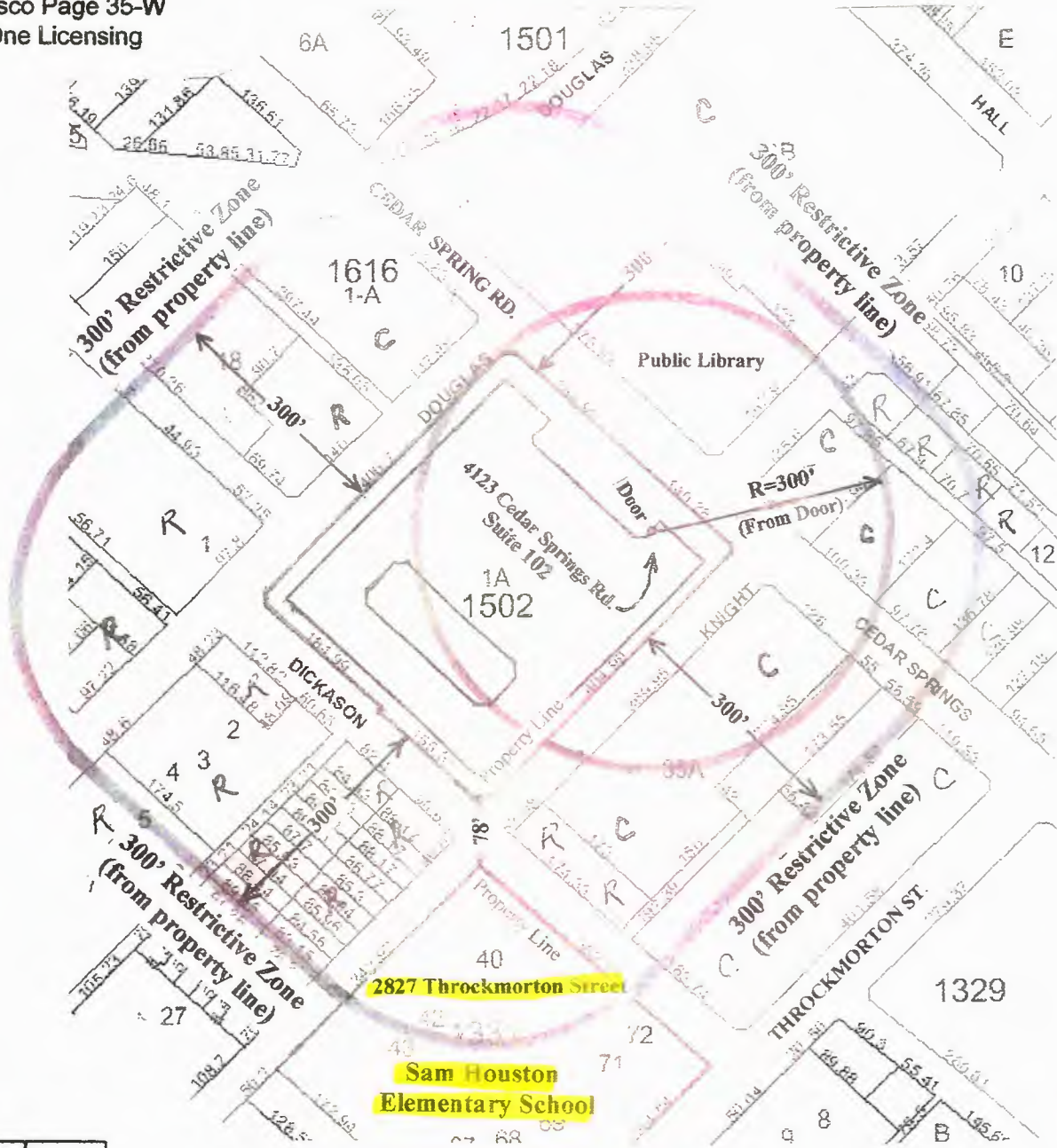

SCALE 1" = 200'

I have conducted (or caused to be conducted) a physical inspection of the area and a diligent search of public records to determine if the place of business is located near any protected uses. This survey map shows that the place of business where alcoholic beverages will be sold does not meet the location requirements in Dallas City Code 6-4.

The, AI SUSHI SAKE GRILL, located at 4123 Cedar Springs Road, Suite 102, in the City of Dallas, is within 300 feet of a church, public school or private school, day care center, child care facility or a public hospital as defined in Dallas City Code Section 6-4.

R = Residential
 C = Commercial
 V = Vacant

This survey was performed for an alcohol-measurement certification. All improvements may not be shown as existed at the time of survey. Research of protected properties included search of appraisal district records, parole evidence of the owner/manager and a physical inspection on the ground

Date: 5/3/2023
 Job: 23-228



Ben D. Rychlik
 Registered Professional Land Surveyor 1630
SURVEYING ASSOCIATES
 1018 S. Beckley, Dallas, Tx. 75203
 Phone: (214) 948-3324
 FIRM Registration / License No. 10040200

