

WRA Architects, Inc
 12377 Merit Drive
 Suite 1800
 Dallas, Texas 75251
 214.750.0077 voice
 214.750.5931 fax
 www.wraarchitects.com

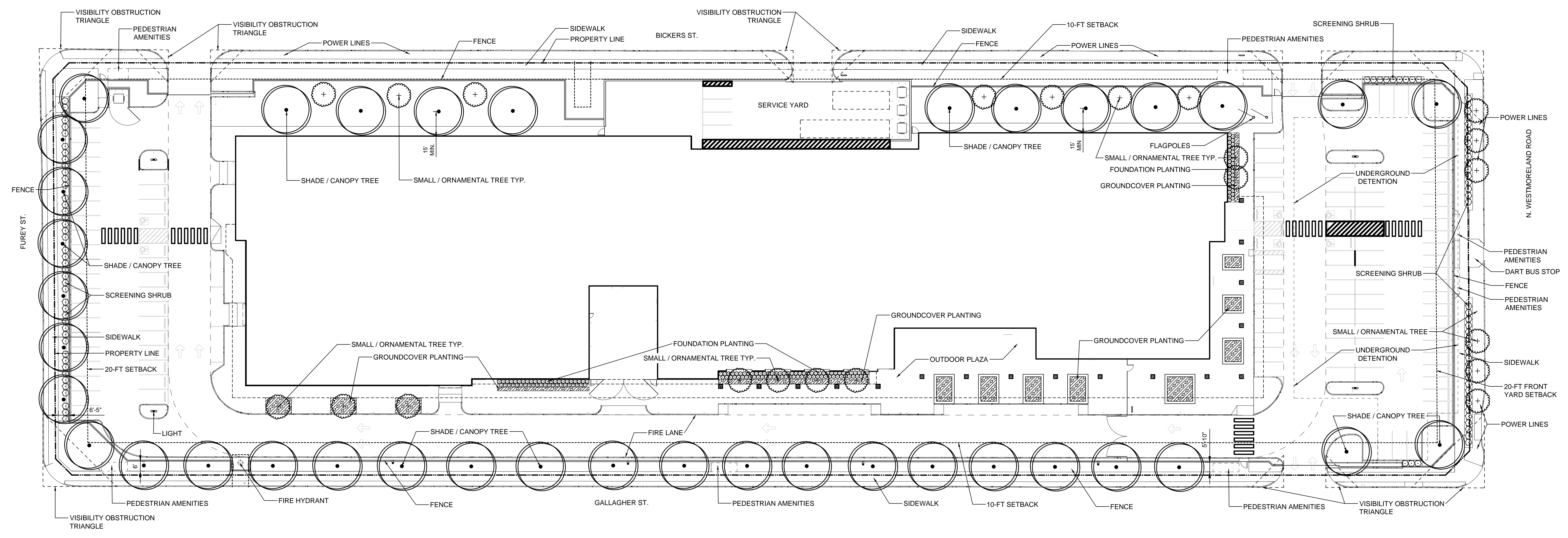

1 CAREER INSTITUTE WEST - LANDSCAPE PLAN - PLANNED DEVELOPMENT
 1" = 30'-0"

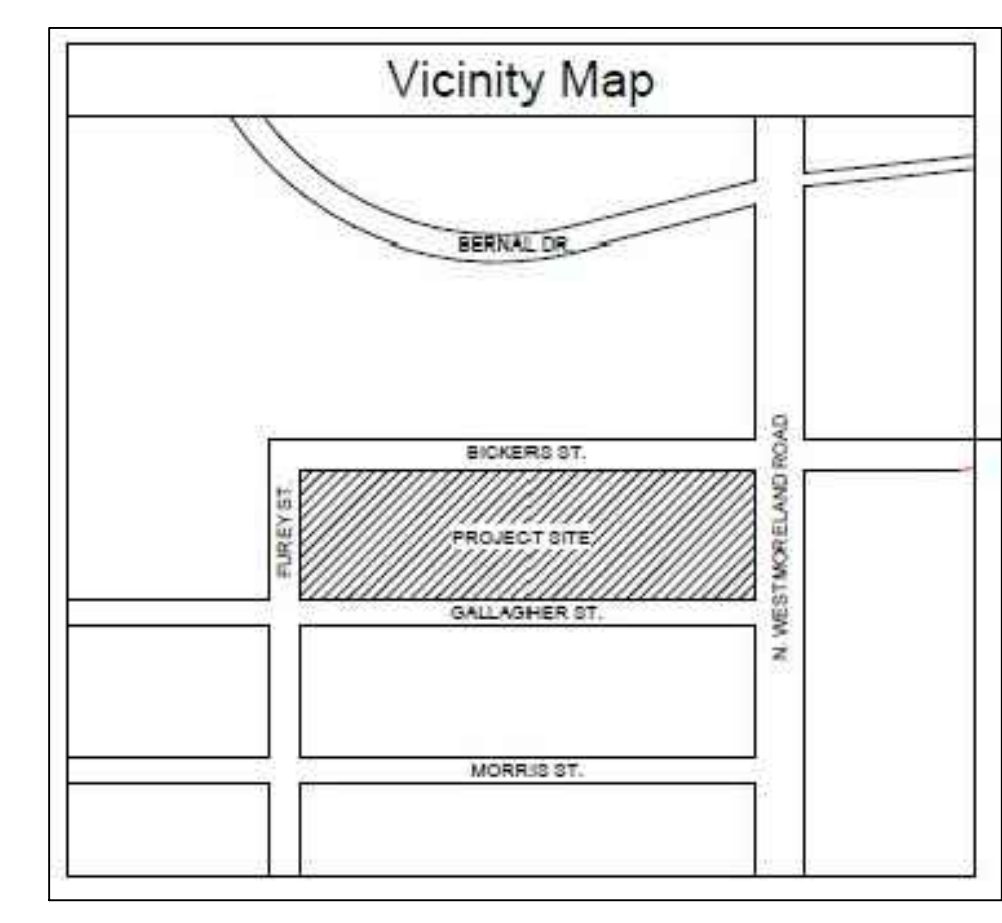
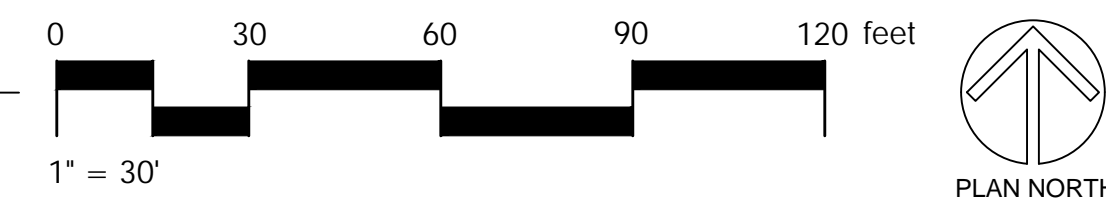

IRRIGATION NOTE:
 ALL CODE REQUIRED TREES AND SHRUBS TO EITHER BE WATERED BY A PERMANENT IRRIGATION SYSTEM OR A TEMPORARY SYSTEM. FOR TEMPORARY IRRIGATION, PLANTINGS TO BE LOCATED WITHIN 100 FEET OF WATER SOURCE SUCH AS A PERMANENT HOSE BIB.

LEGEND

- PROPOSED SHADE / CANOPY TREE (3" CALIPER MIN.):**
 - CEDAR ELM / *ULMUS CRASSIFOLIA*
 - LACEBARK ELM / *ULMUS PARVIFOLIA*
 - LIVE OAK / *QUERCUS VIRGINIANA*
 - BUR OAK / *QUERCUS MACROCARPA*
 - CHINQUAPIN OAK / *QUERCUS MUHLENBERGII*
 - SHUMARD OAK / *QUERCUS SHUMARDII*
 - CHINESE PISTACHE / *PISTACIA CHINENSIS*
 - BALD CYPRESS / *TAXODIUM DISTICHUM*
- PROPOSED SMALL / ORNAMENTAL TREE (2" CALIPER MIN.):**
 - DESERT WILLOW / *CHILOPSIS LINEARIS*
 - RED BUD / *CERCIS CANADENSIS* OR *RENIFORMIS*
 - CRAPE MYRTLE / *LAGERSTROEMIA INDICA*
 - EVE'S NECKLACE / *SOPHORA AFFINIS*
 - POSSOMHAW / *ILEX DECIDUA*
 - YAUPON HOLLY / *ILEX VOMITORIA*
 - BLACKHAW VIBURNUM / *VIBURNUM RUFIDULUM*
- SCREENING SHRUB BED (MIN. 5 GALLON, SPACING 3-6 FT. O.C. DEPENDING ON SPECIES):**
 - INDIAN HAWTHORN / *RAPHIOLEPIS SPP.*
 - TEXAS SAGE / *LEUCOPHYLLUM FRUTESCENS*
 - HOLLY / *ILEX SPP.*
 - WAX MYRTLE / *MYRICA CERIFERA* OR *PUSILLA*
 - VIBURNUM / *VIBURNUM SPP.*
- FOUNDATION PLANTING BED (MIN. 3 GALLON, SPACING 3-6 FT. O.C. DEPENDING ON SPECIES):**
 - ABELIA / *ABELIA SPP.*
 - HOLLY / *ILEX SPP.*
 - RED YUCCA / *HESPERALOE PARVIFLORA*
 - MUHLY GRASS / *MUHLENBERGIA SPP.*
 - SALVIA *SPP.*
- GROUNDCOVER PLANTING BED (MIN. 1GALLON, SPACING 3-6 FT. O.C. DEPENDING ON SPECIES):**
 - AUTUMN FERN / *DRYOPTERIS ERYTHROSORA*
 - PINK SKULLCAP / *SCUTELLARIA SUFFRUTESCENS*
 - SEDGE / *CAREX SPP.*
 - CREEPING LILY TURF / *LIRIOPE SPP.*

DISD CAREER INSTITUTE WEST

3531 N Westmoreland Rd, Dallas, TX 75212

REVISIONS:

JOB NO. 2248
 DATE: 07.31.2024

LANDSCAPE PLANNED DEVELOPMENT

L-1

