



**Dallas Park and Recreation Board Update
2024 Bond Request**

Turtle Creek Park Conservancy

June 1, 2023



Turtle Creek Park



Historic Dallas City Park since 1909
Partnering with the City of Dallas for 25 years

Mission Statement

The Turtle Creek Park Conservancy is a nonprofit organization committed to the conservation, preservation, and exceptional care of Turtle Creek Park and Arlington Hall, while creating a public space for physical and mental wellness, connection, entertaining, and educational programs.



Turtle Creek Park

20 Acres of a Natural Sanctuary in the Heart of the City

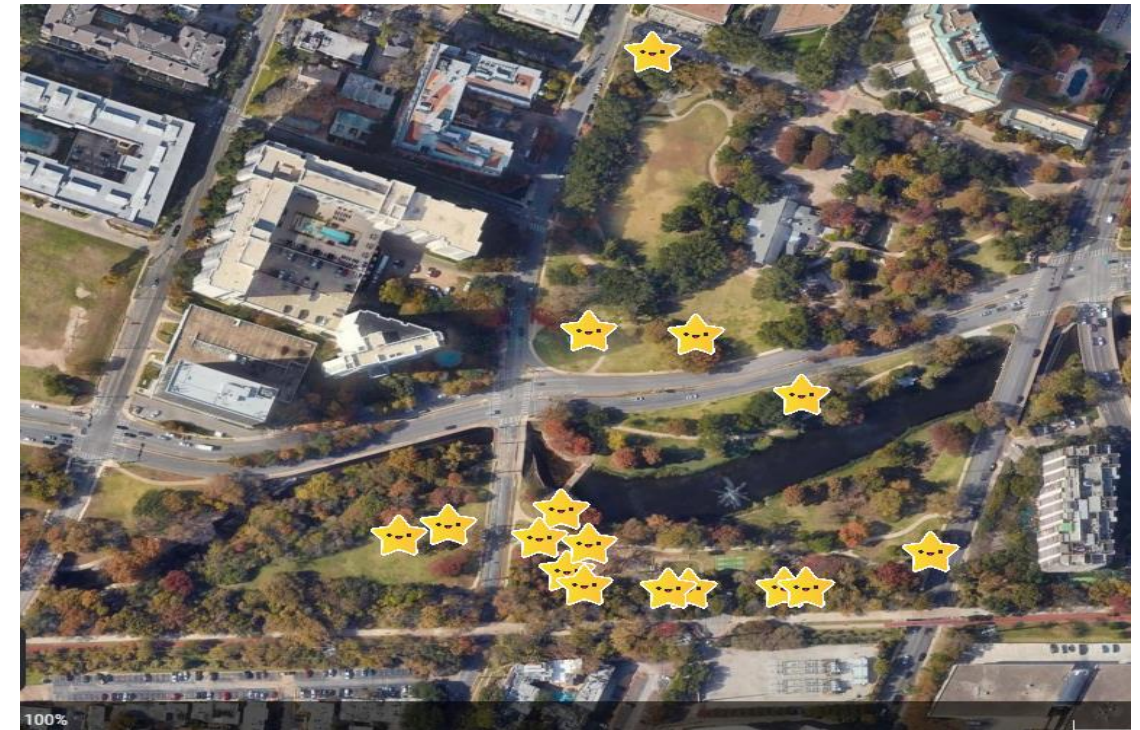
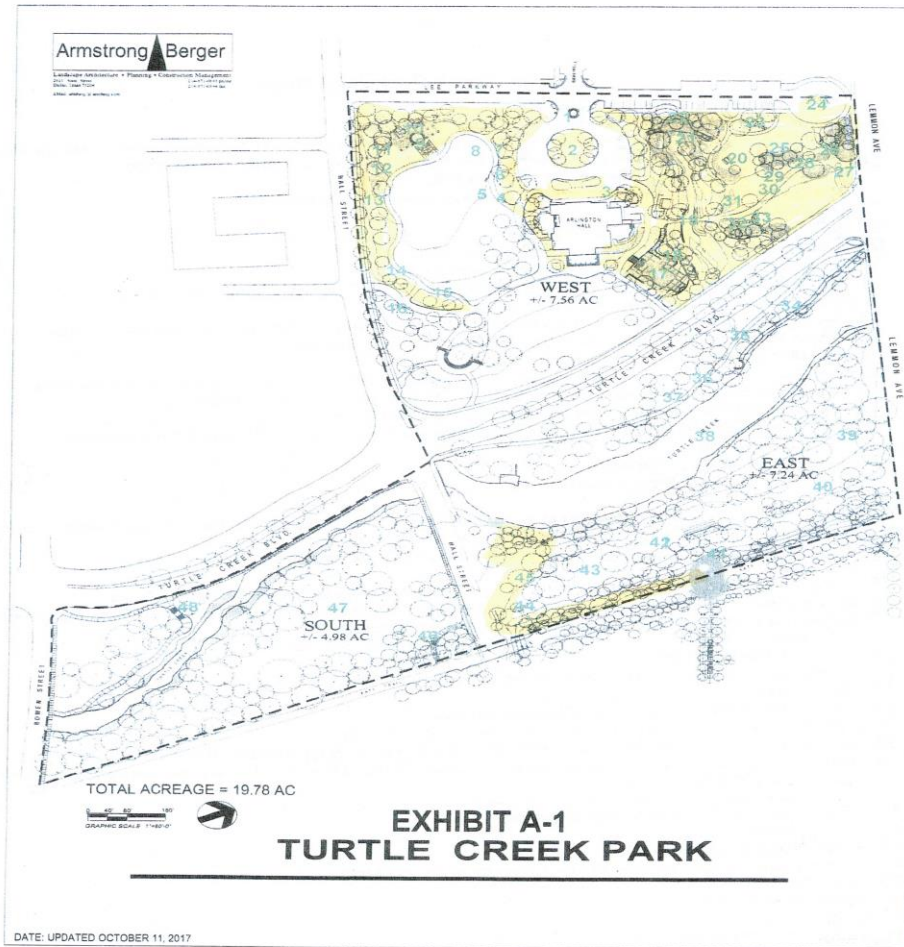

Post Oak Trees in
Turtle Creek Park



A Year in the Life of Turtle Creek Park



~ 500,000 visitors to Turtle Creek Park annually
There are 200 events in Arlington Hall and Turtle Creek Park per year
Over 14,000 residents within a 10-minute walk
Over \$1.5B of new development announced within 1-mile
We care for 20 acres, 10,000 SF of irrigation and 1,090 trees
52,000 pounds of carbon are absorbed per year by our trees
In the last year:
20 trees, 245 shrubs, 330 grass plants, 3,800 flowers planted
450 volunteer and staff hours for park clean-ups and plantings

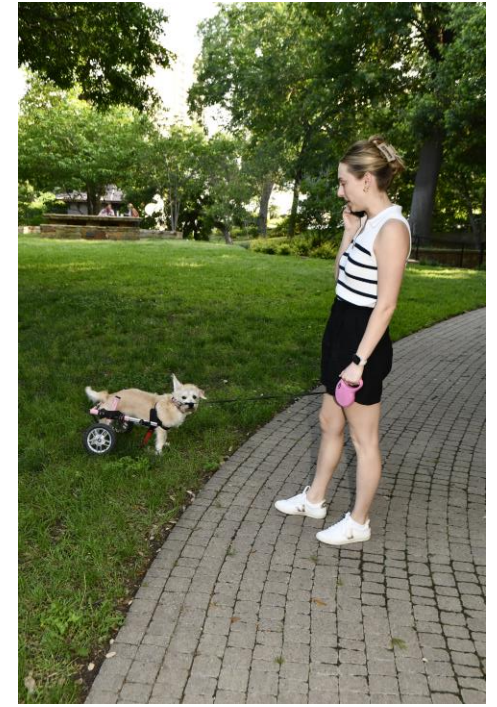



RENEWED FOCUS ON FREE COMMUNITY PARK EVENTS

- 6,500 attendees for Easter in Turtle Creek Park
- 100 participants for KIDS Fishing Derby
- 350 people for Movie Night in Turtle Creek Park
- 300 attendees for Light Up Turtle Creek Park



Cornerstone for Connection

Connect. Care. Conserve.

Ongoing Operations

Connect

- \$3M Capital Campaign to reimagine & recreate the Robert E. Lee statue corner at Hall & Turtle Creek Boulevard
- TCC is committed to creating an inclusive and welcoming area for a previously controversial corner

Care

- Update interior of Arlington Hall
- Restoring lost landscaping due to 2021 & 2022 freezes and drought
- Complete city partnership match projects for 2017 matching funds

Conserve

- Prioritize conservation of Post Oak trees throughout the park
- Create reforestation plan and removal of invasive species
- Establish anti-erosion plan for Turtle Creek

A photograph of a dense forest with many trees and green foliage. Sunlight filters through the leaves, creating a dappled light effect on the ground and branches.

**Be Immersed in Nature
in the South Parcel**



2024 City Capital Bond Program

Connect. Care. Conserve.

Making Turtle Creek Park
Accessible for Everyone
Developing the South Parcel



Connect

- Provide bridge for pedestrian access from Turtle Creek Boulevard into the South Parcel
- Create pedestrian circulation throughout the South Parcel with up to 2 miles of soft surface nature trails
- Offer scenic overlooks to enhance park experience

Care

- Activate green space to address illegal activity, homelessness, and fires
- Offer immersion in nature for all visitors
- Ensure accessibility to the park for Dallas community
- Institute best practices for trash control

Conserve

- Prioritize protection of rare species of native Post Oak Trees
- Maintain natural landscaping with Texas native plants
- Turtle Creek Stabilization and Erosion Control





Connect. Care. Conserve.

Making Turtle Creek Park Accessible for Everyone

Capital Improvement Project - \$6M



\$3M



\$3M

Pedestrian Circulation and Connection to Katy Trail
Nature Trails
Flagstone Bridge and Ramps Over Turtle Creek
Scenic Overlooks
Erosion Control
Intersection Crosswalks at Hall/Bowen at Turtle Creek Blvd
Subsurface Drainage
Landscape and Infrastructure Improvements
New Roof for Arlington Hall
ASK: \$3 Million on a \$6 Million Project

Thank You!



TURTLE CREEK PARK
CONSERVANCY