

ALCOHOL MEASUREMENT PLAT

PIZZA FRITTA
 2109 S. Edgefield Avenue
 Dallas, Tx. 75224
 Mapsco Page 54-N
 David Rice

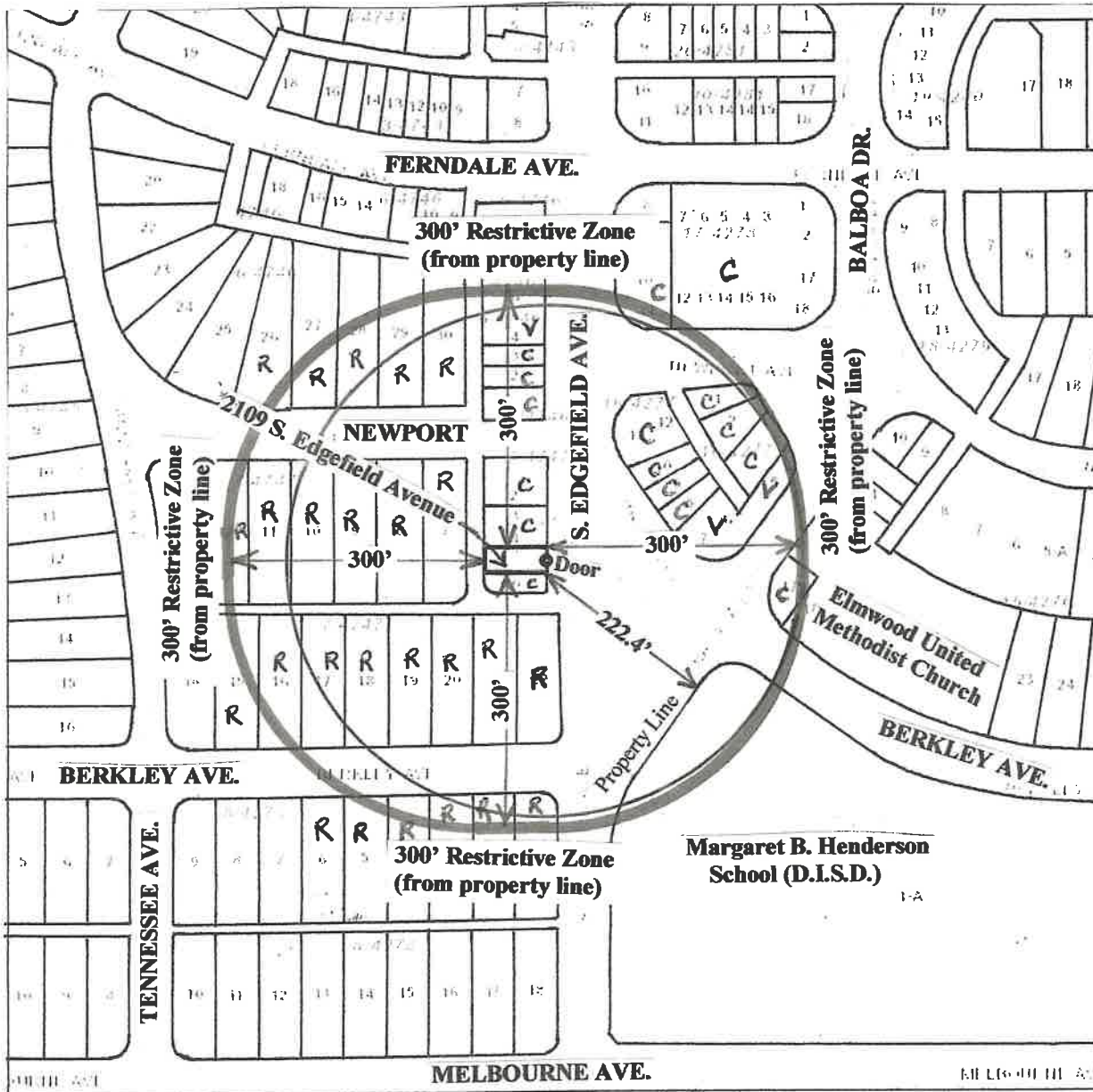

SCALE 1" = 200'

I have conducted (or caused to be conducted) a physical inspection of the area and a diligent search of public records to determine if the place of business is located near any protected uses. This survey map shows that the place of business where alcoholic beverages will be sold does not meet the location requirements in Dallas City Code 6-4.

The PIZZA FRITTA, located at 2109 S. Edgefield Avenue, in the City of Dallas, is within 300 feet of a church, public or private school, day care center, child care facility or a public hospital as defined in Dallas City Code Section 6-4.

R = Residential
 C = Commercial
 V = Vacant

Date 7/15/2022

Job 22-380

This survey was performed for an alcohol-measurement certification. All improvements may not been shown as existed at the time of survey. Research of protected properties included a search of appraisal district records, parole evidence of the owner/manager and a physical inspection on the ground.



Ben D. Rychlik
 Registered Professional Land Surveyor 1630
SURVEYING ASSOCIATES
 1018 S. Beckley, Dallas, Tx. 75203
 Phone: (214) 948-3324
 Fax: (214) 946-7540
 FIRM Registration / License No. 10040200

