

FILE NAME AND PATH: C:\Users\Stewie\Desktop\BLA\In\BLA\Inc Team Folder\RPG\Rpg-192021 DSD STAG Present Grove\Landscapes.dwg
PLOT DATE AND TIME: 6/30/2022 9:58 AM

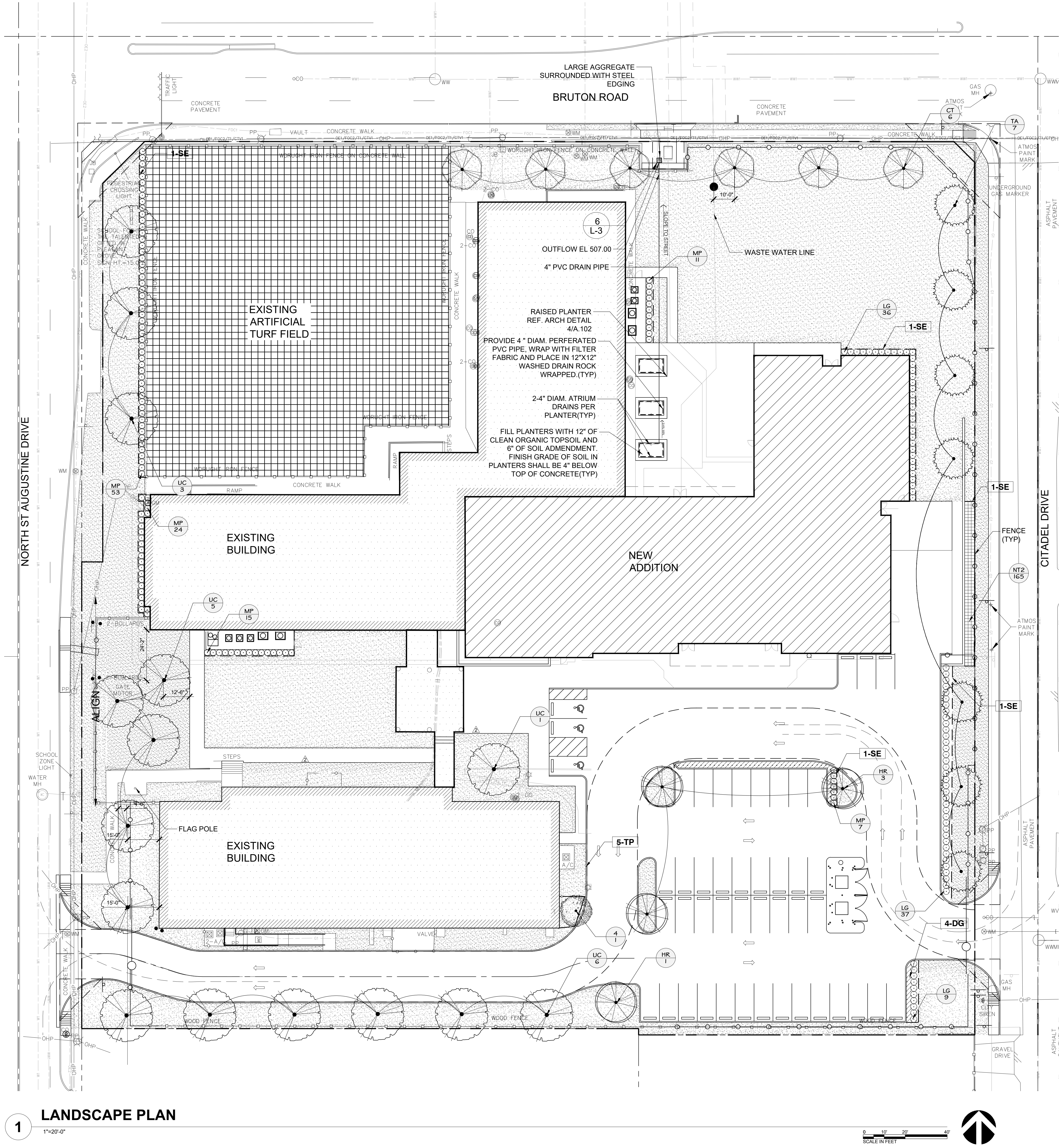

1 LANDSCAPE PLAN
1"=20'-0"

GENERAL PLANTING NOTES

- CONTRACTOR SHALL ADHERE TO CITY CONSTRUCTION REQUIREMENTS INCLUDING BUT NOT LIMITED TO ANY PERMITS, INSPECTIONS, AND METHODS OF MATERIAL INSTALLATION.
- CONTRACTOR SHALL ADHERE TO ALL AGENCY REQUIREMENTS MEANS AND METHODS OF CONSTRUCTION.
- CONTRACTOR SHALL VERIFY THE LOCATION OF ALL UTILITIES ABOVE AND BELOW GRADE, AS WELL AS FINDING OUT EACH COMPANY'S RESTRICTIONS ON WORKING WITHIN THEIR EASEMENTS AND UTILITY LINES PRIOR TO COMMENCING CONSTRUCTION.
- CONTRACTOR SHALL VERIFY LOCATION OF ALL EXISTING IMPROVEMENTS AND TO NOT DISTURB THOSE THAT ARE OUTSIDE OF THE SCOPE OF WORK. ANY STRUCTURES THAT ARE TO REMAIN WITHIN THE SCOPE OF WORK AREA SHALL NOT BE DAMAGED. PHOTOGRAPHS AND NOTES SHOULD BE MADE FOR ANY EXISTING DAMAGED CONDITIONS PRIOR TO COMMENCING CONSTRUCTION AND DISTRIBUTED TO OWNERS REPRESENTATIVE.
- A LANDSCAPE IRRIGATION PLAN SHALL BE PREPARED PRIOR TO LANDSCAPE CONSTRUCTION AND WILL BE DESIGNED BY A TEXAS LICENSED IRRIGATION DESIGNER. ALL PLANTING AREAS SHALL BE IRRIGATED WITH AN AUTOMATIC IRRIGATION SYSTEM WITH A FREEZE AND RAIN SENSOR. THE SYSTEM SHALL BE DESIGNED TO MEET THE CITY AND STATE IRRIGATION REQUIREMENTS. THE IRRIGATION INSTALLER SHALL BE A STATE OF TEXAS LICENSED IRRIGATION DESIGNER.
- CONTRACTOR SHALL NOTIFY OWNERS REPRESENTATIVE IF THERE ARE ANY WATER RESTRICTIONS AND WHAT IF ANY IMPACT THIS MAY HAVE ON THE INSTALLATION OF PLANT MATERIAL.
- QUANTITIES SHOWN IN PLANT LIST FOR PLANT MATERIAL AREA PROVIDED AS A COURTESY FOR THE CONTRACTOR. CONTRACTOR SHALL VERIFY PRIOR TO BIDDING THAT THE QUANTITY WILL COVER THE SPECIFIED AREAS AT THE SPACING STATED IN THE PLANT LIST UNDER THE REMARKS COLUMN. IF THERE IS A DIFFERENCE, THE CONTRACTOR SHALL MAKE NOTE ON THEIR BID AND SHOW THE ADDED OR REDUCED COST.
- CONTRACTOR SHALL ESTABLISH SOURCES FOR ALL PLANT MATERIAL ON PLANT LIST WHEN BIDDING PROJECT. NO PLANTS SUBSTITUTIONS.
- CONTRACTOR SHALL BECOME FAMILIAR WITH THE DRAWINGS FOR THIS PROJECT PRIOR TO INSTALLATION.
- IT IS THE RESPONSIBILITY OF THE CONTRACTOR TO ADVISE THE OWNERS REPRESENTATIVE OF ANY CONDITION FOUND ON-SITE WHICH PROHIBITS INSTALLATION AS SHOWN ON THESE PLANS.
- ALL NEW PLANTING BEDS SHALL HAVE A MINIMUM SIX (6") INCHES OF BED PREPARATION.
- LAWN AREA SHALL HAVE FERTILE AND CLEAN TOP SOIL TILED 4" DEEP.
- GRADING IN PLANTING BEDS SHALL BE SMOOTH AND PROVIDE POSITIVE DRAINAGE.
- CONTRACTOR SHALL STAKE OUT LOCATION OF ALL TREES, AND SHRUBS FOR APPROVAL BY OWNERS REPRESENTATIVE PRIOR TO PLANTING.
- MULCHING OF SHRUB AND ANY GROUND COVER AREAS SHALL HAVE 3 INCHES OF SHREDDED HARDWOOD MULCH.
- LANDSCAPED AREAS SHALL BE KEPT FREE OF TRASH, LITTER, WEEDS, AND OTHER SUCH MATERIAL OR PLANTS NOT A PART OF THE LANDSCAPING.
- THE PROPERTY OWNER, TENANT AND ANY AGENT THEREOF SHALL BE JOINTLY AND SEVERALLY RESPONSIBLE FOR THE MAINTENANCE OF ALL LANDSCAPING MATERIALS IN GOOD CONDITION AT ALL TIMES SO AS TO PRESENT A HEALTHY, NEAT AND ORDERLY APPEARANCE. ANY LANDSCAPING MATERIAL THAT DIES SHALL BE REPLACED WITH HEALTHY MATERIAL WITHIN A REASONABLE TIME. ALL LANDSCAPED AREAS SHALL BE CONTINUOUSLY MAINTAINED FREE OF WEEDS, DEBRIS AND LITTER. WEEDS AND NATURAL UNCULTIVATED GRASS SHALL NOT BE CONSIDERED LANDSCAPING.

REFERENCE NOTES SCHEDULE

SYMBOL	DESCRIPTION
1-SE	STEEL EDGING- 3/16" THICK X 4" WIDE ONLY 1/2" EXPOSED ABOVE SOIL LINE OF SOD
4-DG	DECOMPOSED GRANITE 3" PLACED OVER FILTER FABRIC
5-TP	TREE PRESERVATION FENCE

LANDSCAPE LEGEND

EXISTING TREES	CODE	COMMON NAME
4		CEDAR ELM 10"
LARGE TREES	CODE	COMMON NAME
HR		HIGH RISE LIVE OAK
TA		POND CYPRESS
UC		CEDAR ELM
MEDIUM TREES	CODE	COMMON NAME
CT		TEXAS REDBUD
SHRUBS	CODE	COMMON NAME
LG		GREEN CLOUD TEXAS RANGER
MP		DWARF SOUTHERN WAX MYRTLE
GROUND COVERS	CODE	COMMON NAME
NT2		MEXICAN FEATHERGRASS
SOLID SOD	CODE	COMMON NAME
CH		BERMUDA GRASS
		ARTIFICIAL TURF AREA-EXISTING

PLANT SCHEDULE

EXISTING TREES	QTY	COMMON / BOTANICAL NAME	SIZE	CONTAINER	HEIGHT	SPREAD
4	1	CEDAR ELM 10"	10"			
		ULMUS CRASSIFOLIA				
LARGE TREES	QTY	COMMON / BOTANICAL NAME	SIZE	CONTAINER	HEIGHT	SPREAD
HR	4	HIGH RISE LIVE OAK	3" CAL.	POT	10'-12'	3'-4'
		QUERCUS VIRGINIANA 'HIGH RISE'				
TA	7	POND CYPRESS	3" CAL.	POT	8'-10'	3'-4'
		TAXODIUM ASCENDENS				
UC	15	CEDAR ELM	3" CAL.	POT	10'-12'	8'-10'
		ULMUS CRASSIFOLIA				
MEDIUM TREES	QTY	COMMON / BOTANICAL NAME	SIZE	CONTAINER	HEIGHT	SPREAD
CT	6	TEXAS REDBUD	3" CAL.	POT	8'-10'	8'-10'
		CERCIS CANADENSIS TEXENSIS				
SHRUBS	QTY	COMMON / BOTANICAL NAME	SIZE	CONTAINER	HEIGHT	SPREAD
LG	83	GREEN CLOUD TEXAS RANGER	3 GAL.	POT	20'-22"	24"
		LEUCOPHYLLUM FRUTESCENS 'GREEN CLOUD' TM				
MP	110	DWARF SOUTHERN WAX MYRTLE	3 GAL.	POT	16"-18"	12"-16"
		MYRTICA PUSILLA				
GROUND COVERS	QTY	COMMON / BOTANICAL NAME	SIZE	CONTAINER		
NT2	165	MEXICAN FEATHERGRASS	1 GAL.	POT		18" o.c.
		NASSELLA TENUISSIMA 'PONY TAILS'				
SOLID SOD	QTY	COMMON / BOTANICAL NAME	SIZE	CONTAINER		
CH	49,908 SF	BERMUDA GRASS				
		CYNODON DACTYLON '419 HYBRID'				

DRAWN BY:	SCB	
CHECKED BY:	DLB	
DATE:	08-16-2020	
ISSUED FOR PERMIT:		
ISSUED FOR PRICING:		
REVISIONS:		
No.	Description	Date
	PD ISSUE	06-29-2022

© 2020 by RP&G Design Group, INC.
All Rights Reserved.
This representation and schedule are the sole property of RP&G Design Group, INC.
and may not be reproduced in any form without the written permission.

JAL Architect Group, Inc.
2695 Villa Creek Drive, Suite 206
Dallas, Texas 75234
972.620.7377

RP&G A
DESIGN GROUP, INC.
ARCHITECTURE SPACE PLANNING INTERIORS
JULIE S. BENNING, AIA, LEED AP, FORT WORTH, TEXAS 76104 817.333.9477 FAX 817.333.9487
WWW.RP&GARCHITECTS.COM

VICTORY PARK STUDIOS, LLC
LANDSCAPE ARCHITECTURE, ENGINEERING AND ARCHITECTURE
10000 W. HIRSH DRIVE, SUITE 100
DALLAS, TX 75243 972.402.8841

E363. NO. P0027-3
SCHOOL FOR THE TALENTED AND GIFTED
IN PLEASANT GROVE
9610 BRUTON ROAD DALLAS, TEXAS 75217

DALLAS ISD
BOND PROGRAM
2015
08-16-20



SHEET DESCRIPTION:
LANDSCAPE PLAN
SHEET NO.