

BUILDING USE & SQUARE FOOTAGE	
ADDRESS	6801 GRADY NIBLO RD, DALLAS, TX 75236
ZONING	A(A) AGRICULTURAL DISTRICT
BUILDING USE	CHURCH, SCHOOL
GROSS BUILDING SQUARE FOOTAGE	SANCTUARY – 5,000 SF, EDUCATION – 10,000 SF
SANCTUARY SEATING AREA	1,114 SF
SCHOOL GRADES	K THRU 6TH
SCHOOL CLASSROOMS	7 CLASSROOMS
SCHOOL CLASSROOM SIZE	10 STUDENTS MAXIMUM
LOT SIZE	6.99 ACRES, 300 FT BY 1015.35 FT
BUILDING SETBACKS REQUIRED	FRONT – 50 FT, SIDES – 20 FT, REAR – 10 FT
LOT COVERAGE	0.05 < 0.25 THEREFORE OKAY
FLOOR AREA RATIO (FAR)	0.06

PARKING		
3 HANDICAP AND 1 WHEELCHAIR HANDICAP SPACES INCLUDED		
USE	PARKING REQUIRED	PARKING PROVIDED
CHURCH	40	
SCHOOL	11	
TOTAL	51	67

### SITE PLAN AND PARKING LAYOUT

SCALE: 1/32" = 1'-0"

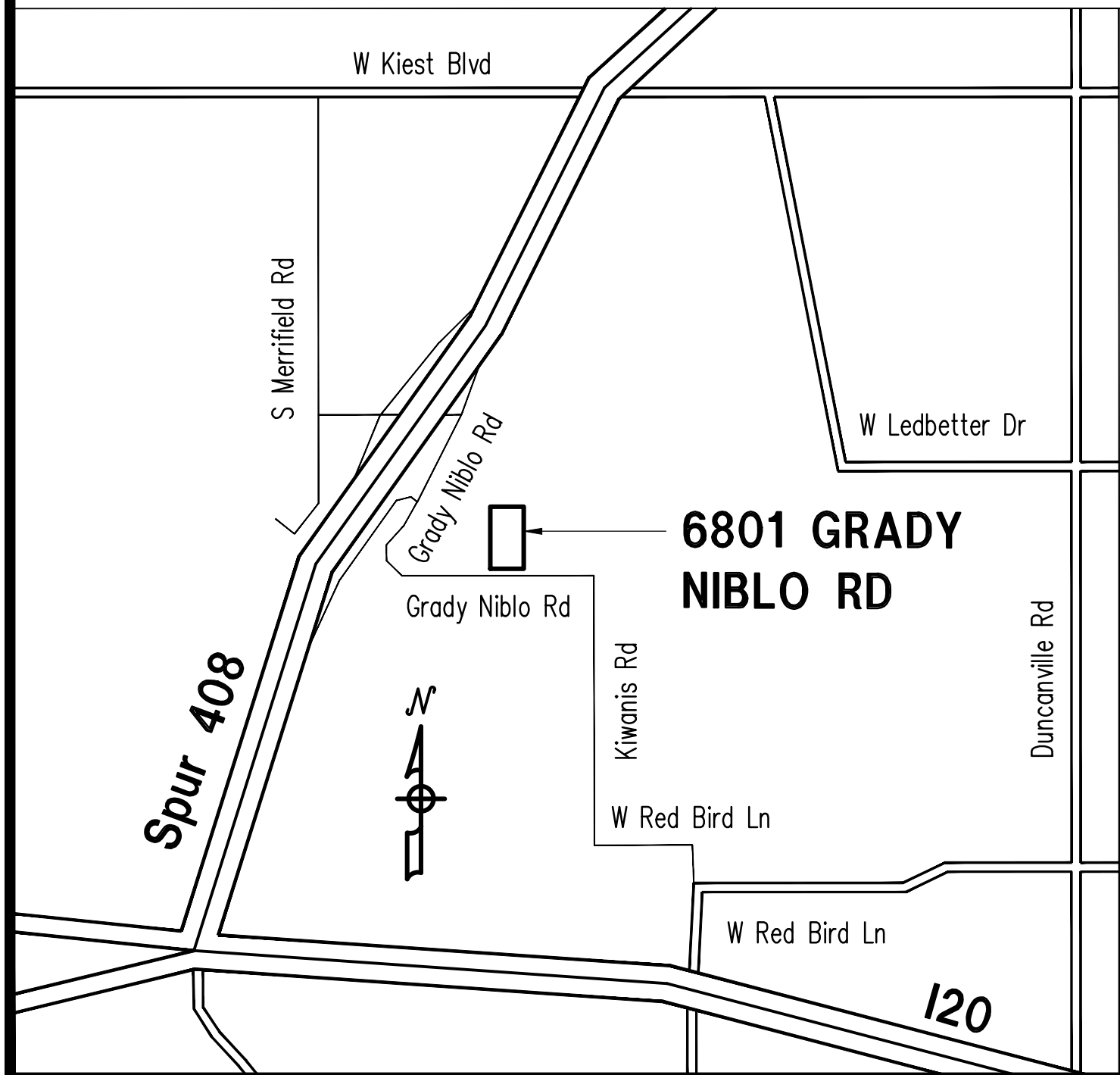

Site Address: 6801 Grady Niblo Rd., Dallas, TX	
Job. No. SUP	Sheet No.
Drawn By: CSENG	C1
Date: 3/28/2022	
Sheet 1 of 1 TOTAL	

CASE NUMBER: Z167-123(JM)