

# Traffic Management Plan

## John Lewis Social Justice Academy at Oliver Wendell Holmes Middle School

February 17, 2023

### Introduction

The services of Lambeth Engineering Associates, PLLC, (herein Lambeth Engineering) were retained to conduct a traffic management plan (TMP) for John Lewis Social Justice Academy at Oliver Wendell Holmes Middle School (John Lewis). The purpose of this TMP is to ensure safe vehicular and pedestrian circulation during peak morning drop-off and afternoon pick-up periods. Below is general information about John Lewis.

#### **School:**

- Location: 2001 E. Kiest Boulevard, Dallas, TX 75216
- School District: Dallas Independent School District
- School Times: 8:35 AM – 3:55 PM
- Principal: Ms. Sharron Evans Jackson

#### **Zoning:**

- Existing Zoning: Single Family, R-5(A)
- Proposed Zoning: SUP
- Project: Replacing existing school facility.

#### **Students:**

- Existing Student Enrollment: 588 students in 6<sup>th</sup>- 8<sup>th</sup> grades (at time of traffic observations)
- Planned Student Capacity: 833 students in 6<sup>th</sup>- 8<sup>th</sup> grades

#### **Staff:**

- Existing Staff: 49
- Planned Staff: 55

### **School Access:**

- Surrounding Roadways:
  - E. Kiest Boulevard: Principal Arterial M-6-D(A), Six-lane divided
  - E. Illinois Avenue: Principal Arterial M-6-D(A), Six-lane divided
  - Sunnyvale Street: Community Collector, Two-lane undivided S-4-D south of E. Kiest Blvd and Local Street north of E. Kiest Blvd
  - Kellogg Avenue: Local Street, Two-lane undivided
- Sidewalks are provided on both sides of E. Kiest Boulevard, adjacent to the school.

### **Parking Supply:**

- Surplus parking is provided for special events.

## **Traffic Management Plan**

### Existing and Projected Queue

Lambeth Engineering met with DISD staff, school principal and the architect during the process of developing the TMP. Traffic observations were conducted on the following dates and times:

- Wednesday, January 11, 2023 – PM Dismissal
- Friday, January 13, 2023 – PM Dismissal
- Tuesday, January 17, 2023 – AM Arrival
- Tuesday, January 17, 2023 – PM Dismissal
- Thursday, January 19, 2023 – PM Dismissal

The peak queue of parent vehicles picking up students was observed to be about 73 vehicles. Parents are currently parking on both sides of E. Kiest Boulevard, and on both sides of Kellogg Avenue. Parents will be able to pick up students on-site when the new school is constructed. A rate of one parent vehicle per 8.5 students is used for this TMP, as parents will be more managed with the new site.

As expected, the peak period of parent vehicles accumulating at the school occurred during the afternoon dismissal period. Most of the traffic clears the campus within 15-20 minutes once school is dismissed. The current traffic pattern is summarized in the **Appendix**.

The projected vehicular accumulations are summarized in **Table 1** below. As shown, the proposed site plan has adequate space to accommodate the parents on-site.

**Table 1. TMP Summary**

Student Capacity	School Times	Travel Modes	Projected Parent Vehicles	Provided Spaces for Parents	Surplus Availability for Parents
833 Students	Beginning: 8:35 AM	Parents 50%	98 Veh.	106 Veh.	8 Veh.
<b>Grades:</b> 6th - 8th	Dismissal: 3:55 PM	Walkers 15% Buses 35%	(2,303 Feet)	(2,500 Feet)	(197 Feet)

Double queue lanes accommodate 51 vehicles (1,212 LF). Parent parking on-site accommodates 55 vehicles (1,288 LF).

## Recommendations

The TMP recommendations are described below and shown in **Exhibit 1**.

### **Students**

- School is dismissed at 3:55 PM. As needed, school is dismissed in staggered dismissal periods beginning at 3:45 PM.
- Students who are picked up by parents are instructed to walk to their parents' vehicle waiting in the designated pick-up area.
- Students should walk along the sidewalks to enter their parent vehicles.
- Students should not walk to their parent if the parent is still in the "double queue" lane, waiting to reach the on-site parking area.
- Students waiting for parents to pick them up later than ordinary dismissal period should remain in the designated area and wait for their parents' arrival.
- Students walking home should be instructed to walk along sidewalks and cross at crosswalks. Students should not be permitted to cross at midblock.

### **Parents**

- Parents must wait inside their vehicle in the queue line(s) extending around the visitor parking lot to pick up their student in the designated pick-up area, as shown in the TMP exhibit.
- When parents arrive on-site, they should pull all the way forward to the end of the on-site parking area.
- Parents should not pick up their student in the double queue lines leading up to the visitor/admin parking lot. Parents should wait to pick up their student in the designated parent parking areas adjacent to the sidewalk in single parking line.
- After the student arrives to the parent vehicle, the parent may leave via the by-pass lane.
- Parents should continually pull forward to allow room for additional vehicles on-site.
- It is recommended that parents not arrive more than 15 minutes before school dismissal.
- Parents may not park in the events parking spaces since they will be blocked in by queuing vehicles. These spaces may be used outside peak arrival and dismissal periods.
- Parents may not park on-street, adjacent to the school, as shown in the TMP exhibit.

### ***Staff***

- During the first week of school, staff should monitor parents as they arrive to direct them to pull forward and not stop early.
- After the first week of school, staff should check parents 10 minutes before dismissal and ensure all parents are pulled forward and not blocking by-pass lanes.
- Staff should monitor students at each area where parents are picking up students until all students are dismissed.
- Staff should continue monitoring pedestrians as they leave the school and ensure they are crossing E. Kiest Boulevard at crosswalk, not mid-block, and cross in groups.
- Staff should not direct traffic on E. Kiest Boulevard if they are not a licensed peace officer.

### ***Buses***

- A total of 12 school buses, including special education buses, is planned to use the designated bus driveway on the east side of the campus.
- Based on site visit, 40% of buses turned right onto E. Kiest Boulevard, and 60% of buses turned left onto E. Kiest Boulevard. With the new site plan, buses will no longer be able to turn left onto E. Kiest Boulevard. Alternative routes are provided in the **Appendix**.

### ***Licensed Peace Officers***

A licensed peace officer is not assigned to John Lewis to assist with traffic, and one is not recommended.

### ***Crossing Guards***

There are currently no official crossing guards assigned to the surrounding intersections near John Lewis. City of Dallas does not typically provide crossing guards for middle schools. However, pedestrian safety should be monitored due to E. Kiest Boulevard being a six-lane, divided roadway, a crossing guard in front of the school or at the intersection of E. Kiest Boulevard/Kellogg Avenue may be beneficial.

### ***Parking Restrictions***

Currently, there is a small section of restricted parking in front of the school on the north side of E. Kiest Boulevard. Parking should be prohibited on both sides of E. Kiest Boulevard between Sunnyvale Street and Kellogg Avenue, especially around the driveway openings, as illustrated in the TMP exhibit.

### ***School Zones***

There is currently a school zone on E. Kiest Boulevard adjacent to the school. It is recommended this school zone remain.

### ***Off-Site Improvements***

- Update school-related signs to satisfy current TxMUTCD criteria. Detailed description will be provided with the engineering plan submittal.
- Install additional No Parking during school zone hours signs along both sides of E. Kiest Boulevard in front of the school between Kellogg Avenue and Sunnyvale Street, as shown on the TMP.

## Summary

The John Lewis Traffic Management Plan is designed to provide safe vehicular and pedestrian movement to and from school and can accommodate the projected vehicular queues on campus.

If traffic congestion or unsafe movements are noticed, the plan should be reviewed and updated promptly.

### REVIEW AND COMMITMENT

The John Lewis Social Justice Academy at Oliver Wendell Holmes Middle School traffic management plan (TMP) for was developed with the intent of optimizing safety and accommodating vehicular traffic queues generated during school peak hours. A concerted effort and full participation by the school administration are essential to maintain safe and efficient traffic operations.

By consent of this TMP submittal, the school administration agrees to the strategies presented herein for which the school is held responsible unless the City of Dallas deems further measures are appropriate.

The school is also committed to continually review and assess the effectiveness of this plan and if warranted, implement changes in the interest of increasing safety and minimizing impacts on the surrounding community.

Signature: [Handwritten Signature] Date: Jan. 26, 2023  
Name: SHARRON E. JACKSON Title: PRINCIPAL

END

# John Lewis Social Justice Academy at Oliver Wendell Holmes

2001 E. Kiest Boulevard, Dallas, Texas

Legend:

--- Parent Parking Lane	● Staff	— No Parking
→ Queue	■ Bus Loading	↔ Primary Entry and Exit Points
→ By-Pass Lane	→ Bus Traffic Flow	↔ Secondary Exit Points
● Traffic Cone	--- Pedestrian Pathway	

Student Capacity	School Times	Travel Modes	Projected Parent Vehicles	Provided Spaces for Parents	Surplus Availability for Parents
833 Students	Beginning: 8:35 AM	Parents 50%	98 Veh.	106 Veh.	8 Veh.
Grades: 6th - 8th	Dismissal: 3:55 PM	Walkers 15%	(2,303 Feet)	(2,500 Feet)	(197 Feet)
		Buses 35%			

Double queue lanes accommodate 51 vehicles (1,212 LF). Parent parking on-site accommodates 55 vehicles (1,288 LF).

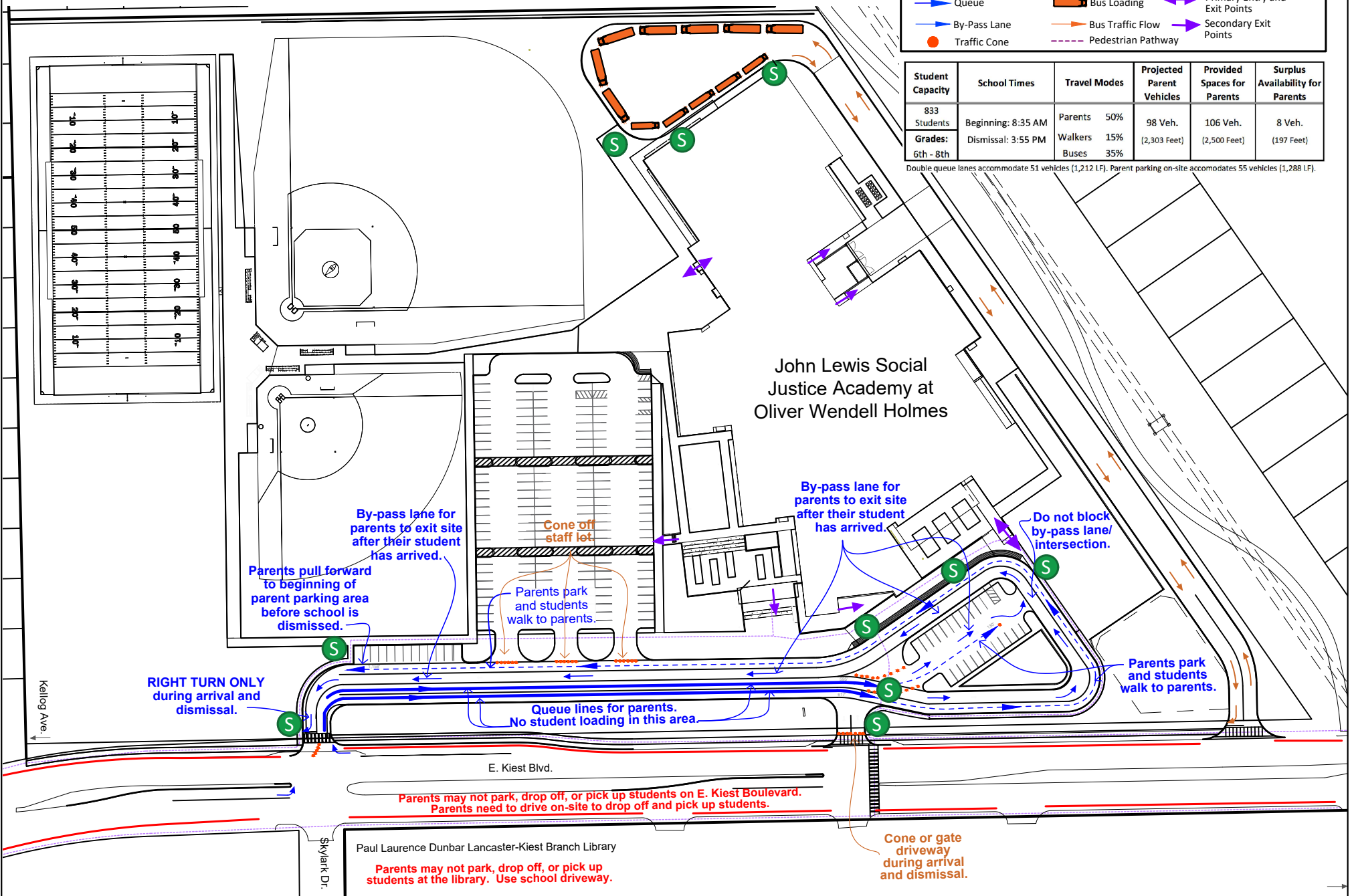

1

## Traffic Management Plan

Not to Scale



# Appendix



# John Lewis Social Justice Academy at Oliver Wendell Holmes

2001 E. Kiest Boulevard, Dallas, Texas

## Legend:

--- Parent Parking Lane	Staff	— No Parking
→ Queue	Bus Loading	↔ Primary Entry and Exit Points
→ By-Pass Lane	→ Bus Traffic Flow	↔ Secondary Exit Points
● Traffic Cone	--- Pedestrian Pathway	

Student Capacity	School Times	Travel Modes	Projected Parent Vehicles	Provided Spaces for Parents	Surplus Availability for Parents
833 Students	Beginning: 8:35 AM	Parents 50%	98 Veh.	106 Veh.	8 Veh.
Grades: 6th - 8th	Dismissal: 3:55 PM	Walkers 15%	(2,303 Feet)	(2,500 Feet)	(197 Feet)
		Buses 35%			

Double queue lanes accommodate 51 vehicles (1,212 LF). Parent parking on-site accommodates 55 vehicles (1,288 LF).

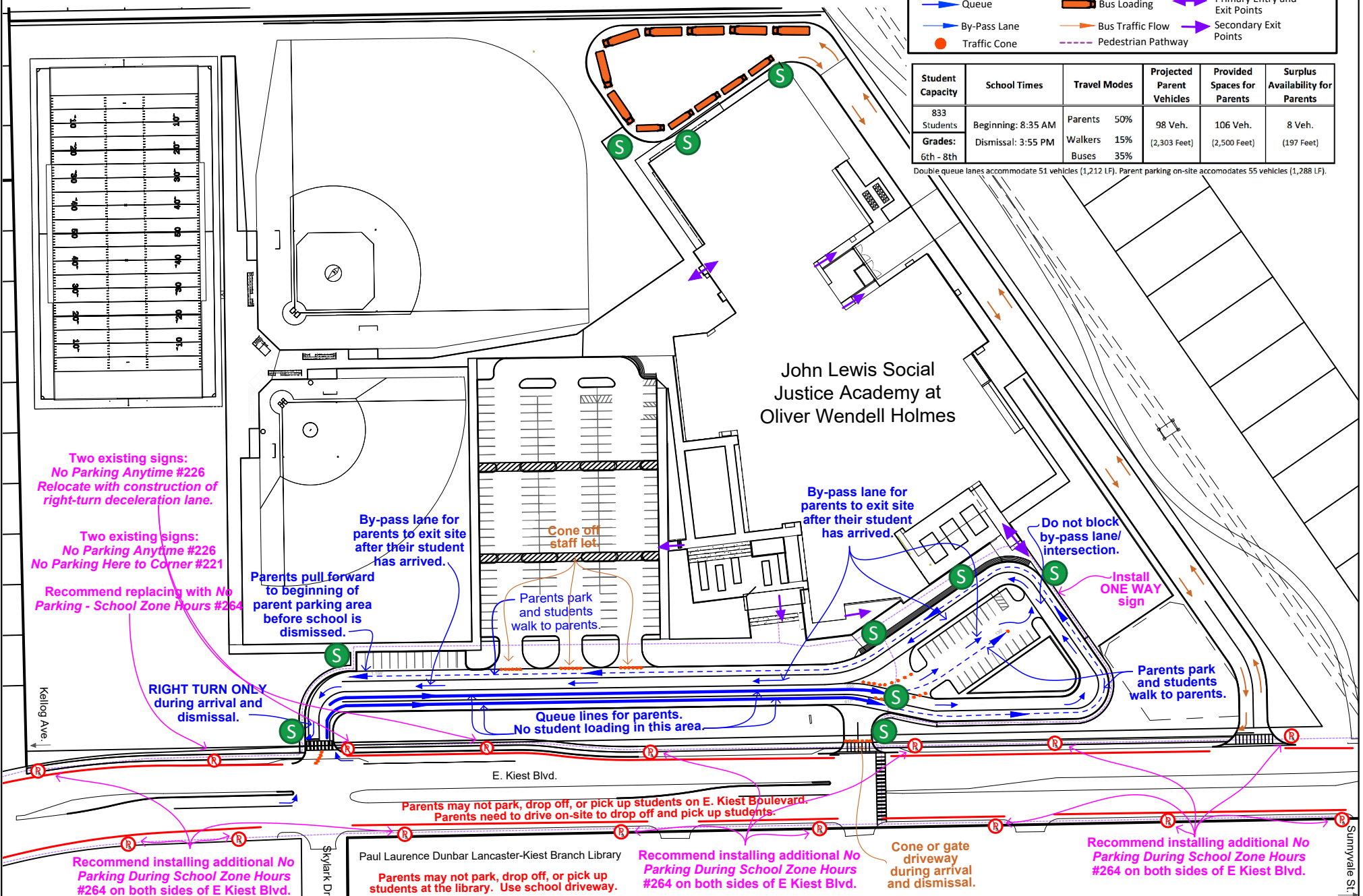

A

## Traffic Management Plan - With Recommended Signs

Not to Scale





# John Lewis Social Justice Academy

2001 E. Kiest Blvd., Dallas, TX 75216

Tuesday, January 17, 2023  
CHL, BB, AN

Existing Vehicles Parked  
On-Street to Pick up  
Students

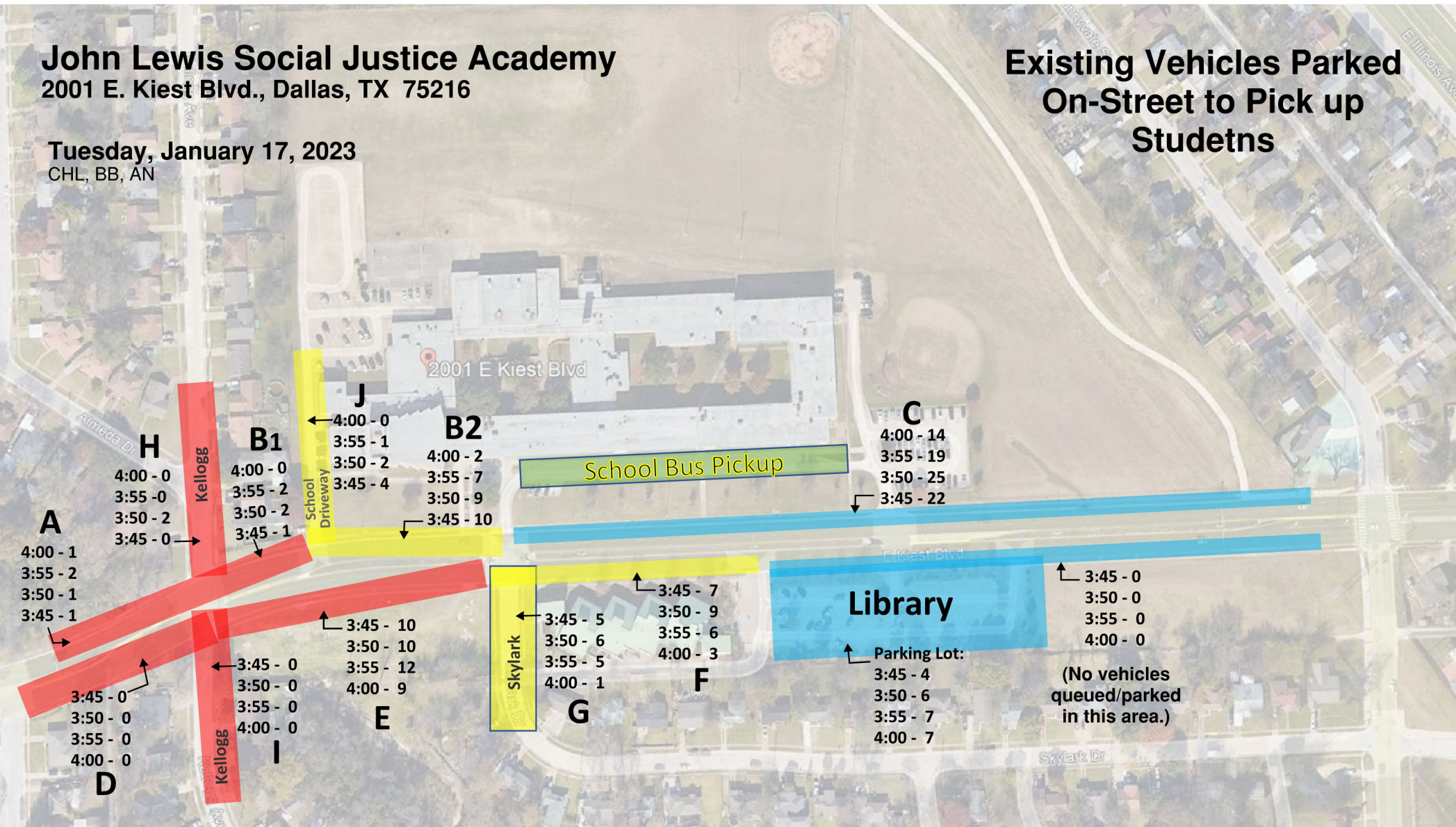

## Current Bus Routes

### Alternative Routes with No Left-Turn onto E. Kiest Boulevard from School

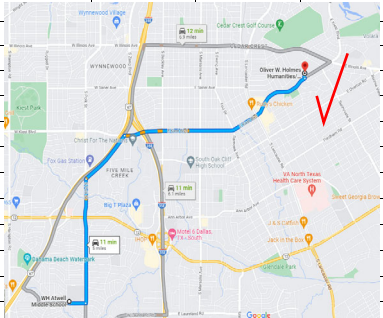
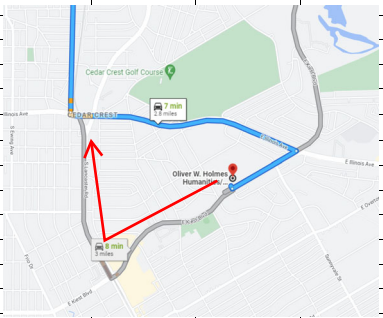
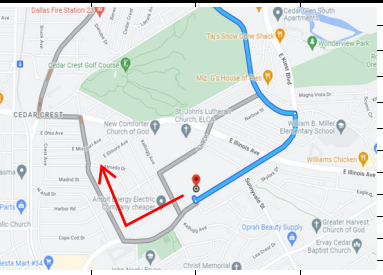
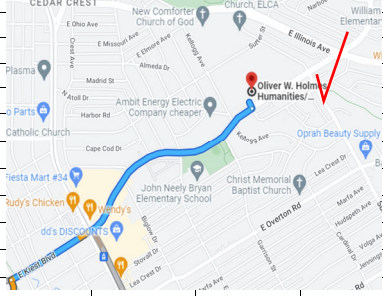
2022-2023					Early Release December 16 - December 21				
John Lewis Social Justice Academy @ Oliver Wendell									
ROUTE	AM PICK-UP TIME	STOP(S) PICK-UP & DROP-OFF LOCATION	PM DROP-OFF						
1232	6:55 AM	RICE ES	5:25 PM	3:05 PM					
	7:15 AM	RUNYON	5:04 PM	2:44 PM					
	7:26 AM	CUELLAR	4:58 PM	2:38 PM					
	7:46 AM	W. HUTCHINS ES	4:36 PM	2:16 PM					
	8:05 AM	ARRIVE @ ATWELL (INTERSESSION)	4:19 PM	1:59 PM					
	8:20 AM	ARRIVE @ OW HOLMES	4:05 PM	1:45 PM					
Notes:	No change needed								
4019	7:51 AM	STELLA AVE 75216 & S DENLEY DR 75216	4:11 PM	1:55 PM					
	7:52 AM	LYNN HAVEN AVE 75216 & S DENLEY DR 75216	4:13 PM	1:54 PM					
	7:54 AM	STRICKLAND ST 75216 & S DENLEY DR 75216	4:15 PM	1:52 PM					
	7:55 AM	HENDRICKS AVE 75216 & S DENLEY DR 75216	4:16 PM	1:51 PM					
	8:05 AM	ARRIVE @ OW HOLMES	4:05 PM	1:35/1:45 PM					
Notes:	May require alternate route as shown in grey on map								
4025	7:51 AM	S EWING AVE 75216 & WINTERS ST 75216 (17)	4:13 PM	1:52 PM					
	7:52 AM	HARLANDALE AVE 75216 & MORRELL AVE 75203	4:15 PM	1:54 PM					
	7:58 AM	HUTCHINS RD & HULSE BLVD (20)	4:20 PM	1:59 PM					
	8:05 AM	ARRIVE @ OW HOLMES	4:05 PM	1:35/1:45 PM					
Notes:	May require alternate route as shown below								
4026	7:42 AM	MICHIGAN AVE 75216 & GEORGIA AVE 75216	4:25 PM	2:04 PM					
	7:46 AM	W. LOUISIANA AVE & ARGENTA DR (18)	4:21 PM	2:00 PM					
	7:52 AM	2400 MICHIGAN AVE 75216	4:17 PM	1:56 PM					
	7:58 AM	E OVERTON RD & S EWING AVE 75216	4:10 PM	1:50 PM					
	8:05 AM	ARRIVE @ OW HOLMES	4:05 PM	1:35/1:45 PM					
Notes:	No change needed								

Bus Routes from DISD Transportation Website 01.25.23

[https://docs.google.com/spreadsheets/d/1cdjd-i1Y-QhIBGFU1iB4TneV8\\_08FV7F3jth339wC2k/edit#gid=1200635438](https://docs.google.com/spreadsheets/d/1cdjd-i1Y-QhIBGFU1iB4TneV8_08FV7F3jth339wC2k/edit#gid=1200635438)

Maps from Google Maps 01.25.23



### Alternative Routes with No Left-Turn onto E. Kiest Boulevard from School

Maps from Google Maps 01.25.23