

CONSULTANTS

PROJECT TITLE

DEEP ELLUM
TOWER

ISSUE #	DATE	DESCRIPTION
1	00/00/2022	CONCEPT DESIGN

CERTIFICATION

DRAWN BY	Author
CHECKED BY	Checker
COMMISSION NUMBER	2412-01

SHEET TITLE

LANDSCAPE
PLANS

SHEET NUMBER

L100

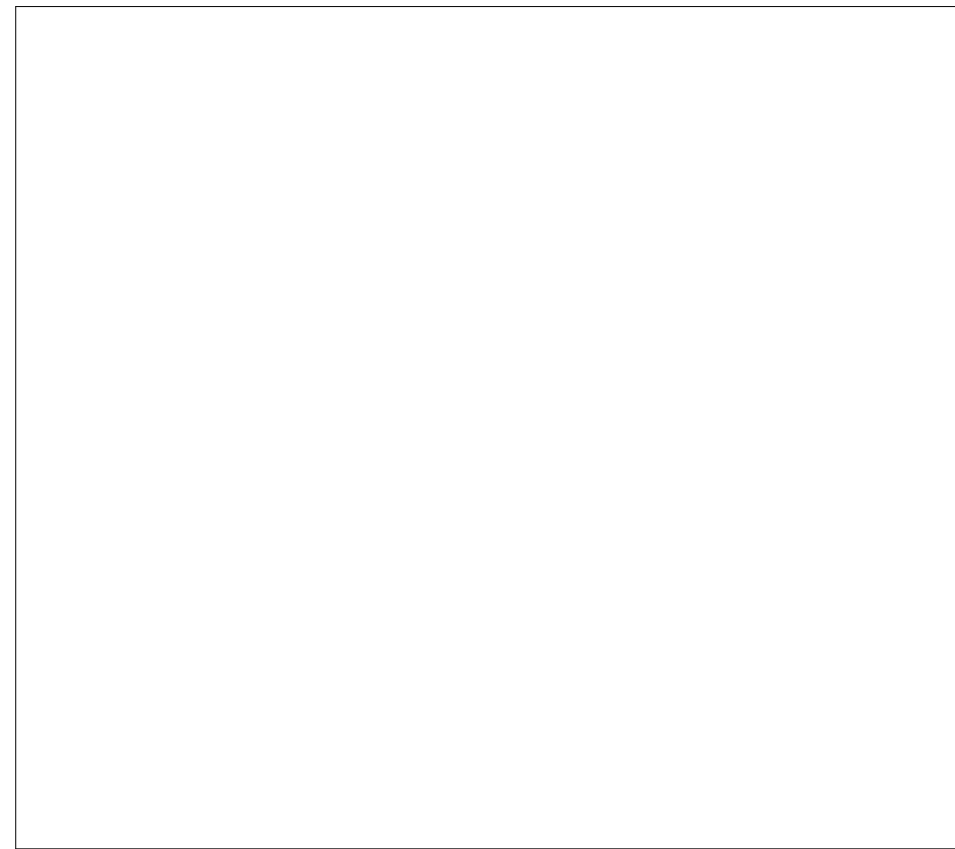

2 LOCATION MAP
L100 / Not To Scale

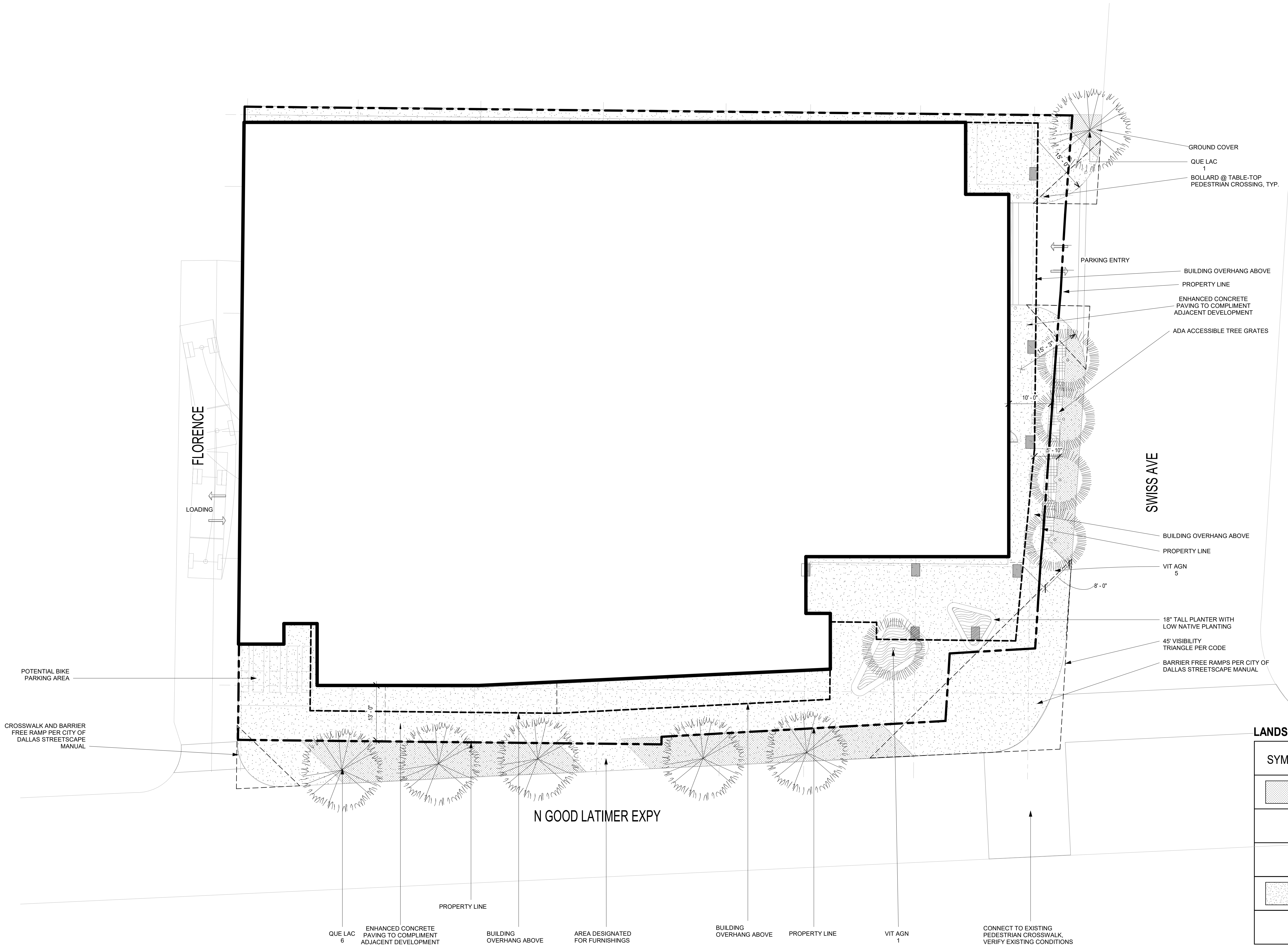

LANDSCAPE LEGEND:

SYMBOL	DESCRIPTION	NOTES
	GROUND COVER	NATIVE GRASSES OR GROUND COVER PLANTING FROM ARBORIST APPROVED LIST DEPENDENT ON AVAILABILITY AT TIME OF INSTALLATION (NO ANNUAL PLANTING)
	LACEY OAK OR SIMILAR SHADE TREE FROM ARBORIST APPROVED LIST DEPENDENT ON AVAILABILITY AT TIME OF INSTALLATION	QUERCUS LACEY, 2" CAL. MIN. 20' from other large/medium tree, (Medium)
	VITEX OR SIMILAR ORNAMENTAL TREE FROM ARBORIST APPROVED LIST DEPENDENT ON AVAILABILITY AT TIME OF INSTALLATION	VITEX AGNUS-CASTUS, 2" CAL. MIN. MIN 6' HEIGHT (Small)
	ENHANCED PAVING	ENHANCED CONCRETE PAVING TO COMPLIMENT ADJACENT DEVELOPMENT

NOTE:
- ALL PLANTING TO BE NATIVE OR ADAPTED SPECIES. ANNUALS OR SEASONAL COLOR WILL NOT BE USED.
QUALITY OF PLANTS IN SPECIAL PLANTING AREA TO BE DETERMINED (T.B.D.)
ALL PLANTING AREAS AND TREES TO HAVE DRIP-IRRIGATION SYSTEM

- IF A STREET TREE INTERFERES WITH UTILITIES OR DRIVEWAYS IN THE TREE PLANTING ZONE, THE BUILDING OFFICIAL
MAY APPROVE ALTERNATE LANDSCAPE MATERIALS IN THE TREE PLANTING ZONE. IF ALTERNATE LANDSCAPE MATERIALS
CANNOT BE APPROVED IN THE TREE PLANTING ZONE DUE TO UTILITY CONFLICTS, THE BUILDING OFFICIAL MAY ALLOW STREET
TREES TO BE PLANTED BETWEEN THE RIGHT-OF-WAY AND A BUILDING FACADE

