

**CITY PLAN COMMISSION****THURSDAY, MAY 2, 2024****FILE NUMBER:** S234-080**SENIOR PLANNER:** Sharmila Shrestha**LOCATION:** Executive Drive at Northwest Highway/ State Highway Spur No. 244, northeast corner**DATE FILED:** April 3, 2024**ZONING:** CS**CITY COUNCIL DISTRICT:** 9**SIZE OF REQUEST:** 3.417-acres**APPLICANT/OWNER:** City of Dallas**REQUEST:** An application to create one 3.417-acre lot from a tract of land in City Block D/8043 on property located on Executive Drive at Northwest Highway/ State Highway Spur No. 244, northeast corner.**SUBDIVISION HISTORY:**

1. S201-646 was a request south of the present request to create a 1.5251-acre lot from a tract of land in City Block 8043 on property located on Northwest Highway (State Highway Spur No. 244), east of Executive Drive. The request was approved on May 20, 2021, and was recorded on January 12, 2024.
2. S189-208 was a request east of the present request to create one 3.219-acre lot from a tract of land in City Block 8043 on property located on McCree Road, north of Northwest Highway/State Highway Spur No. 244. The request was approved on June 6, 2019, but has not been recorded.

**STAFF RECOMMENDATION:** The request complies with the requirements of the CS Commercial Service District; therefore, staff recommends approval of the request subject to compliance with the following conditions:**General Conditions:**

1. The final plat must conform to all requirements of the Dallas Development Code, Texas Local Government Code, Texas Land Surveying Practices Act and the General Rules and Regulations of the Texas Board of Land Surveying.
2. Department of Development Services, Engineering Division must verify that the plat conforms with the water, wastewater, and easement requirements under the provisions of Chapter 49 of the Dallas City Code.
3. Compliance with all plans, contracts, ordinances, and requirements of the City of Dallas. *Section 51A-8.102(a), (b), (c), and (d)*
4. The number and location of fire hydrants must comply with the Dallas Fire Code.
5. Any new or existing structure may not extend across new property lines. *Section 51A-8.503(e)*

6. On the final plat, all easement abandonments, and ROW abandonments must be by separate instrument with the recording information shown on the face of the plat. A release from the Real Estate Division is required prior to the plat being submitted to the Chairman for signature.
7. On the final plat, include two boundary corners tagged with these coordinates: "Texas State Plane Coordinate System, North Central Zone, North American Datum of 1983 on Grid Coordinate values, No Scale and no Projection."
8. On the final plat, monument all set corners per the Monumentation Ordinance. Prior to submittal of the final plat for the Chairman's signature. The monuments must be verified by the Chief City Surveyors Office in the Public Works Department. *Section 51A-8.617*
9. Provide ALL supporting documentation (i.e. deeds, plats, ordinances, easements...etc) with a completed Final Plat Checklist to the Survey Plat Review Group (**SPRG**) with the Final Plat Submittal **after** City Plan Commission Approval.
10. Prior to the final plat, submit a tree survey to the Arborist. A release from the arborist is required prior to an early release request or the recordation of the plat, whichever occurs first.
11. The number of lots permitted by this plat is one.

#### **Paving & Drainage Conditions:**

12. Submit a full set of Civil Engineering Plans (drainage, paving, street signage/markings/lighting) prepared per City Standards by a licensed (TX) Professional Engineer to Engineering Division in Room 200, Oak Cliff Municipal Center (i.e. 311T/DP). Additions and alterations to the public infrastructure require approval and may require private development contracts with bonds. 51A-8.102 (c); 8.601(b)(4),(5),(6),(7),(8),(9)
13. Detention may be required if the capacity of available outfall is not adequate to carry the developed runoff. Section 51A-8.611(c).
14. Place a note on the final plat stating "Lot-to-Lot drainage will not be allowed without proper City of Dallas Engineering Division approval" 51A 8.611(e)

#### **Right of Way Requirements:**

15. Existing drainage conveyance within the property is required to be sized in compliance with Section 51A-8.611(a)(1) of the City of Dallas Code.

#### **Survey (SPRG) Conditions:**

16. Prior to final plat, submit a completed final plat checklist and all supporting documents.
17. On the final plat, show how all adjoining right-of-way was created. Section 51A-8.403(a)(1)(A)(xxii).
18. On the final plat, show distances/width across all adjoining right-of-way.

19. On the final plat, show all additions or tracts of land within 150 feet of the property with recording information.

**Dallas Water Utilities Conditions:**

20. Additional design information is required for assessment. Site plan must be submitted showing proposed development, building finished floor elevation, development, existing mains – including downstream manhole, and proposed water and wastewater service locations. Submit water/wastewater engineering plans to 320 E. Jefferson Blvd., Room 200, Attention: Water and Wastewater Engineering.
21. Water and wastewater main improvements may be required by Private Development Contract. Submit water/wastewater Engineering Plans to 320 E. Jefferson Blvd., Room 200, Attention: Water and Wastewater Engineering.

**Street Name / GIS, Lot & Block Conditions:**

22. On the final plat, change “Northwest Highway” to “Northwest Highway/ State Highway Spur No. 244”.
23. On the final plat, identify the property as Lot 8 in City Block D/8043.

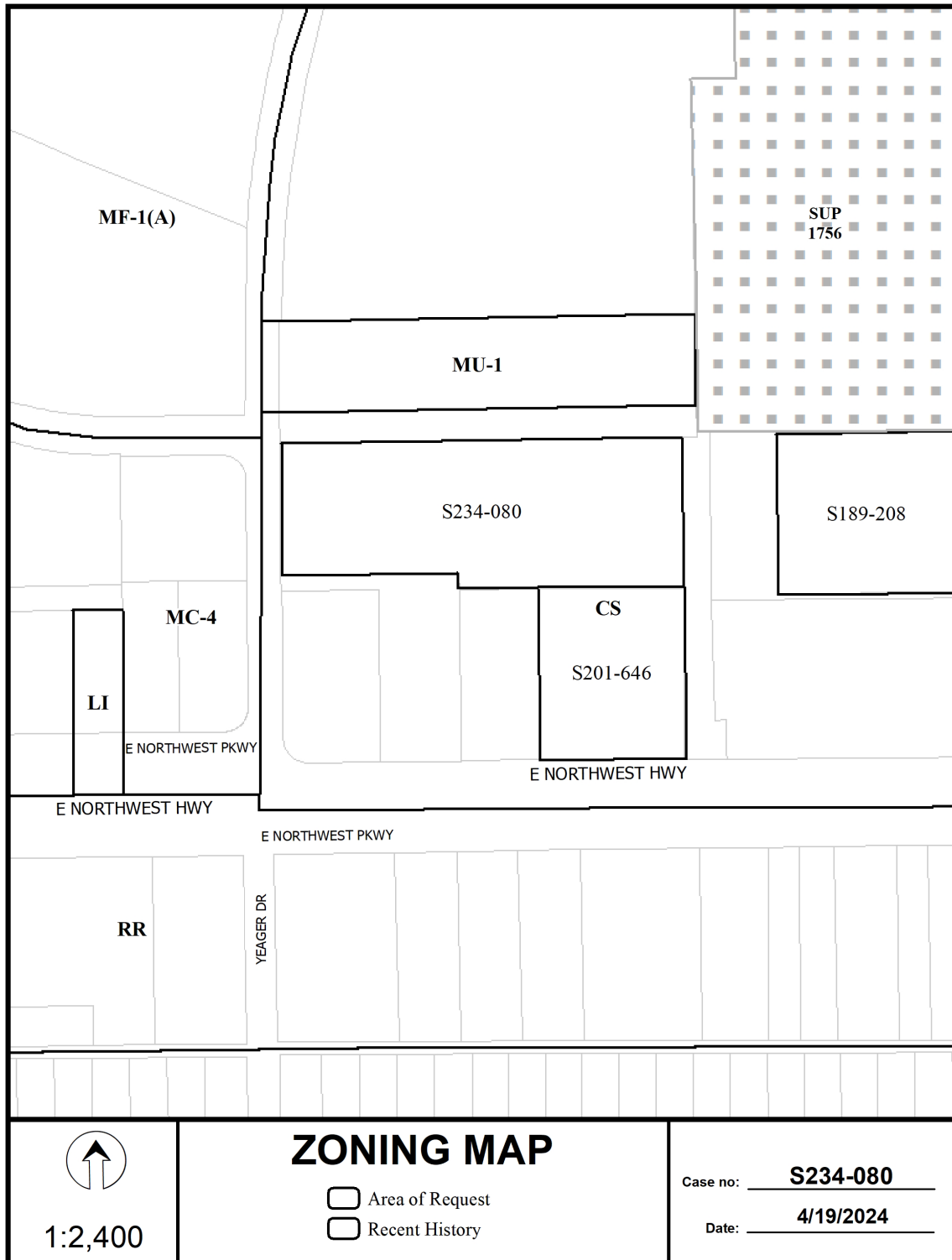





1

Camino Reyes  
Int. #201900195860

E=292/588.44

**Lot 28**  
**BLOCK**  
**A/8043**

9<sup>th</sup> IR found  
CONTROLLING  
MONUMENT  
N. 7700207 SE

238

DEDI

The small shell utilizes all of the recent for the

Water  
main

By: \_\_\_\_\_

---

[illegible]

OWNER'S CERTIFICATE:

COUNTY OF DALLAS

**BEGINNING** at ¼-inch from rod (N=7002740) tract of land conveyed to Same East, Inc. by Texas, at the intersection with the South line Page 3967 of the Deed Records of Dallas Co

THENCE South 69°14'25" West, departing the PASS AT 236.67 feet, an aluminum disc found Block D/0043 of the Golden Chlo on Northwest of the Official Public Records of Dallas County, (N=7002499.97, E=2527301.00) (Contour

THENCE South 89°14'25" West, continuing a described tract of land a distance of 264.21 ft to the Northwest corner of the Northwest 1/4 of Section 36, Township 36N, Range 10E, containing a distance of 0.56 foot; (N=7002821.24, E=

**BASIS OF BEARINGS:** Bearings are based a Datum of 1863, Realization of 2011.

\$18.95

is either found or placed in compliance with 3.617 (a) (b) (c) (d) & (e) :  
it is a precise representation of this

Statute  
no. 4202,

[illegible]